

ST. ROCH

Drainage Upgrades and Green
Infrastructure

Hazard Mitigation Grant Program

Post 30% Project Update

June 2, 2016



St. Roch Project Background & Current Status

- Project Background
 - Allocation of \$7,500,000 in FEMA Hazard Mitigation Grant Program (HMGP) funding to address chronic flooding and drainage issues in the St. Roch neighborhood.
 - Project area is 26 city blocks bounded by N. Robertson St., St. Claude Ave., Elysian Fields Ave. and Franklin Ave.
- Project Status
 - 10% Concept Design and Probable Cost Estimate Approved
 - 30% Project Scope Report supporting a Benefit-Cost Ratio (BCR) >1.0 Approved by DPW & FEMA
 - Awaiting notice to proceed (NTP) for 60% Design Phase
 - Awaiting finalization of contract amendments for Surveying, Geotechnical Investigation, and Environmental Site Assessment Services

St. Roch Project Scope

- \$5,737,000 Anticipated FEMA Construction Budget
 - Install / Upgrade Drainage to 10-YR, 24-HR Design Event
 - Incorporate Green Infrastructure (GI) into Drainage Design
 - Rebuild Roadway Infrastructure to promote GI integration
- Coordination for Services Not Funded By FEMA Grant
 - Rehabilitation / replacement of Water and Sanitary Sewer Infrastructure through S&WB
 - Utility Relocation / Abandonment through Utility Owners
 - Street Trees & Non-GI Plantings through Planning and / or Parks & Parkways
 - Avoidance of duplicative street and sidewalk repair work through Recovery Roads Program

St. Roch Project Schedule

- Phase III Deliverables – March 1st, 2017
 - 60% Plans
 - Preliminary Design Report
 - Updated Quantities & Cost Estimate
- Phase IV Deliverables – June 8th, 2017
 - 90% Plans
 - Final Design Report
 - Final Specs ,Comps, Quantities & Costs
 - Bid Proposal Package
 - Drainage Model Updates
- Advertise for Bid – September 22nd, 2017
- Phase V Deliverables – TBD
 - Construction Administration
 - Resident Inspection Services

St. Roch Project Goals

- Increased Public Safety
- Improved Resident Quality of Life
- Enhanced Community & Neighborhood Morale
- Reduced Resident Financial Burden
- Restored & Enhanced Multi-Modal Transportation Function
- Reduced Flooding & Increased Water Quality
- Minimized DPW & S&WB Maintenance Burden
- Avenues for Public Education & Community Outreach
- Provide a benchmark for all projects aimed at increasing the disaster (and day to day) resiliency of New Orleans

St. Roch Proposed Limits of Work

ST. ROCH

SCHEMATIC CONCEPT PLAN



— 8' WIDE GREEN CORRIDOR
BIORETENTION/ PERMEABLE PARKING

- - - PROPOSED DRAINAGE PIPE

- - - PROJECT AREA

DOWNSTREAM HYDRAULIC
DESIGN ALTERNATIVES

SCALE 1" = 300'

St. Roch Existing Conditions

ST. ROCH

TYPICAL EXISTING EAST-WEST STREET SECTION

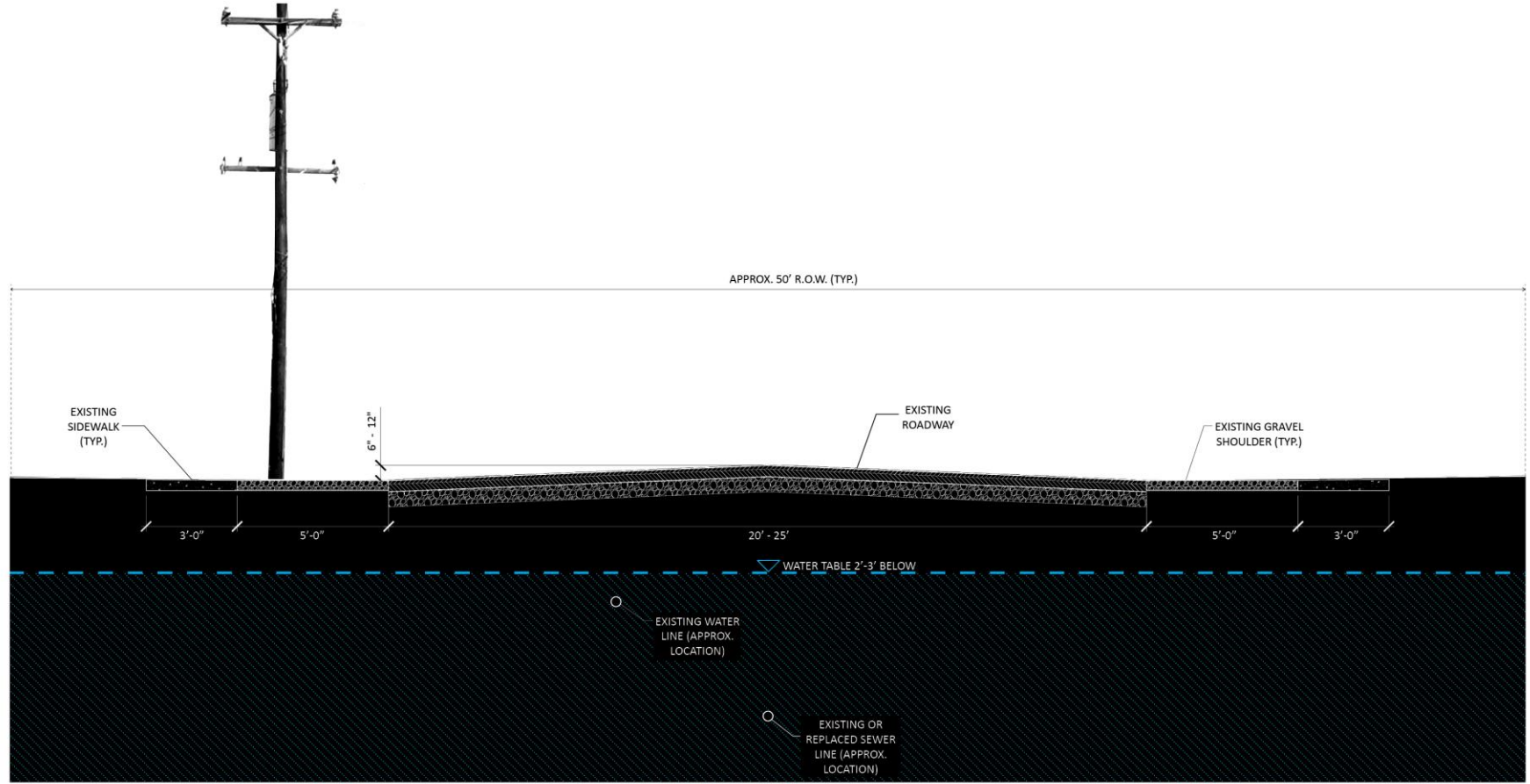

Mandeville St. and N. Villere St.



Music St. and N. Villere St.



N. Villere St. between St. Roch Ave. and Music St.



Marais St. between Spain St. and Mandeville St.



Marais St. between Spain St. and Mandeville St.

St. Roch Existing Conditions

ST. ROCH

TYPICAL EXISTING NORTH-SOUTH STREET SECTION

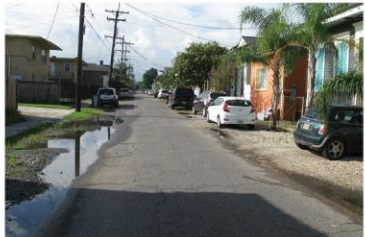
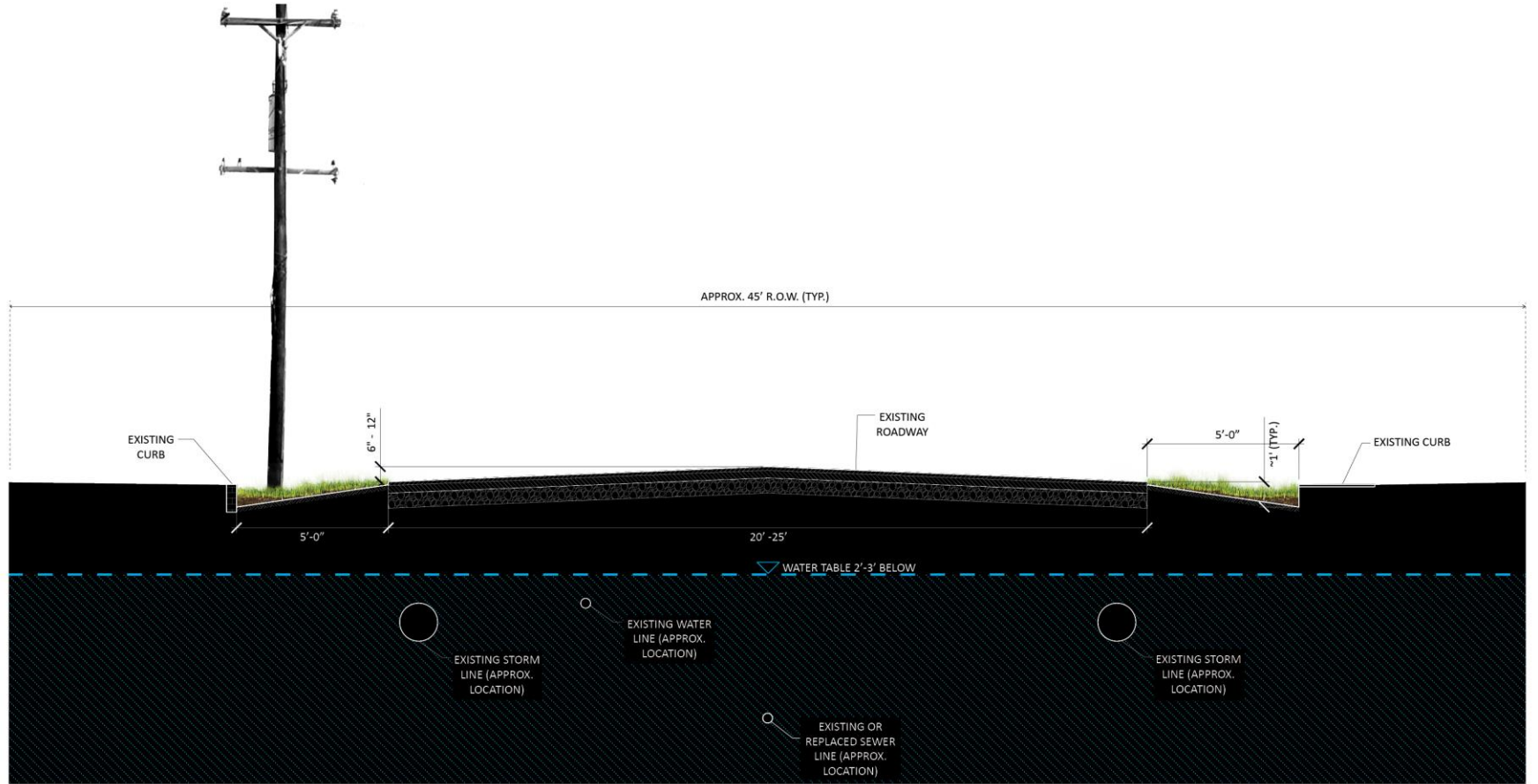

Marigny St. between N. Villere St. and Urquhart St.



Marigny St. between Urquhart St. and Marais St.



Arts St. between N. Villere St. and Urquhart St.



Spain St. between Urquhart St. and Marais St.



Music St. between Urquhart St. and Marais St.

St. Roch Proposed Design Elements

ST. ROCH

PROPOSED STREET SECTION
FOR 45' - 50' R.O.W.

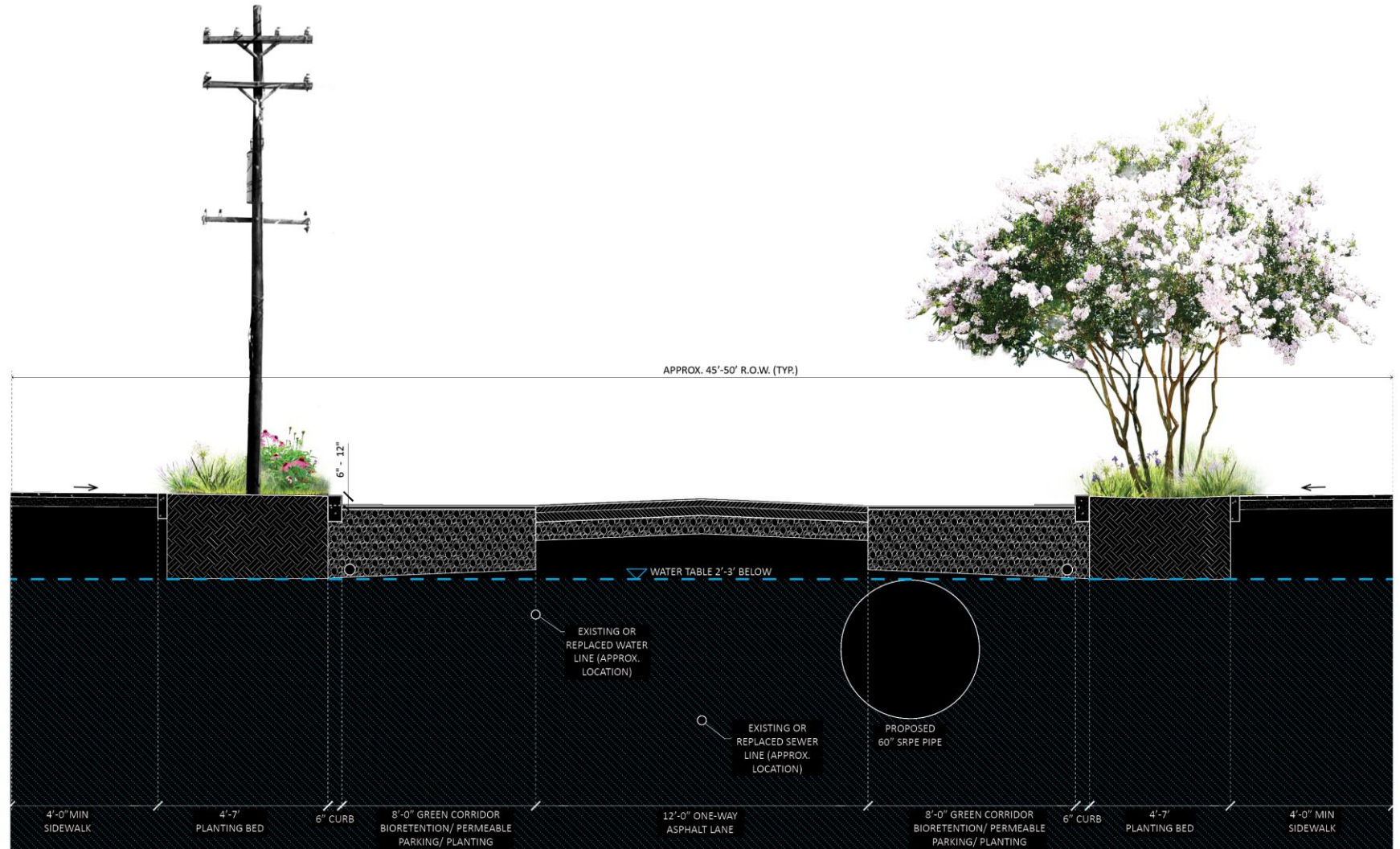

St. Roch Proposed Design Elements

ST. ROCH

PROPOSED STREET PLAN
FOR 45' - 50' R.O.W.

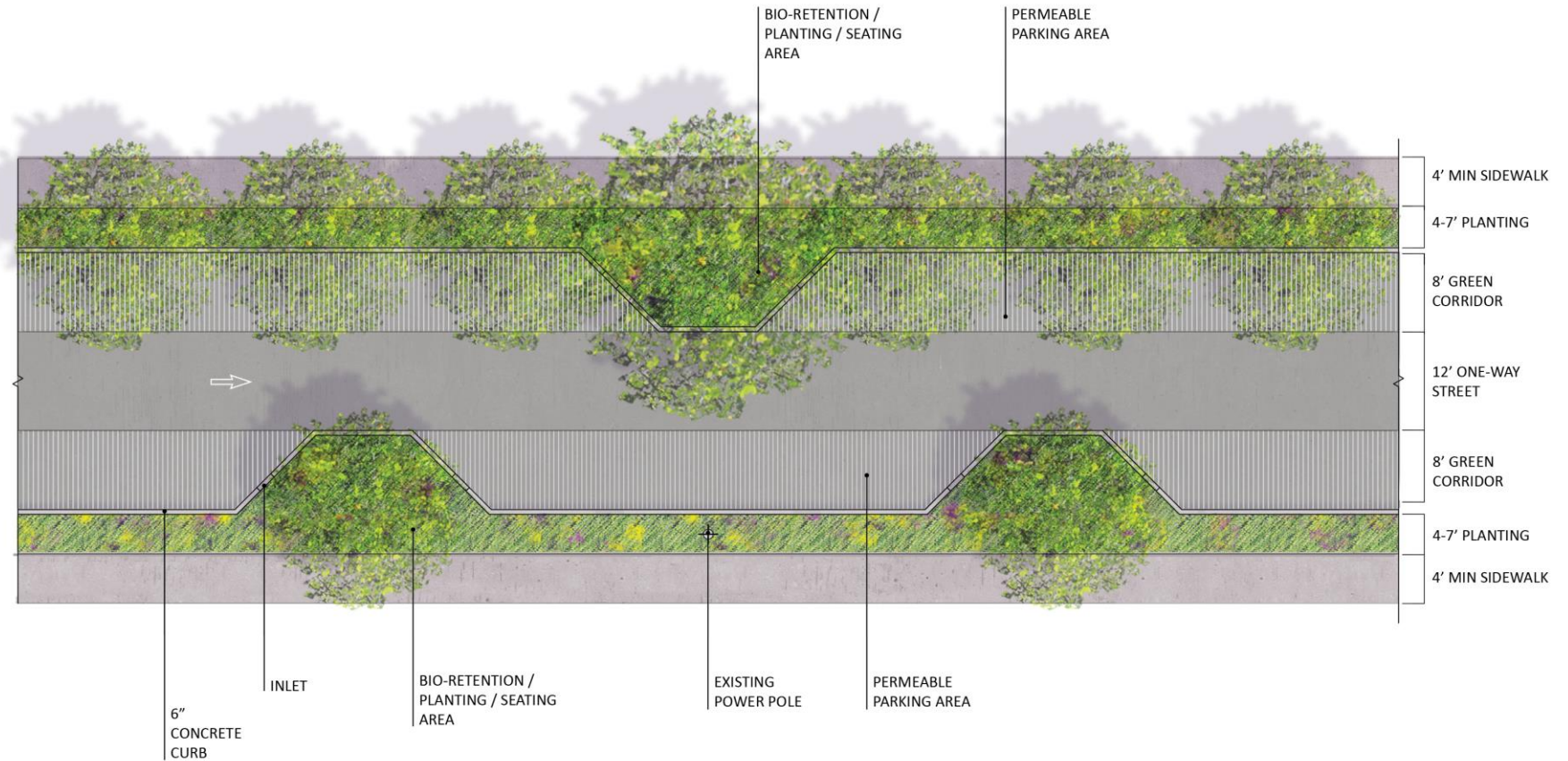

*** Street Section will adapt to existing conditions such as fire hydrants, driveways, stoops, and other existing conditions. Above represents idealized cross section.

St. Roch Anticipated Project Challenges

- Narrow Public Rights-of-Way (ROW)
 - Houses / Structures on ROW lines
 - Limited Areas for Green Infrastructure Sites
 - High On Street Parking Demands
- Less Than Optimal Site Conditions
 - Restrictive Soil Layers
 - Shallow Water Table
- Green Infrastructure Integration
 - Need for Broad Multi-Agency acceptance
 - Need for Community Acceptance
 - Need for Experienced Contractors
- Maintaining FEMA Dictated Deadlines
 - Uncontrolled delays
 - Scope Revisions



St. Roch Anticipated Project Challenges (cont'd)

- Coordination Between Multiple Agencies / Owners
 - DPW (Maintenance, Traffic, Engineering, Construction, Stormwater, Green Infrastructure)
 - S&WB (Water, Sanitary Sewer, Stormwater Utilities)
 - LA DOTD Orleans District
 - Entergy (Electric, Gas)
 - AT&T (Telecommunications)
 - Cox Cable (Telecommunications)
 - Planning Department
 - Department of Parks and Parkways
 - FEMA
 - Recovery Roads (N-Y Associates)

Conclusion

- Questions, Comments or Concerns?
- Project Manager:
 - Jason Doll, CPSWQ
Senior Scientist/Project Manager
 - Email: jdoll@moffattnichol.com
- Lead Project Engineer:
 - Greg Brickham, PE
Water Resources Engineer
 - Email: gbrickham@moffattnichol.com

