

THE NATIONAL WORLD WAR II MUSEUM

945 MAGAZINE STREET
NEW ORLEANS, LA 70130

Voorsanger Mathes, L.L.C.

201 Saint Charles Avenue, Suite 4100
New Orleans, Louisiana 70170
Tel. 504-586-9303
Fax 504-582-1305

246 West 38th Street
New York, New York 10018
Tel. 212-302-6464
Fax 212-840-0063

ANDREW HIGGINS PLAZA

BID DOCUMENTS

JUNE 16, 2015



OWNER:
THE NATIONAL WORLD WAR II MUSEUM FOUNDATION, INC.
945 Magazine Street
New Orleans, LA 70130
Tel: 504-527-6012
Fax: 504-527-6088

CIVIL/STRUCTURAL ENGINEER:
Morphy Makofsky, Inc.
336 N. Jeff Davis Parkway Suite 200
New Orleans, LA 70119
Tel: 504-488-1317
Fax: 504-488-0924

ELECTRICAL ENGINEER:
Henry Martin Consultant, LLC
2313 N. Hullen Street Ste B
Metairie, LA 70001
Tel: 504-833-6189
Fax: 504-831-6801

MECHANICAL/PLUMBING ENGINEER:
Crumb Engineering, LLC
4609 Fairfield Street
Metairie, LA 70006
Tel: 504-455-4450
Fax: 504-455-4451

LANDSCAPE DESIGN:
Cashio Cochran
New Orleans, LA
Tel: 985-502-7962

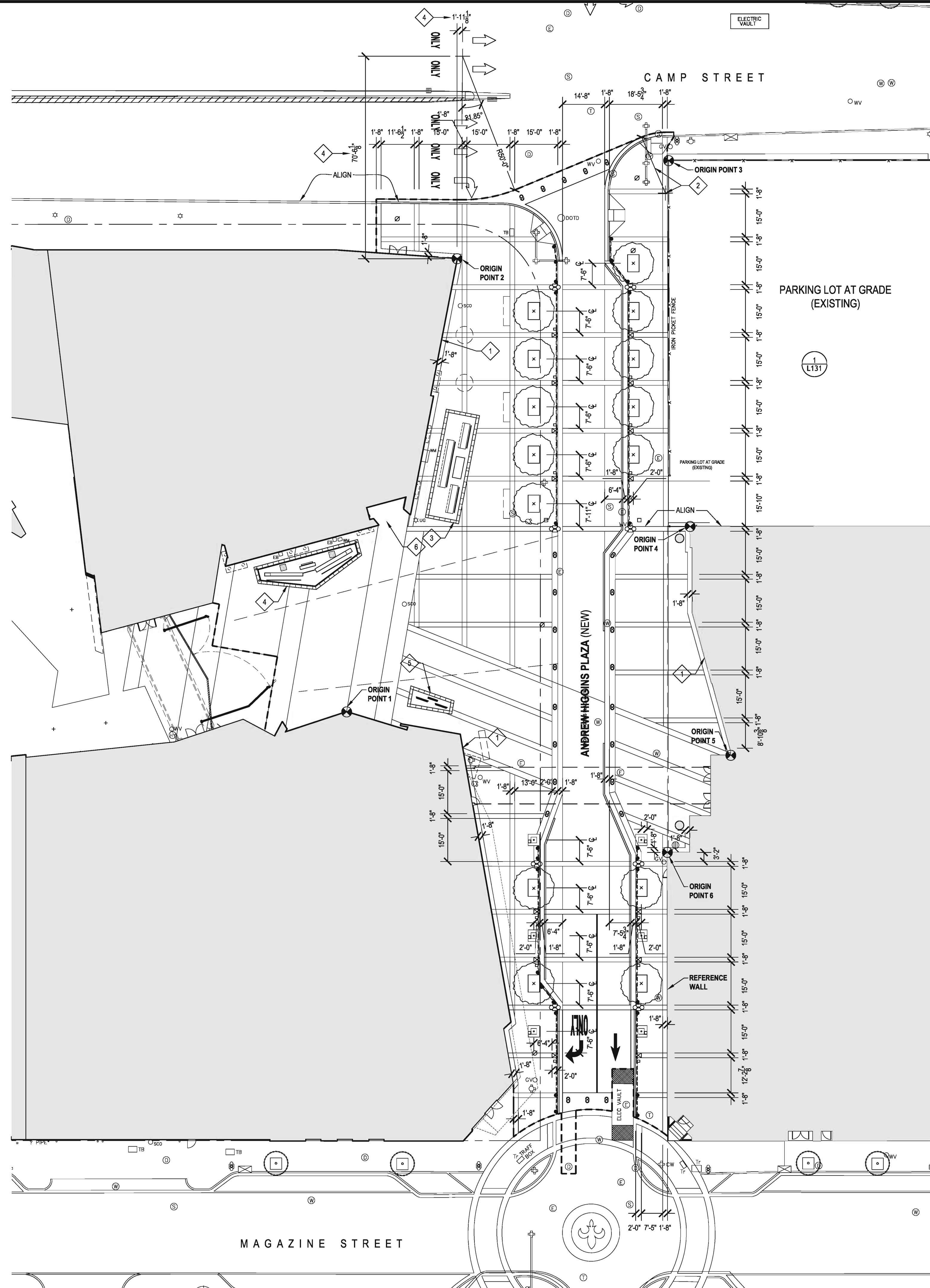

GENERAL NOTES

- ALL PAVEMENT GRID LINES SHOWN AS VERTICAL SHALL BE PARALLEL IN BEARING TO THE EXTERIOR WALL OF THE LOUISIANA PAVILION INDICATED ON THIS SHEET AS REFERENCE WALL. ALL GRID LINES SHOWN AS HORIZONTAL SHALL BE PERPENDICULAR TO THE VERTICAL LINES.

KEYNOTES

- 1 EXTERIOR WALL OF EXISTING BUILDING
- 2 SEE SHEET L132 FOR RADII AND RELATED DIMENSIONS IN THIS AREA
- 3 NEW IMPROVEMENTS AT ATLANTIC WALL
- 4 NEW MAJOR DONORS' WALL POOL
- 5 NEW FOUNDERS' WALL
- 6 NEW PUMP VAULT FOR POOLS

OWNER:
 THE NATIONAL WORLD WAR II MUSEUM FOUNDATION, INC.
 945 Magazine Street
 New Orleans, LA 70130
 Tel: 504-527-6012
 Fax: 504-527-6088

LANDSCAPE DESIGN:
 CASHIO COCHRAN
 New Orleans, LA
 Tel: 985-502-7982

CIVIL/STRUCTURAL ENGINEER:
 Morphy Makofsky, Inc.
 336 N. Jeff Davis Parkway, Suite 200
 New Orleans, LA 70119
 Tel: 504-488-1317
 Fax: 504-488-0924

ELECTRICAL ENGINEER:
 Henry Marin Consultant, LLC
 2313 N. Hullen Street, Suite B
 Metairie, LA 70001
 Tel: 504-833-6189
 Fax: 504-831-6801

MECHANICAL/PLUMBING:
 Crumb Engineering, LLC
 4609 Fairfield Street
 Metairie, LA 70006
 Tel: 504-455-4450
 Fax: 504-455-4451

NO.	DESCRIPTION

NO.	DESCRIPTION

VOORSANGER MATHES, L.L.C.
 201 St. Charles Avenue
 New Orleans, LA 70170-4100
 Telephone: (504) 586-9303
 Telefax: (504) 582-1305
 e-mail: architecture@mathesnieme.com

246 West 38th Street
 New York, NY 10018
 Telephone: (212) 302-6464
 Telefax: (212) 840-0063
 www.voorsanger.com

* VOORSANGER MATHES, L.L.C. All rights reserved.

THE NATIONAL WORLD WAR II MUSEUM

945 MAGAZINE STREET
 NEW ORLEANS, LA 70130

PROJECT TITLE

ANDREW HIGGINS PLAZA

BID DOCUMENTS

DESIGNED BY	CHECKED BY
---	---
DRAWN BY	DATE
---	6/16/2015
PROJECT NO.	9390.000AC
SHEET TITLE	DIMENSION PLAN - PAVING
SHEET NO.	L112

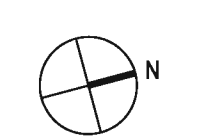

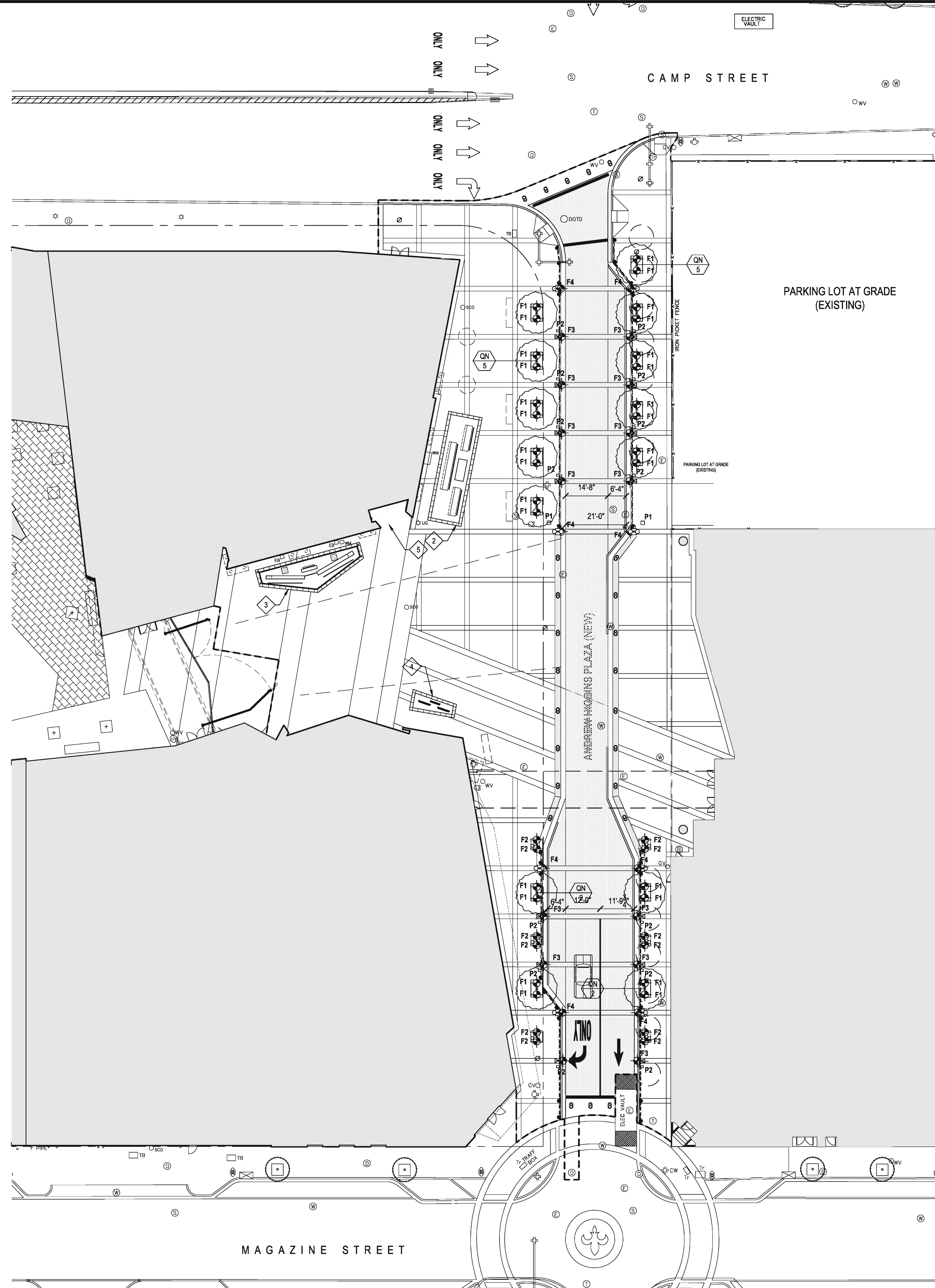

GENERAL NOTES

- THIS SHEET

KEYNOTES

- 1 EXTERIOR WALL OF EXISTING BUILDING
- 2 NEW IMPROVEMENTS AT ATLANTIC WALL; SEE ELECTRICAL FOR LIGHTING
- 3 NEW MAJOR DONORS' WALL POOL; SEE ELECTRICAL FOR LIGHTING
- 4 NEW FOUNDERS' WALL; SEE ELECTRICAL FOR LIGHTING
- 5 NEW SUMP VAULT FOR POOLS

LEGEND

- F1 LANDSCAPE UPLIGHT
- F2 FLAGPOLE UPLIGHT
- F3 LIGHT EMBEDDED IN BOLLARD
- F4 HISTORIC NEW ORLEANS STREETLIGHT
- P1 ELECTRICAL PULL BOX #1 (SEE ELECTRICAL)
- P2 ELECTRICAL PULL BOX #2 (SEE ELECTRICAL)
- ⊙ EXISTING MANHOLE - ELECTRIC
- EXISTING UNDERGROUND ENTERGY LINE

NOTE: INSTALL ONE (1) EXTERIOR DUPLEX OUTLET ADJACENT TO EACH PAIR OF F1 AND F2 FIXTURES.

PLANT LIST

SYM.	QTY.	BOTANICAL NAME	COMMON NAME	SPECIFICATIONS	SPACE
TREES, SHRUBS, & GROUNDCOVERS					
QN	14	<i>Quercus nuttallii</i>	Nuttall Oak	-	AS SHOWN

OWNER:
 THE NATIONAL WORLD WAR II MUSEUM FOUNDATION, INC.
 945 Magazine Street
 New Orleans, LA 70130
 Tel: 504-527-6012
 Fax: 504-527-6088

LANDSCAPE DESIGN:
 CASHIO COCHRAN
 New Orleans, LA
 Tel: 985-502-7982

CIVIL/STRUCTURAL ENGINEER:
 Morphy Makofsky, Inc.
 336 N. Jeff Davis Parkway, Suite 200
 New Orleans, LA 70119
 Tel: 504-488-1317
 Fax: 504-488-0924

ELECTRICAL ENGINEER:
 Henry Marin Consultant, LLC
 2313 N. Hullen Street, Suite B
 Metairie, LA 70001
 Tel: 504-833-6189
 Fax: 504-831-6801

MECHANICAL/PLUMBING:
 Crumb Engineering, LLC
 4609 Fairfield Street
 Metairie, LA 70006
 Tel: 504-455-4450
 Fax: 504-455-4451

NO.	DESCRIPTION
DATE	

VOORSANGER MATHES, L.L.C.

201 St. Charles Avenue
 New Orleans, LA 70170-4100
 Telephone: (504) 586-9303
 Telefax: (504) 582-1305
 e-mail: architecture@mathesnieme.com

246 West 38th Street
 New York, NY 10018
 Telephone: (212) 302-6464
 Telefax: (212) 840-0063
 www.voorsanger.com

* VOORSANGER MATHES, L.L.C. All rights reserved.

THE NATIONAL WORLD WAR II MUSEUM

945 MAGAZINE STREET
 NEW ORLEANS, LA 70130

PROJECT TITLE

ANDREW HIGGINS PLAZA

BID DOCUMENTS

DESIGNED BY	CHECKED BY
DRAWN BY	DATE
PROJECT NO.	9390.000AC
SHEET TITLE	LIGHTING & PLANTING PLAN
SHEET NO.	

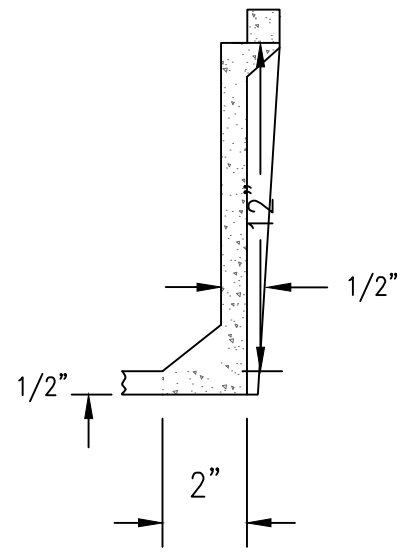
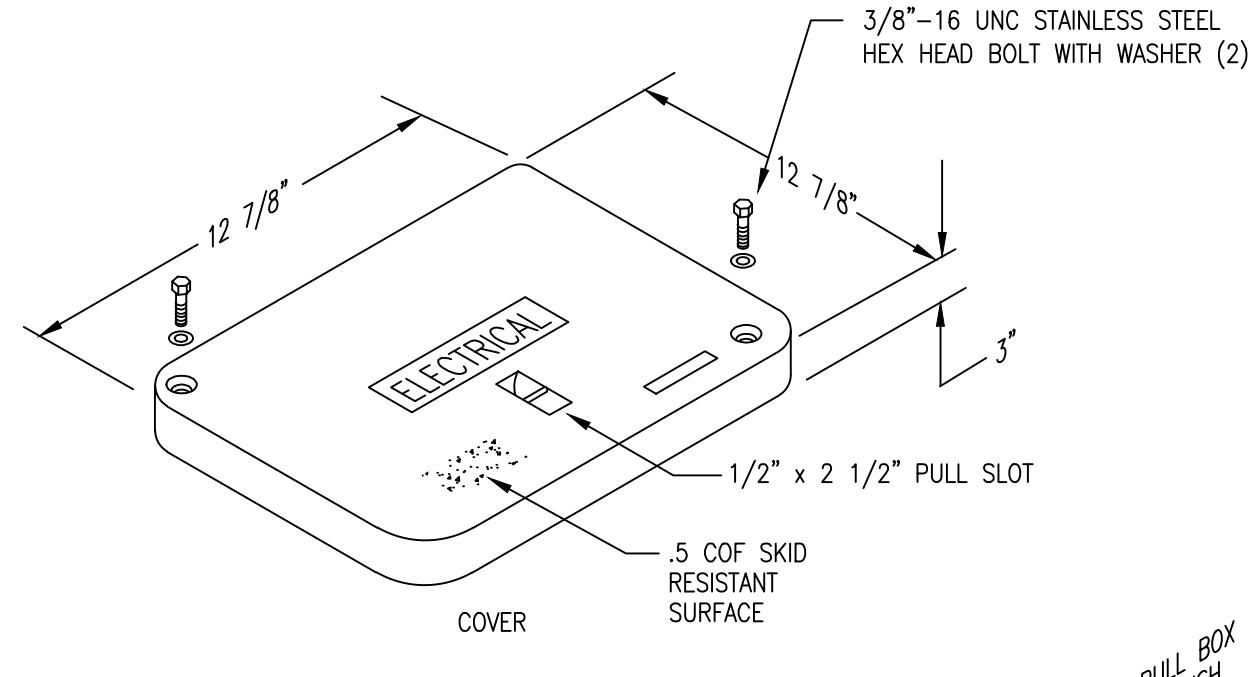
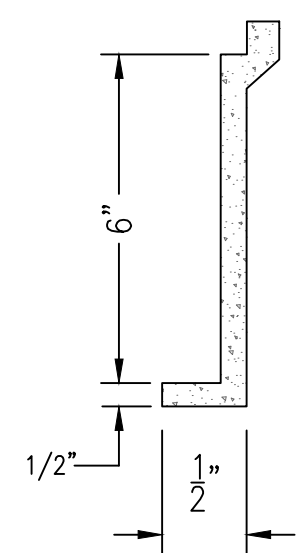
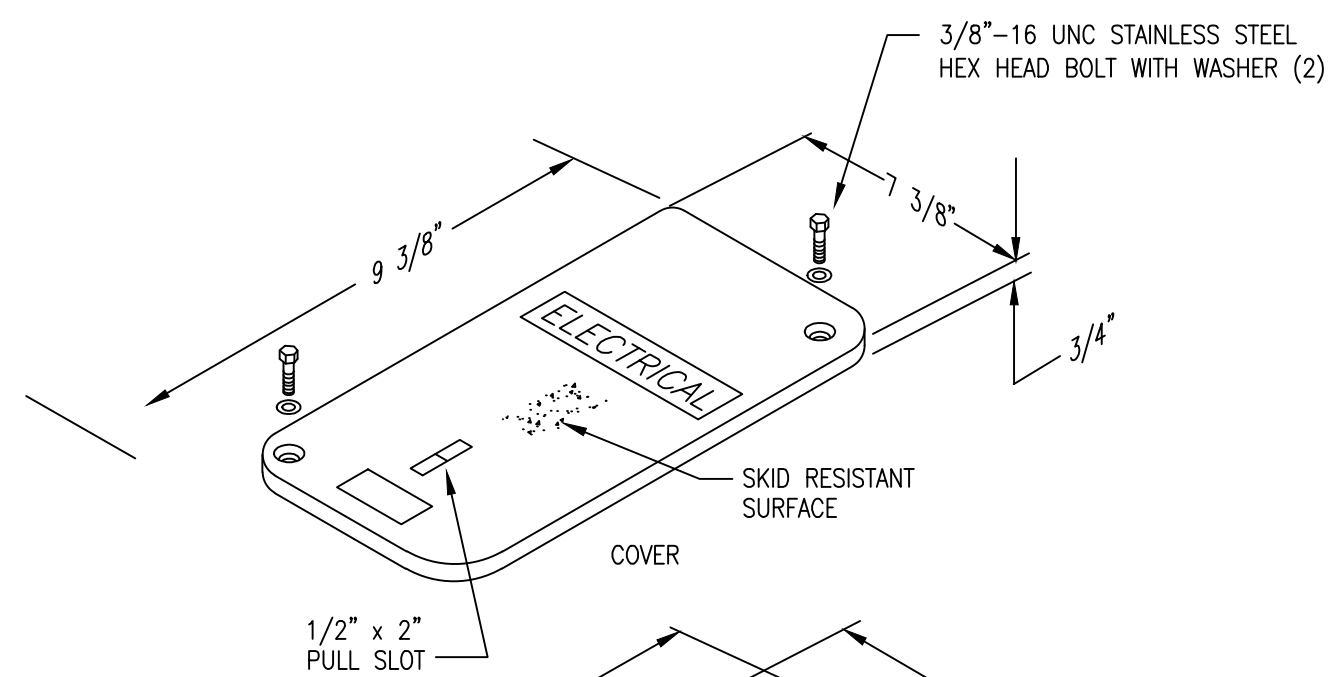

COVERS (BLANK UNLESS LOGO IS SPECIFIED)

DESCRIPTION	PART No.	WEIGHT #	DESIGNATION LOAD #	ANSI TIER	LOGO
W/2 BOLTS	PC0608CA00	4 (1.8 kg)	8,000/12,000	8	ELECTRICAL

BOXES (STACKABLE WITH SELF-ALIGNING, REPLACEABLE EZ-NUT)

DESCRIPTION	PART No.	WEIGHT #	DIMENSION A	DESIGN/TEST LOAD #	ANSI TIER
SOLID BOTTOM W/GASKET	PC0608DG06	14.5 (6.6kg)	7 1/4" (184mm)	15,000/22,500	15

COVERS (BLANK UNLESS LOGO IS SPECIFIED)

DESCRIPTION	PART No.	WEIGHT #	DESIGNATION LOAD #	ANSI TIER	LOGO
W/2 BOLTS	PC1212CA00	12 (5.4kg)	8,000/12,000	8	ELECTRICAL

BOXES (STACKABLE WITH SELF-ALIGNING, REPLACEABLE EZ-NUT)

DESCRIPTION	PART No.	WEIGHT #	DIMENSION A	DESIGN/TEST LOAD #	ANSI TIER
SOLID BOTTOM W/GASKET	PC1212DG12	37 (107kg)	13 1/4" (337mm)	15,000/22,500	15

1 QUAZITE ELECTRICAL PULL BOX #2 DETAIL
E-3 N.T.S.

2 QUAZITE ELECTRICAL PULL BOX #1 DETAIL
E-3 N.T.S.

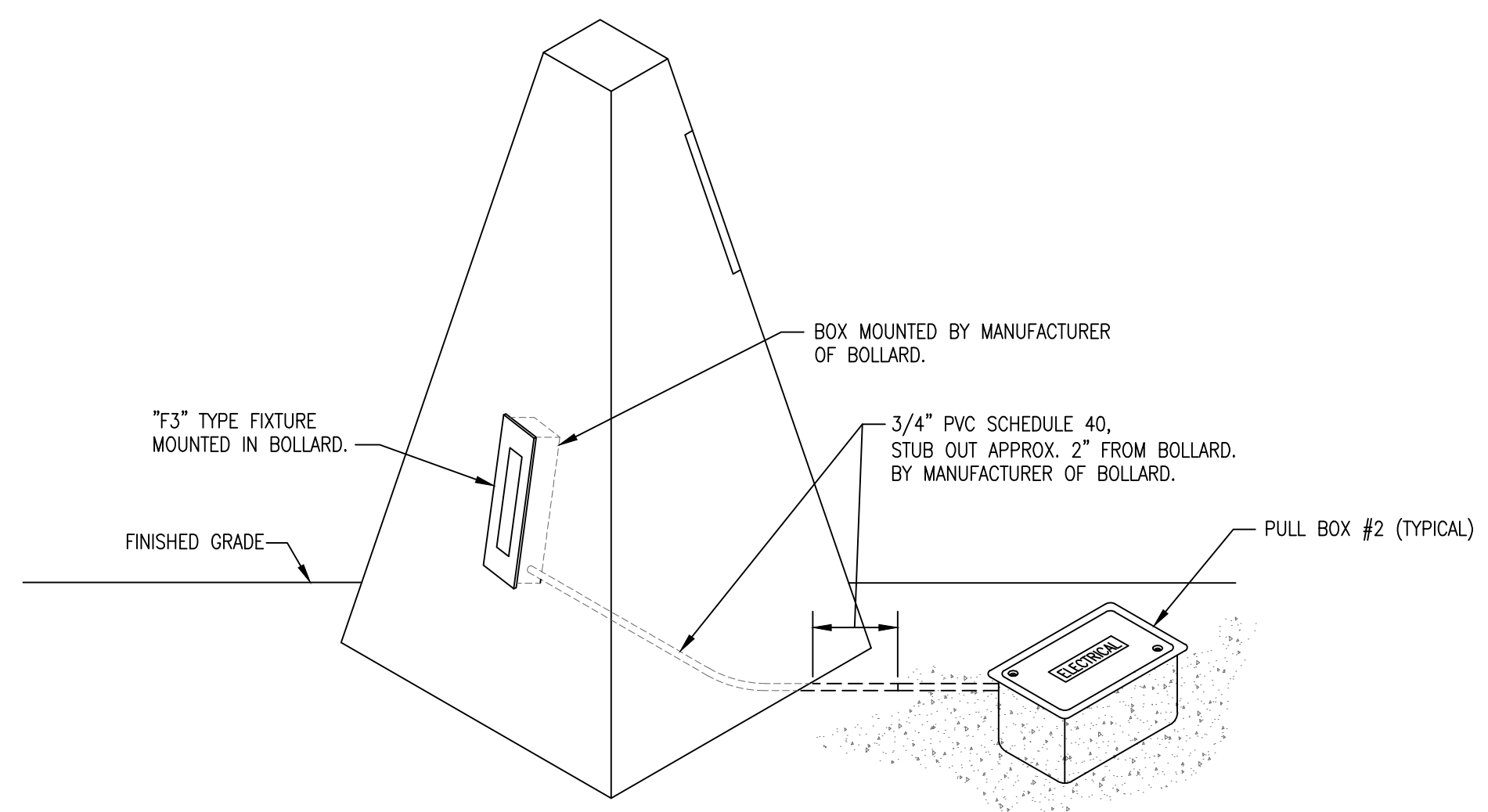

3 LIGHT FIXTURE "F3" MOUNTED IN BOLLARD DETAIL
E-3 N.T.S.

- NOTES:**
- GIVE ROUGH-IN BOX TO MANUFACTURER OF BOLLARD FOR MOUNTING.
 - CONFIRM EXACT LOCATION OF BOX WITH ARCHITECT.

OWNER:
THE NATIONAL WORLD WAR II MUSEUM FOUNDATION, INC.
945 Magazine Street
New Orleans, LA 70130
Tel: 504-527-6012
Fax: 504-527-6088

LANDSCAPE DESIGN:
CASHIO COCHRAN
New Orleans, LA
Tel: 985-502-7982

CIVIL/STRUCTURAL ENGINEER:
Morphy Makofsky, Inc.
336 N. Jeff Davis Parkway, Suite 200
New Orleans, LA 70119
Tel: 504-488-1317
Fax: 504-488-0924

ELECTRICAL ENGINEER:
Henry Martin Consultant, LLC
2313 N. Hullen Street, Suite B
Metairie, LA 70001
Tel: 504-833-6189
Fax: 504-831-6801

MECHANICAL/PLUMBING:
Crumb Engineering, LLC
4609 Fairfield Street
Metairie, LA 70006
T: 504-455-4450
F: 504-455-4451

NO.	DESCRIPTION
DATE	

VOORSANGER MATHES, L.L.C.
201 St. Charles Avenue
New Orleans, LA 70170-4100
Telephone: (504) 586-9303
Telefax: (504) 582-1305
e-mail: architecture@mathesbrienne.com

246 West 38th Street
New York, NY 10018
Telephone: (212) 302-6464
Telefax: (212) 840-0063
www.voorsanger.com

• VOORSANGER MATHES, L.L.C. All rights reserved.

THE NATIONAL WORLD WAR II MUSEUM
945 MAGAZINE STREET
NEW ORLEANS, LA 70130

PROJECT TITLE
ANDREW HIGGINS PLAZA
BID DOCUMENTS

DESIGNED BY JHM	CHECKED BY JHM
DRAWN BY DBP	DATE 6/16/2015
PROJECT NO. 9390.000AC	
SHEET TITLE ELECTRICAL DETAILS	
SHEET NO. E - 3	

Camp St.

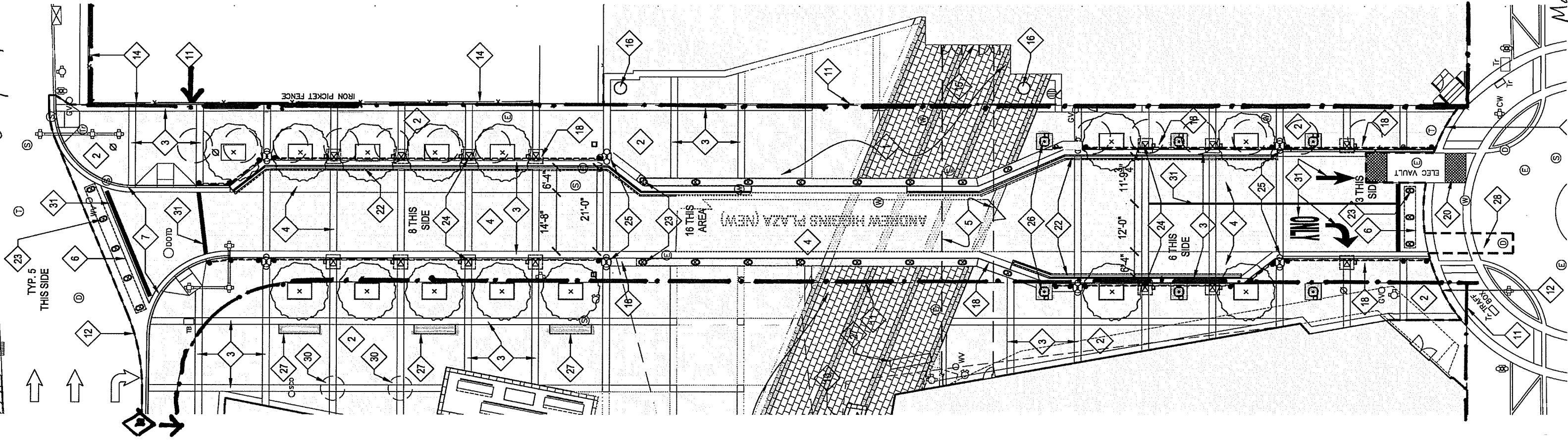

Magazine St.

KEYNOTES

- 1 NEW PARADE GROUND PAVING AREA: SEE SHEET L131 FOR MATERIALS, DIMENSIONS AND SETTING METHOD
- 2 NEW BRICK PAVERS, 4" X 8"
- 3 NEW GRANITE BANDING
- 4 NEW HANOVER COMMERCIAL ASPHALT BLOCK PAVER
- 5 FUTURE BRIDGE ABOVE
- 6 NEW CONCRETE APRON
- 7 NEW CONCRETE CURB
- 8 NEW IMPROVEMENTS AT ATLANTIC WALL
- 9 NEW MAJOR DONORS' WALL POOL
- 10 NEW FOUNDERS' WALL
- 11 PROPERTY LINE
- 12 LIMIT OF NEW WORK
- 13 EXISTING MUSEUM GATE
- 14 EXISTING METAL PICKET FENCE TO REMAIN; CONTRACTOR RESPONSIBLE FOR ANY REPAIRS DUE TO DEMOLITION OR CONSTRUCTION
- 15 ENTRY TO LOUISIANA PAVILION
- 16 EXISTING COLUMN
- 17 EXISTING TREE TO REMAIN
- 18 NEW DETECTABLE WARNING PAVERS, 4" X 8"
- 19 NEW SUMP VAULT FOR POOLS
- 20 EXISTING ELECTRICAL VAULT TO REMAIN UNDISTURBED
- 21 EXISTING BRIDGE ABOVE
- 22 NEW TRENCH DRAIN
- 23 NEW MANUAL ASSISTED LIFT BOLLARD
- 24 NEW STATIONARY CONCRETE BOLLARD
- 25 NEW HISTORIC NEW ORLEANS STREETLIGHT; TYPICAL FOR EIGHT (8)
- 26 NEW FLAGPOLE; TYPICAL FOR SIX (6)
- 27 FUTURE BENCH, OWNER FURNISHED/CONTRACTOR INSTALLED; SEE STRUCTURAL 13/S201 FOR FOUNDATION SCOPE OF WORK
- 28 RESTORE PAVEMENT IN THIS AREA TO ORIGINAL CONDITION
- 29 EXISTING PILE CAPS
- 30 RELOCATED CONCRETE BOMB SHELTER ARTIFACT
- 31 WHITE ASPHALT PAVER STRIPPING

LEGEND: NEW WORK

- ☒ NEW STATIONARY CONCRETE BOLLARD WITH INTEGRAL LIGHTING (TOTAL: 14)
- NEW RETRACTABLE BOLLARD (TOTAL: 24)
- ⊗ NEW HISTORIC CITY OF NEW ORLEANS LIGHT STANDARD (TOTAL: 8)
- ⊗ NEW PLANTER WELL WITH TREE, METAL ROOT GRILLE, UPLIGHTING, AND POWER (TOTAL: 14)
- ⊗ NEW FLAGPOLE WITH DONOR SIGN (TOTAL: 6)
- NEW STEEL POLE (TOTAL: 26)
- NEW REMOVABLE GUARD CHAIN
- NEW ELECTRICAL PULL BOXES (TOTAL: 16; SEE SHEET L122 AND ELECTRICAL FOR TYPES)

LEGEND: EXISTING

- dotd ○ MANHOLE - D.O.T.D.
- ⊗ MANHOLE - TRAFFIC
- ⊗ MANHOLE - TELEPHONE
- ⊗ MANHOLE - SEWER
- ⊗ MANHOLE - ELECTRIC
- ⊗ MANHOLE - DRAIN
- ⊗ MANHOLE - WATER
- WMO WATER METER
- WVO WATER VALVE
- GVO GAS VALVE
- SCOO SEWER CLEANOUT
- ⊗ STREETLIGHT - HISTORIC
- ☆ STREETLIGHT - NON-HISTORIC
- UG☆ UNDERGROUND LIGHT
- ⊗ FIRE DEPARTMENT SIAMESE CONNECTION
- ⊗ FIRE HYDRANT
- ⊗ TRAFFIC SIGNAL
- ⊗ TRAFFIC SIGNAL WITH ARMS
- CW ⊗ CROSSWALK SIGNAL
- ⊗ CATCH BASIN
- ⊗ OPEN GRATE
- EB □ ELECTRIC BOX
- TB □ TELEPHONE BOX
- Tr □ TRAFFIC BOX
- MPB □ TRAFFIC METER POLE & BOX
- ∅ SIGN

TYP. 5 THIS SIDE

8 THIS SIDE

16 THIS AREA

6 THIS SIDE

3 THIS SIDE

DRAFT

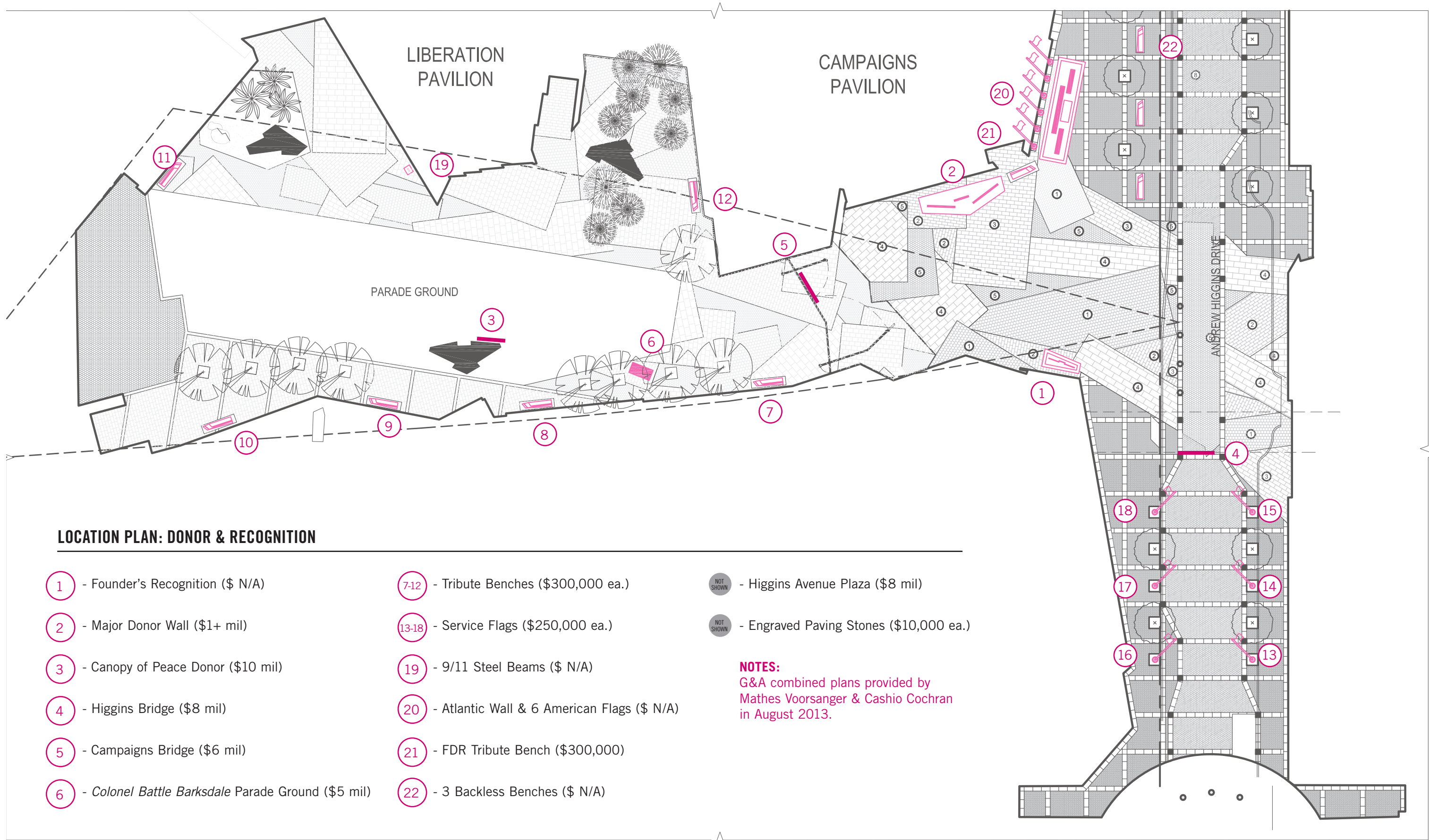

FOUNDERS WALL

The Founders Wall is placed on the west side of the Solomon Victory Theater. All three walls are set into a water-feature base within a stone frame that surface sits flush with the Parade Ground. "The Beginning" story is set at 0.675" cap height and 125 words. Both quotes are set at 1.25" cap height.

Note: Final engineering and local ADA code compliance TBD.

OPTION 1

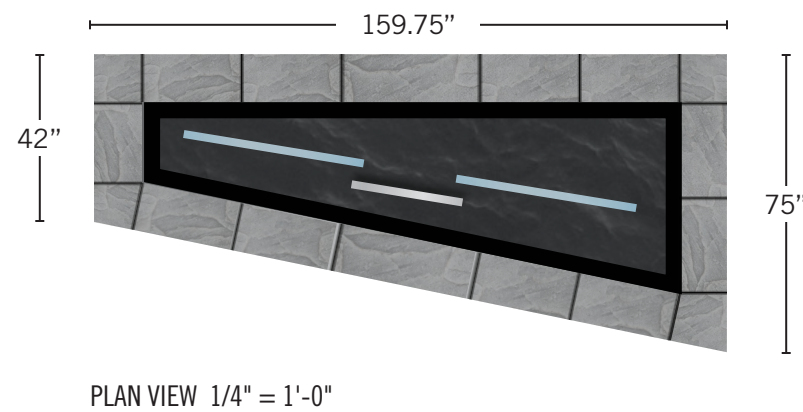
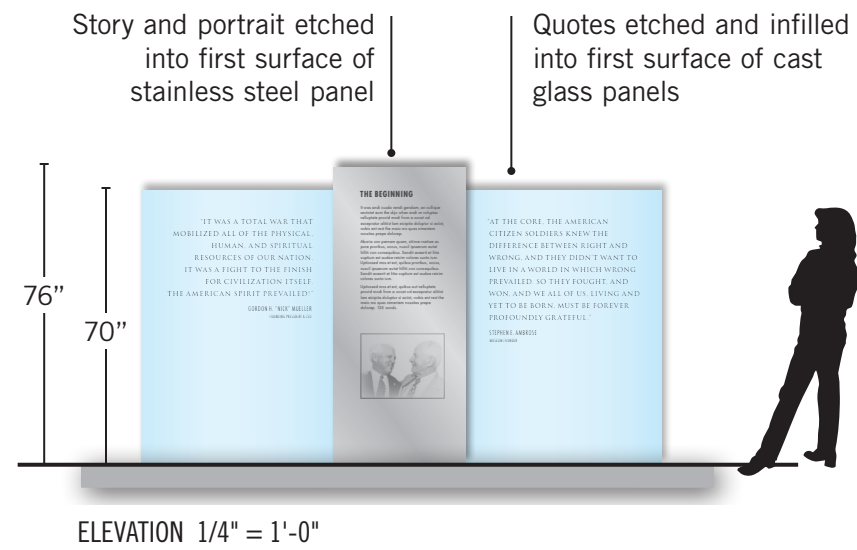

OPTION 2

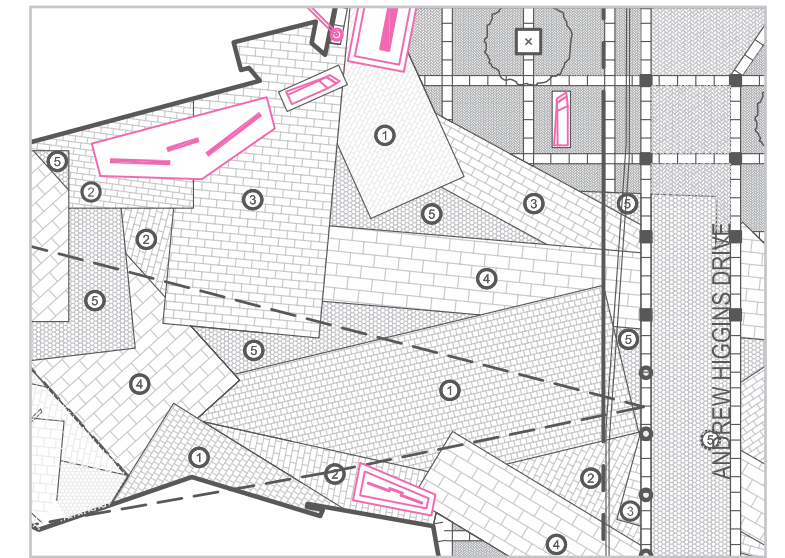
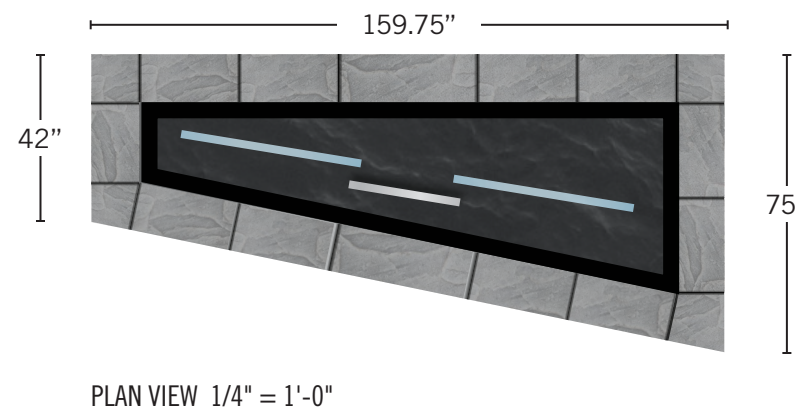
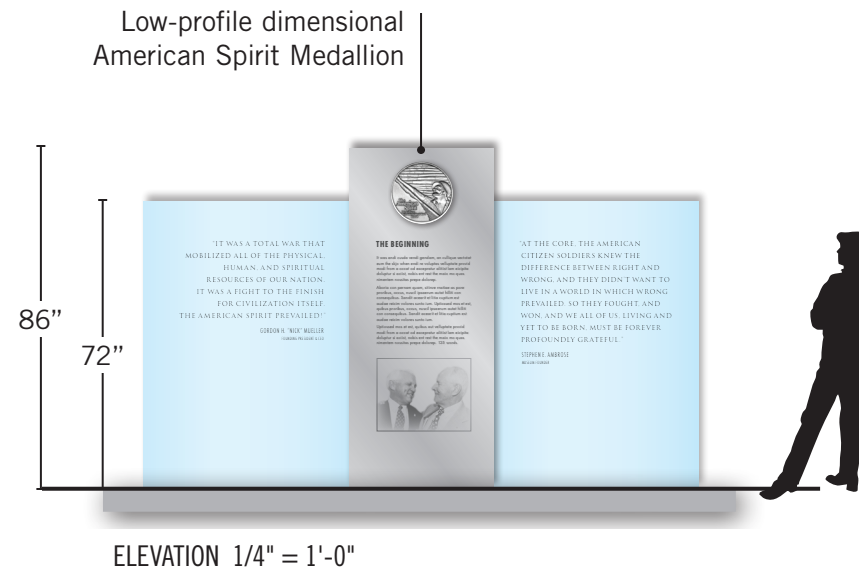

LOCATION PLAN 1/32" = 1'-0"

ATLANTIC WALL

The Atlantic Walls are placed on the north side of the Campaigns of Courage Pavilion. Wall elements are set into base within a stone frame that surface sits flush with the Parade Ground. The quote is on a raised panel above the water feature. The interpretive panel for the Atlantic Walls is set into stone frame. Six American flags are placed behind the Atlantic Wall as a backdrop.

Note: Final engineering and local ADA code compliance TBD.

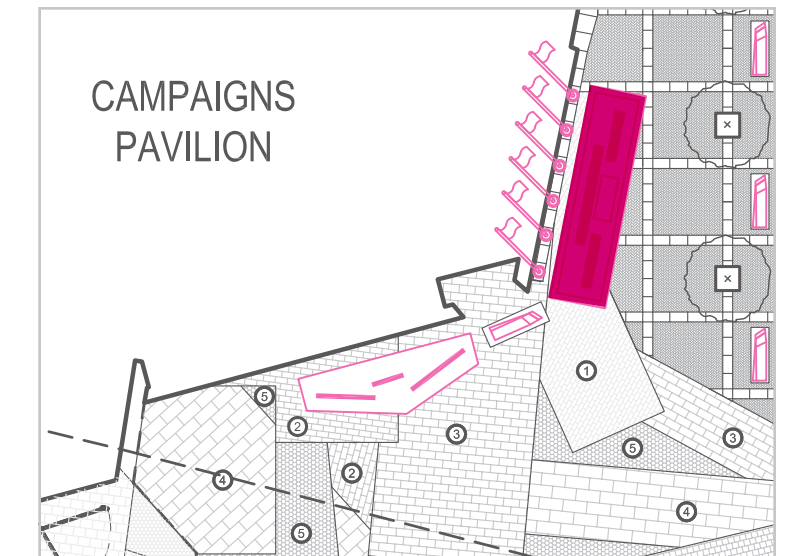

LOCATION PLAN 1/32" = 1'-0"

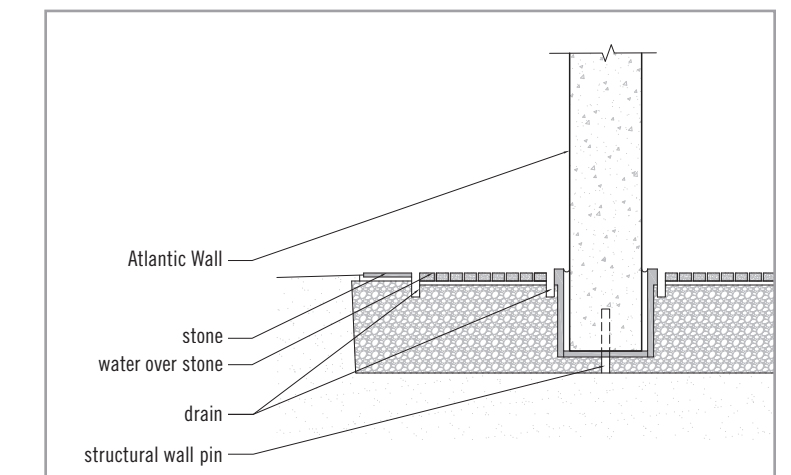

DETAIL SKETCH 1/4" = 1'-0"

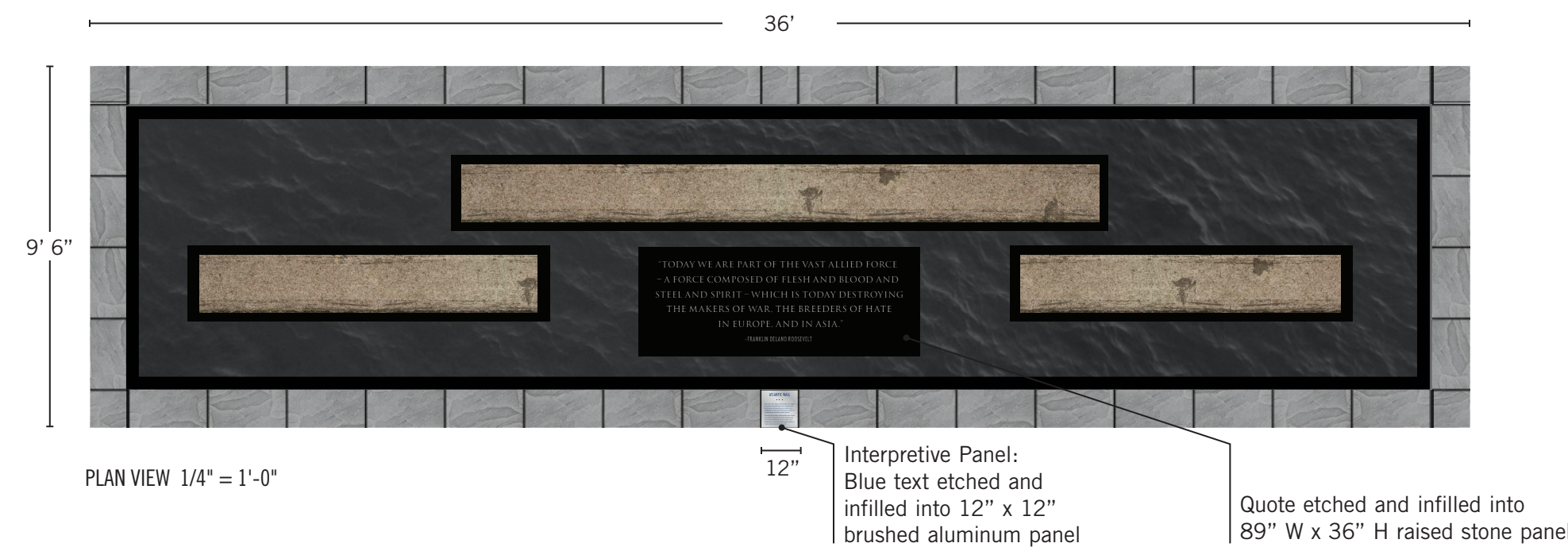

PLAQUES 1" = 1'-0"

NAME & NAME GOES HERE

Victory (\$10M +): Brushed Aluminum
36" w x 5.25" H - 2.5" C.H. (qty. 7)

NAME & NAME GOES HERE

Honor (\$5M-9.99M): Brushed Aluminum
21" w x 5.25" H - 1.675" C.H. (qty. 15)

NAME & NAME GOES HERE

Freedom (\$2M-4.99M): Brushed Aluminum
15" w x 5.25" H - 1.125" C.H. (qty. 15)

NAME & NAME GOES HERE

Liberty (\$1M-1.99M): Brushed Aluminum
13" w x 5.25" H - 1" C.H. (qty. 58)

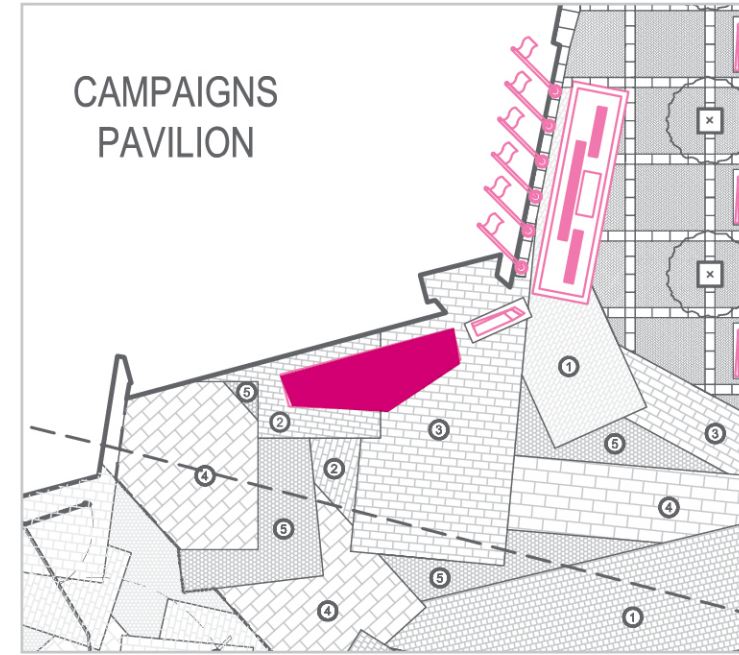

LOCATION PLAN 1/32" = 1'-0"

MAJOR DONOR WALL

The Major Donor Wall is placed at the north-east corner of the Campaigns of Courage Pavilion. Brushed aluminum plaques are etched and infilled with donor names, then pin mounted at varying depths to flame finished stone walls. Four levels of donations are represented with corresponding sized plaques. Behind the plaques, the walls have water running down their front face straight into a granite pool within a concrete base. The 3" cap height dimensional letter quote is brushed aluminum and pin-mounted with the water feature running behind.

Note: Final engineering and local ADA code compliance TBD.

33' 7/12"



ELEVATION 1/2" = 1'-0"

SERVICE FLAGS

The six service branch flags are hung from 30' tall - 6" diameter flag poles along Higgins. Flag poles are set into a concrete base with a donor/interpretive panel.

Note: Final height and installation TBD based on engineering.

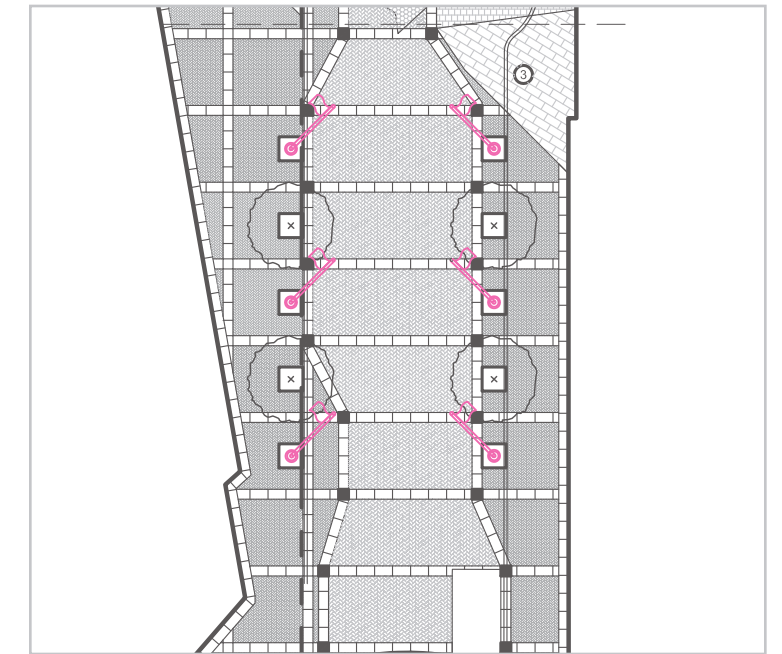
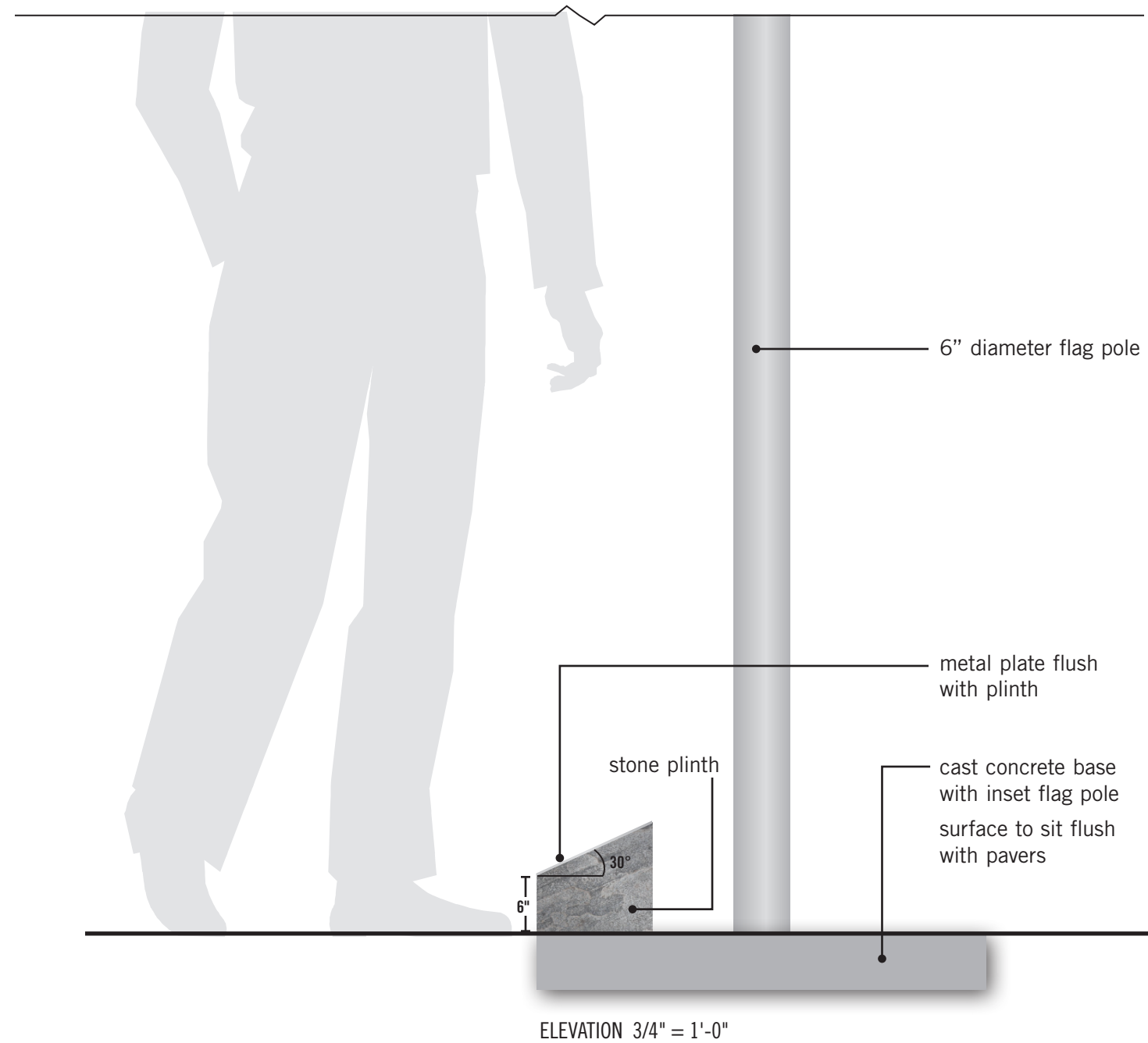

LOCATION PLAN 1/32" = 1'-0"



ELEVATION 3/4" = 1'-0"

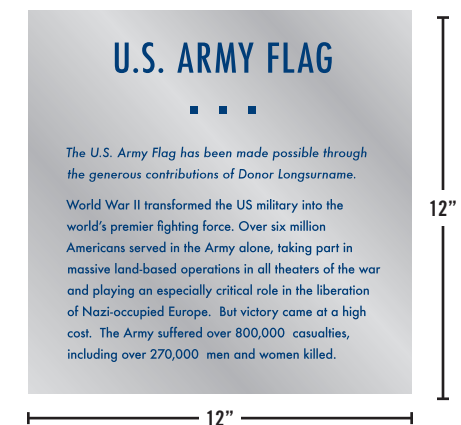

TOP PLAN 2" = 1'-0"

TRIBUTE BENCH



RENDERING VIEW (NTS)

TRIBUTE BENCHES

Seven tribute benches will be placed throughout the Parade Ground. Each bench will feature a unique character: Dwight Eisenhower, Chester Nimitz, Harry S. Truman, Franklin Delano Roosevelt, George Marshall, Douglas MacArthur, a war orphan (perhaps reading a telegram), a holocaust survivor and a Rosie the riveter.

The benches are comprised of a cut stone slab with a polished seat and back (or backless) and a bronze statue (seated or standing; attached to bench or pavers as applicable). A quote will be deep etched into the front face of the slab.

When a donor is named, it will be placed on the angled edge of the bench, inlaid into the ground. The plaque will be cut stone slab or bronze, with etched and infilled letters.

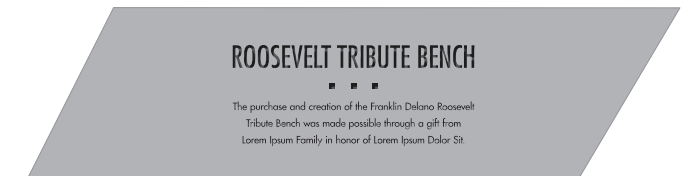

PLAN VIEW: DONOR PLAQUE
SCALE: 1 1/2" = 1' 0"

BACKLESS TRIBUTE BENCHES

Three backless tribute benches will be placed outside of the Parade Ground near the Atlantic Wall. Each bench will feature a unique character: a war orphan (perhaps reading a telegram), a holocaust survivor and a Rosie the riveter.

The benches are comprised of a cut stone slab with a polished seat and a bronze statue (standing; attached to bench or pavers as applicable). A quote will be deep etched into the front face of the slab.

When a donor is named, it will be placed on the angled edge of the bench, inlaid into the ground. The plaque will be cut stone slab or bronze, with etched and inlaid letters.

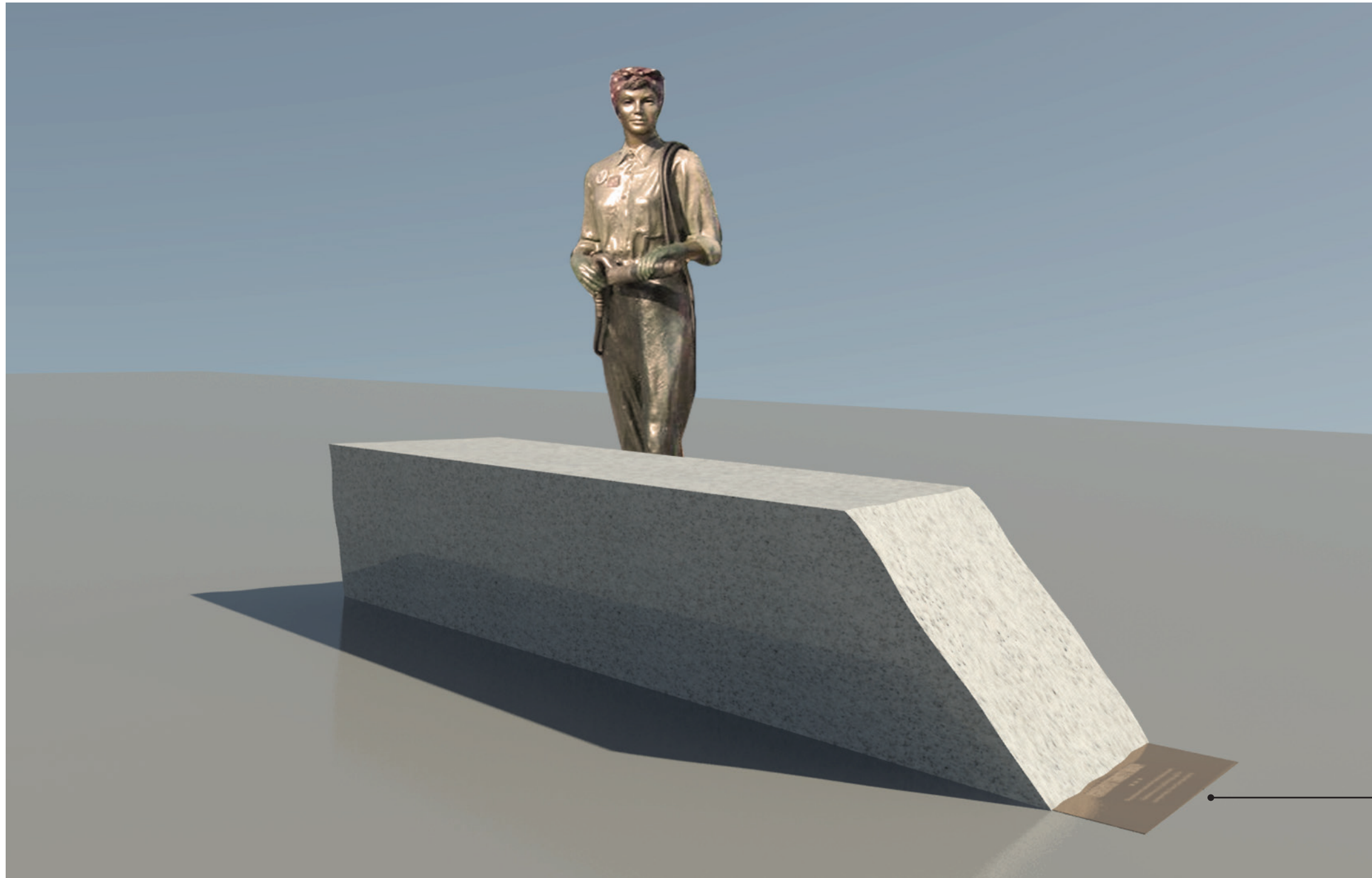

RENDERING VIEW (NTS)

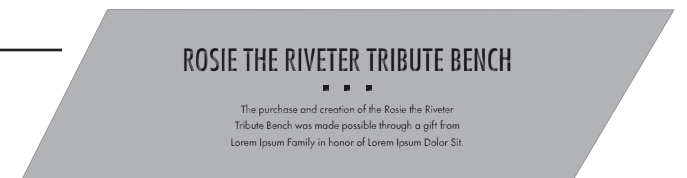

PLAN VIEW: DONOR PLAQUE
SCALE: 1 1/2" = 1' 0"