

**spackman  
mossop  
michaels**

1824 Sophie Wright Place  
New Orleans | LA | 70130  
T: 504.218.8991

LANDSCAPE ARCHITECT



# GERNON BROWN RECREATION CENTER NEW PLAY STRUCTURE

1001 HARRISON AVENUE, NEW ORLEANS, LOUISIANA

100% DESIGN DEVELOPMENT

Spackman Mossop Michaels | Landscape Architects

FOR PERMIT ONLY



12/04/2020

**GERNON BROWN RECREATION CENTER  
NEW PLAY STRUCTURE  
1001 HARRISON AVENUE  
NEW ORLEANS, LOUISIANA  
100% DESIGN DEVELOPMENT**

## PROJECT DIRECTORY

**OWNER/USER**  
City of New Orleans  
Capital Projects Administration  
1300 Perdido Street  
Suite 6E15  
New Orleans, LA 70112  
TEL: (504) 658-8666

**LANDSCAPE ARCHITECT (Prime)**  
Spackman Mossop Michaels  
1824 Sophie Wright Place  
New Orleans, LA 70130  
TEL: (504) 218-8991

**CIVIL ENGINEER**  
BATTURE, LLC  
5110 FRERET ST  
New Orleans, LA 70115  
TEL: (504) 533-8644

**ELECTRICAL ENGINEER**  
PIVOTAL ENGINEERING  
1515 POYDRAS ST. SUITE 1875  
New Orleans, LA 70112  
TEL: (504) 799-3653

## INDEX OF DRAWINGS

SHEET	TITLE
<b>GENERAL</b> G001	COVER & INDEX SHEET
<b>CIVIL</b> CT00	EXISTING CONDITIONS
<b>LANDSCAPE</b>	
SP101	SITE PREPARATION PLAN
SP900	SITE PREPARATION DETAILS
L201	MATERIALS PLAN
L301	GRADING PLAN
L501	PLANTING PLAN
L800	INCLUSIVE PLAY STRUCTURE ENLARGEMENT PLAN
L702	INCLUSIVE PLAY STRUCTURE SECTION & DETAILS
L900	SITE DETAILS
L901	SITE DETAILS
<b>ELECTRICAL</b> E1.0	EXTERIOR LIGHTING PLAN

## CONTEXT MAP

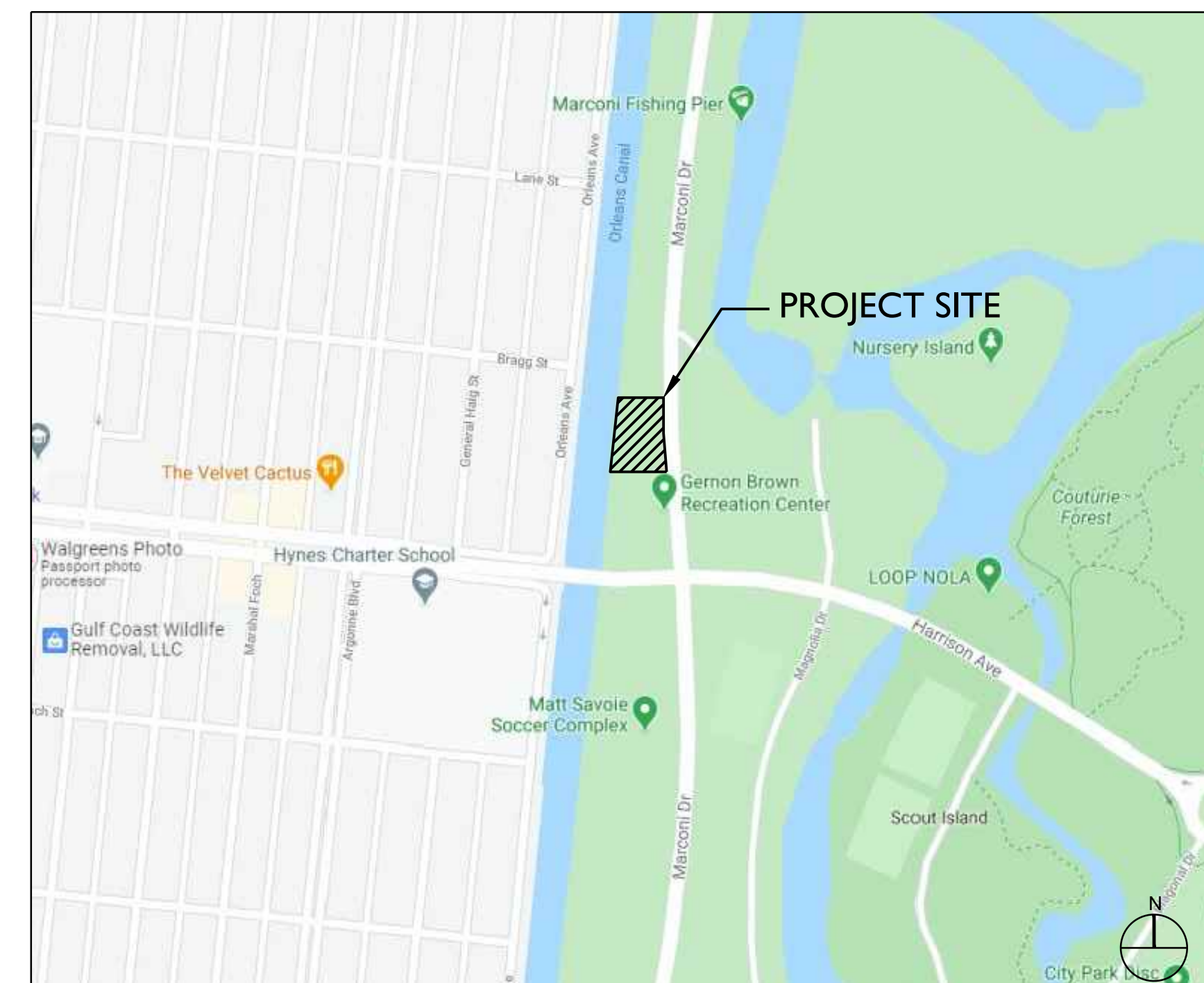

NOT TO SCALE

**STATUS**  
100% DESIGN DEVELOPMENT 10/21/2020

**REVISION**

NO.	DESCRIPTION	DATE

COVER SHEET  
& INDEX

DRAWING TITLE

SMM

DRAWN BY

**G001**

20022

JOB NO.

DRAWING NO.

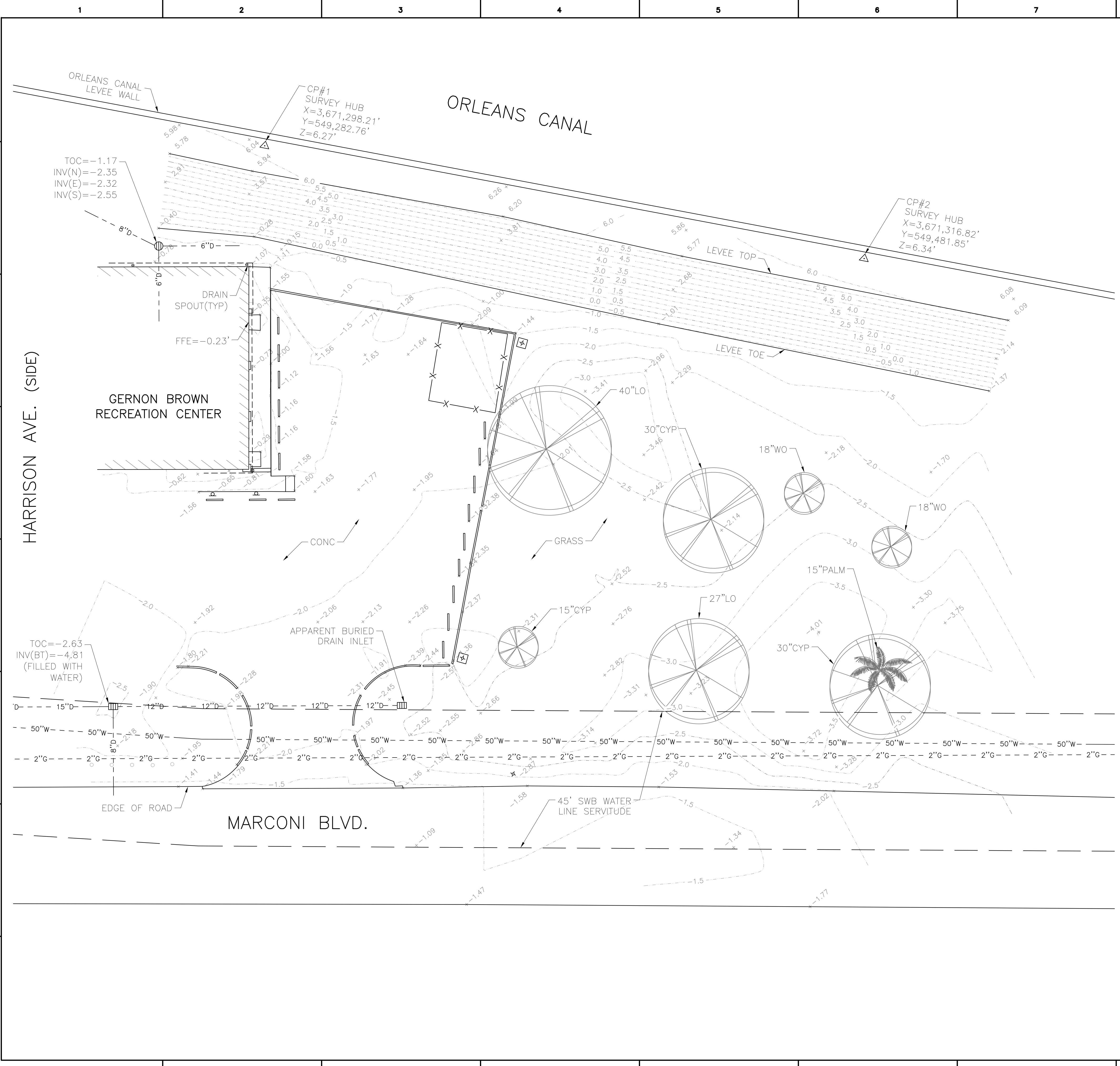

VICINITY MAP  
NOT TO SCALE

**LEGEND**

⋆	- LIGHT POLE	---	OHE	- OVERHEAD ELEC.
⊙	- DROP INLET, ROUND	---	(SIZE) D	- DRAIN LINE
⊠	- DROP INLET, SQUARE	---	T	- UG TELEPHONE
⊕	- SIGN, POLE MOUNTED	---	(SIZE) S	- SEWER LINE
⊙	- SPOT ELEVATION	---	(SIZE) G	- GAS LINE
△	- SURVEY HUB SET	---	(SIZE) W	- WATER LINE
⊙	- TREE	▨		- BUILDING

**NOTES:**

- THIS PLAN DOES NOT REPRESENT A BOUNDARY SURVEY.
- THE LOCATIONS OF UNDERGROUND AND OTHER NONVISIBLE UTILITIES SHOWN HEREON HAVE BEEN PLOTTED BASED UPON DATA EITHER FURNISHED BY THE AGENCIES CONTROLLING SUCH DATA AND/OR OBTAINED FROM RECORDS MADE AVAILABLE TO US BY THE AGENCIES CONTROLLING SUCH RECORDS. WHERE FOUND, THE SURFACE FEATURES OF UTILITIES ARE SHOWN. THE ACTUAL NONVISIBLE LOCATIONS MAY VARY FROM THOSE SHOWN HEREON. EACH AGENCY SHOULD BE CONTACTED RELATIVE TO THE PRECISE LOCATION OF ITS UNDERGROUND INSTALLATIONS PRIOR TO ANY RELIANCE UPON THE ACCURACY OF SUCH LOCATIONS SHOWN HEREON. PRIOR TO EXCAVATION AND DIGGING CALL LA. ONE CALL. (1-800-272-3020).
- NO TITLE RESEARCH OR UTILITY SERVITUDE RESEARCH WAS PERFORMED BY THE SURVEYOR.
- AS PER FLOOD INSURANCE RATE MAP, COMMUNITY-PANEL NUMBER 22071C0113F, EFFECTIVE DATE SEPTEMBER 30, 2016, THE SITE IS IN ZONE X (NO FLOOD ZONE).
- ELEVATIONS AND BEARINGS SHOWN ARE BASED ON GPS MEASUREMENTS, LSU GULF NET, VRS, NORTH AMERICAN DATUM (1983) LAMBERT CONFORMAL CONIC PROJECTION, LOUISIANA SOUTH ZONE, STATE PLANE COORDINATE SYSTEM, US SURVEY FEET, NAVD88.
- SOME FEATURES NOT DRAWN TO SCALE FOR CLARITY.

**spackman  
mossop  
michaels**

1824 Sophie Wright Place  
New Orleans | LA | 70130  
T: 504.218.8991

LANDSCAPE ARCHITECT

**BATTURE** LLC  
engineers + land surveyors

5110 FRERET STREET  
NEW ORLEANS, LA 70115  
PH 504-533-8644  
INFO@BATTURE-ENG.COM

**CIVIL ENGINEERS**

I HEREBY CERTIFY THIS PLAN REPRESENTS AN ACTUAL GROUND SURVEY MADE BY ME OR UNDER MY DIRECT SUPERVISION AND CONTROL.

ROBERT MORA PE, PLS  
PLS #5042  
JUNE 12, 2020  
(504) 533-8644

**GERNON BROWN RECREATION  
CENTER NEW PLAY STRUCTURE**  
1001 HARRISON AVENUE  
NEW ORLEANS, LOUISIANA

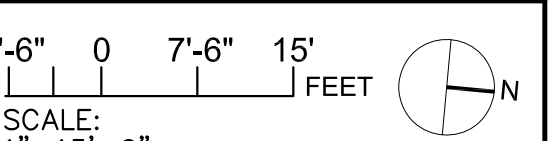

**STATUS**

REVISION NO.	DESCRIPTION	DATE

EXISTING  
CONDITIONS

**DRAWING TITLE**

BATTURE DRAWN BY	C100
20022 JOB NO.	
DRAWING NO.	





NOTES:  
 1- NO PRUNING SHALL BE PERFORMED EXCEPT BY APPROVED ARBORIST OR APPROVED BY LANDSCAPE ARCHITECT.  
 2- NO EQUIPMENT OR VEHICLES SHALL OPERATE OR PARK INSIDE THE PROTECTIVE FENCING INCLUDING DURING FENCE INSTALLATION AND REMOVAL.  
 3- SEE SITE PREPARATION PLAN FOR ANY MODIFICATIONS WITH THE TREE PROTECTION AREA.

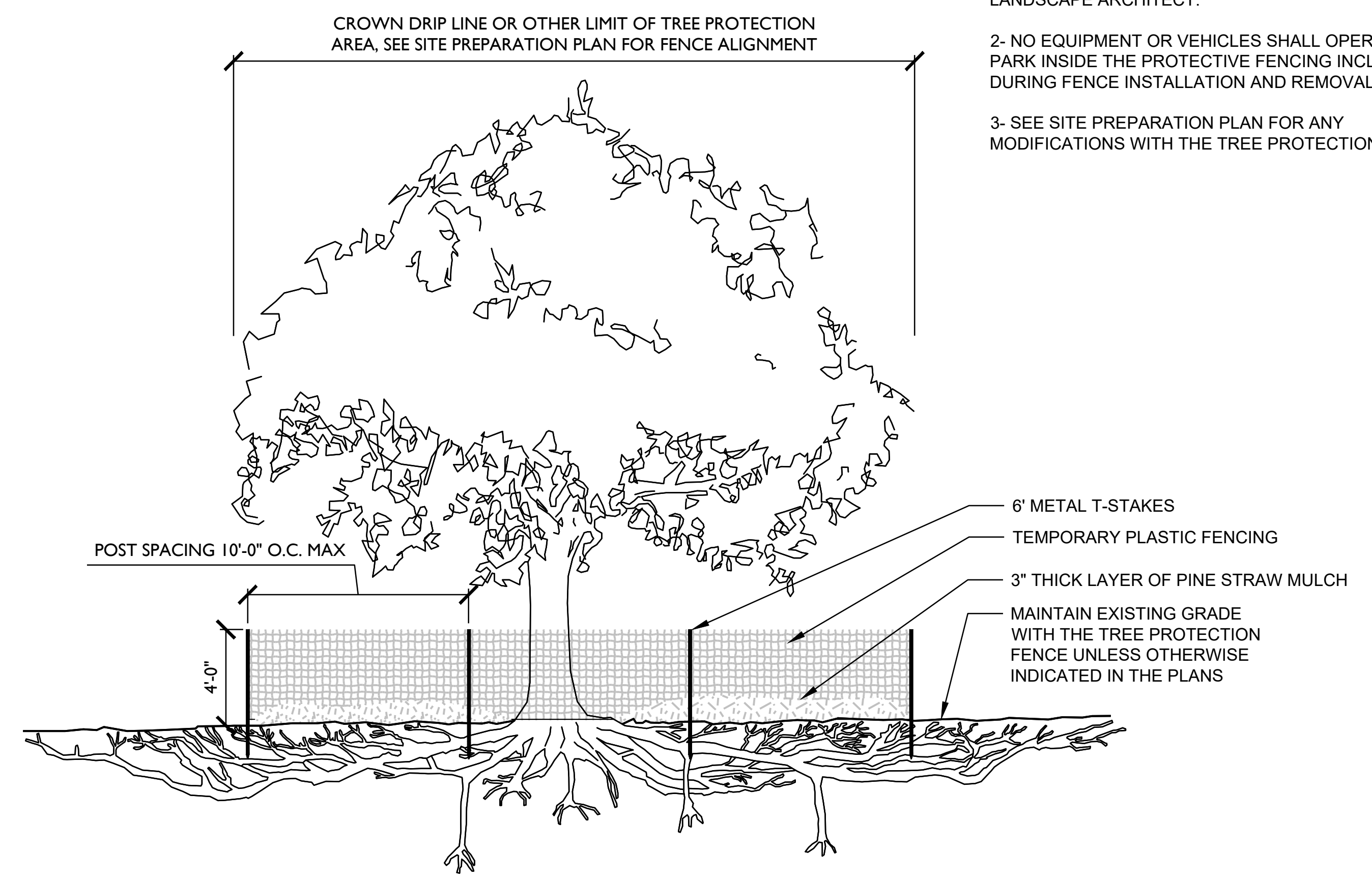

1 TREE PROTECTION FENCE, TYP.  
 Scale: 1/4"=1'-0"

DETAIL

**spackman  
 mossop  
 michaelis**

1824 Sophie Wright Place  
 New Orleans | LA | 70130  
 T: 504.218.8991

LANDSCAPE ARCHITECT

FOR PERMIT ONLY



12/04/2020

**GERNON BROWN RECREATION CENTER  
 NEW PLAY STRUCTURE  
 1001 HARRISON AVENUE  
 NEW ORLEANS, LOUISIANA  
 100% DESIGN DEVELOPMENT**

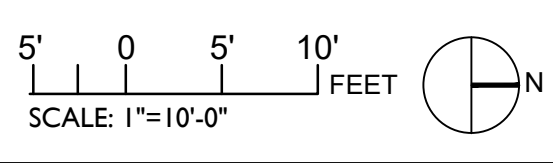

**STATUS**  
 100% DESIGN DEVELOPMENT 10/21/2020

**REVISION**

NO.	DESCRIPTION	DATE

SITE PREPARATION  
 DETAILS

DRAWING TITLE

SMM  
 DRAWN BY

**SP900**

20022  
 JOB NO. DRAWING NO.

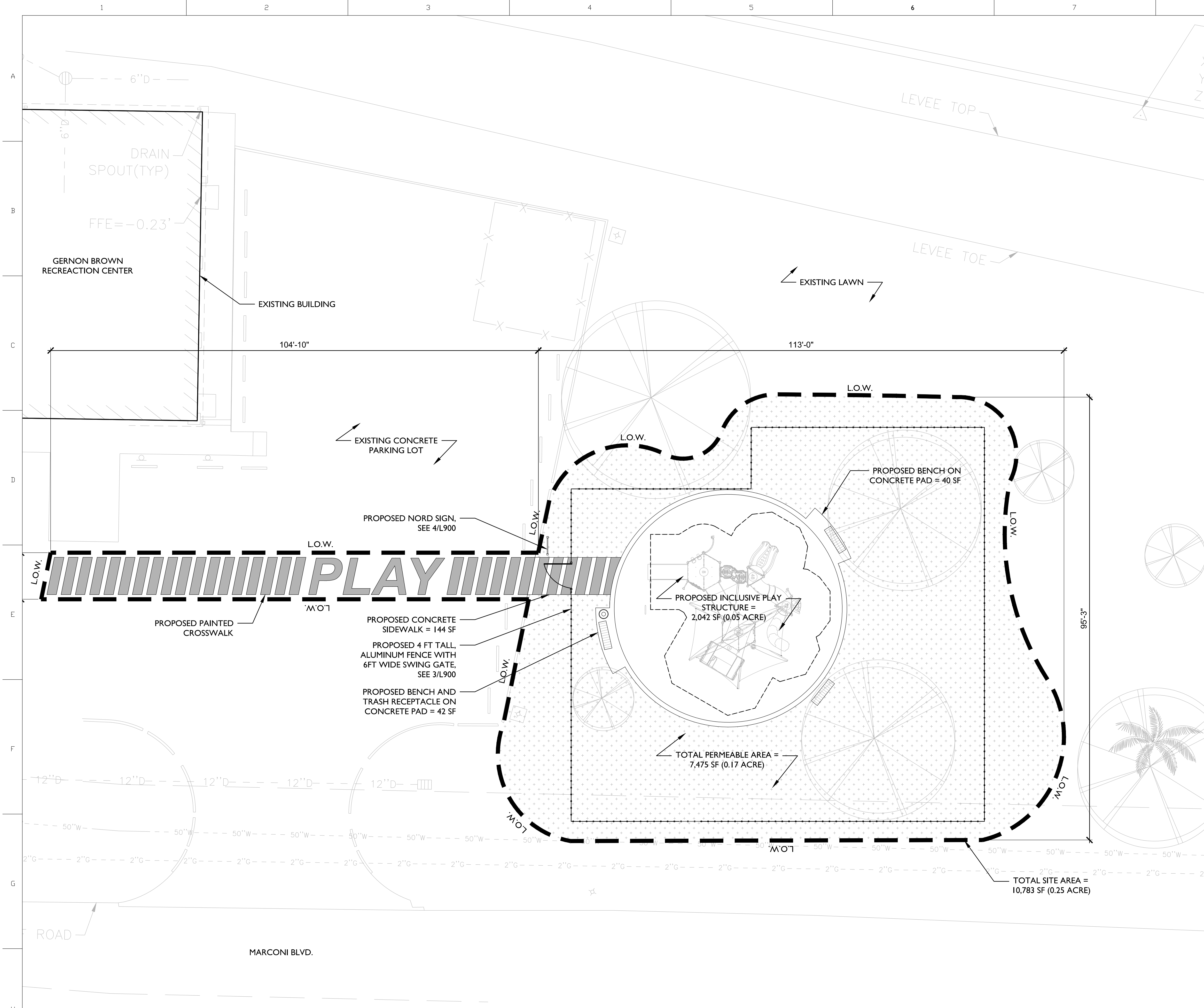

**GENERAL LEGEND**

- EXISTING BUILDINGS
- EXISTING TREES TO REMAIN AND BE PROTECTED
- EXISTING DRAIN INLETS
- EXISTING LIGHT POLES
- EXISTING CONTOURS
- EXISTING GAS LINE
- EXISTING WATER LINE
- EXISTING DRAIN LINE
- EXISTING FENCE LINE

**LEGEND**

- L.O.W. LIMIT OF WORK (L.O.W.)
- LAWN, SEE 1/L501
- 4' TALL ALUMINUM FENCE (32 31 19), SEE 1/L900

**NOTES**

1. TOTAL SITE AREA = 10,783 SF (0.25 ACRE)
2. TOTAL PERMEABLE AREA = 7,475 SF (0.17 ACRE)
3. TOTAL IMPERMEABLE AREA = 3,308 SF (0.08 ACRE)

**spackman  
mossop  
michaels**

1824 Sophie Wright Place  
New Orleans | LA | 70130  
T: 504.218.8991

LANDSCAPE ARCHITECT

FOR PERMIT ONLY



12/04/2020

**GERNON BROWN RECREATION CENTER  
NEW PLAY STRUCTURE  
1001 HARRISON AVENUE  
NEW ORLEANS, LOUISIANA  
100% DESIGN DEVELOPMENT**

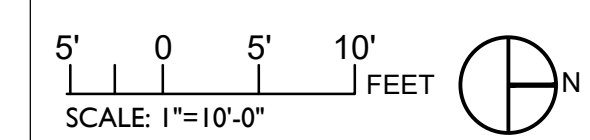

STATUS		
100% DESIGN DEVELOPMENT	10/21/2020	
REVISION		
NO.	DESCRIPTION	DATE

**SITE PLAN**

DRAWING TITLE

SMM	<b>LI01</b>
DRAWN BY	
20022	DRAWING NO.
JOB NO.	

**1 SITE PLAN**  
Scale: 1"=10'-0"

Plan

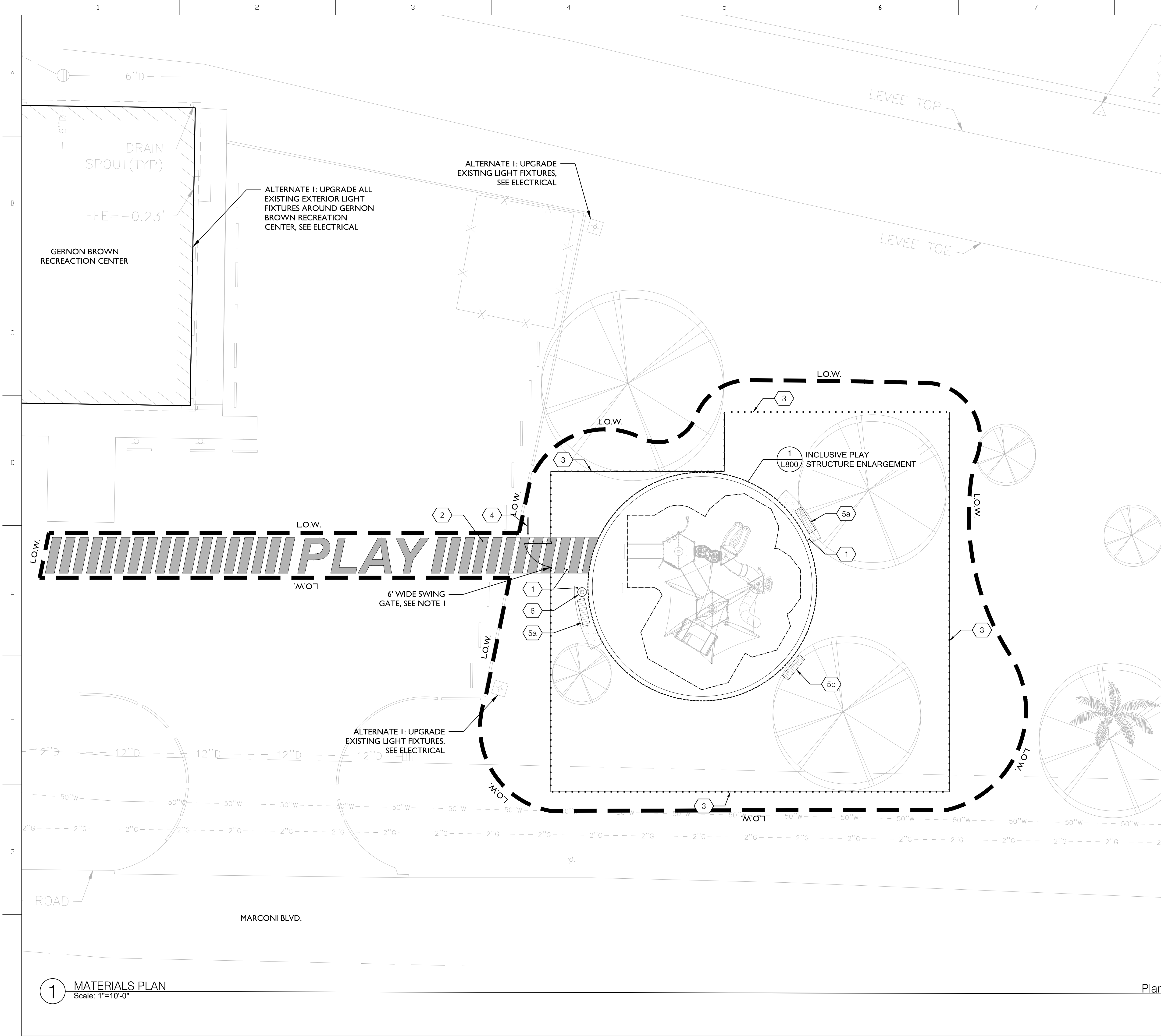

**GENERAL LEGEND**

- L.O.W.** EXISTING BUILDINGS
- EXISTING TREES TO REMAIN AND BE PROTECTED
- EXISTING DRAIN INLETS
- EXISTING LIGHT POLES
- EXISTING CONTOURS
- EXISTING GAS LINE
- EXISTING WATER LINE
- EXISTING DRAIN LINE
- EXISTING FENCE LINE

---

**LEGEND**

- CONCRETE PAVEMENT (03 30 00)
- PAINTED CROSSWALK (09 90 00)
- 4' TALL ALUMINUM FENCE (32 31 19), SEE 1/L900
- NORD SIGN, SEE 4/L900
- BENCH, SURFACE MOUNTED, SEE 3/L901
- BENCH, EMBEDDED, SEE 2/L901
- TRASH RECEPTACLE, SEE 1/L901

---

**NOTES**

- MANUFACTURER: ALUMI-GUARD®  
TYPE: 6' WIDE X 4' TALL SWING GATE, FLAT TOP, ASCOT 3-CHANNELS, COMMERCIAL GRADES  
COLOR: MATTE BLACK  
SEE L500 SERIES FOR PLANTING.
- SEE L500 SERIES FOR PLANTING.

**spackman  
mossop  
michaels**

1824 Sophie Wright Place  
New Orleans | LA | 70130  
T: 504.218.8991

LANDSCAPE ARCHITECT

FOR PERMIT ONLY



12/04/2020

**GERNON BROWN RECREATION CENTER  
NEW PLAY STRUCTURE  
1001 HARRISON AVENUE  
NEW ORLEANS, LOUISIANA  
100% DESIGN DEVELOPMENT**

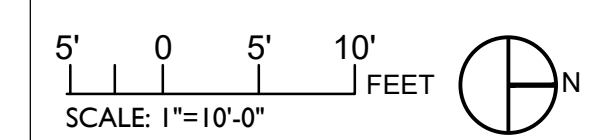

STATUS		
100% DESIGN DEVELOPMENT	10/21/2020	
REVISION		
NO.	DESCRIPTION	DATE

MATERIALS PLAN

DRAWING TITLE

SMM	<b>L201</b>
DRAWN BY	
20022	DRAWING NO.
JOB NO.	

**1 MATERIALS PLAN**  
Scale: 1"=10'-0"

Plan

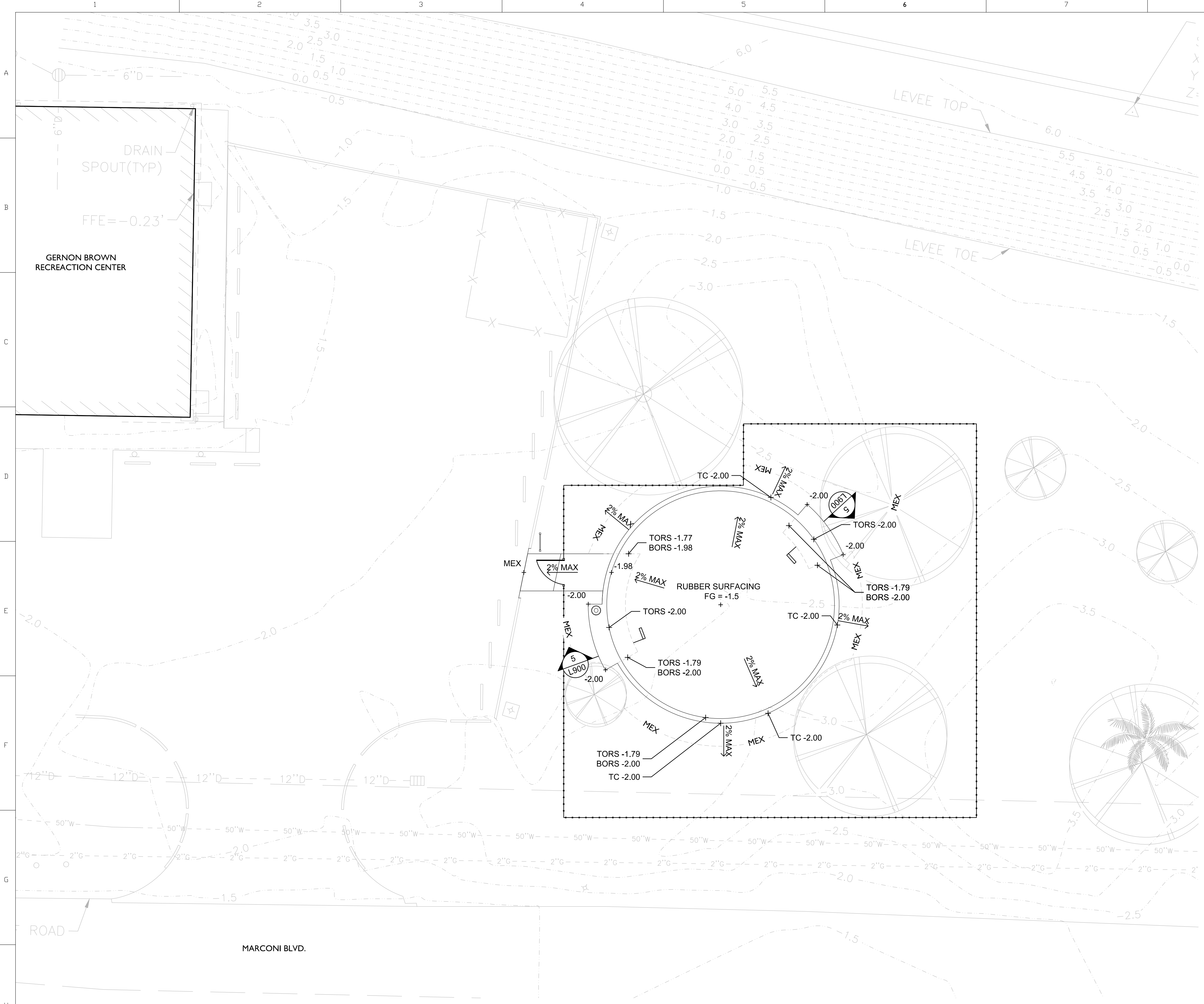

**1 GRADING PLAN**  
Scale: 1"=10'-0"

**GENERAL LEGEND**

- EXISTING BUILDINGS
- EXISTING TREES TO REMAIN AND BE PROTECTED
- EXISTING DRAIN INLETS
- EXISTING LIGHT POLES
- EXISTING CONTOURS
- EXISTING GAS LINE
- EXISTING WATER LINE
- EXISTING DRAIN LINE
- EXISTING FENCE LINE

---

**LEGEND**

- 0.00 PROPOSED GRADES
- + FG FINISH GRADE
- MEX MATCH EXISTING
- TC TOP OF CONCRETE
- BC BOTTOM OF CONCRETE
- TORS TOP OF RUBBER SURFACE
- BORS BOTTOM OF RUBBER SURFACE
- ← 0% PROPOSED SLOPE

---

**NOTES**

1. THE CONTRACTOR SHALL LAYOUT AND DETERMINE THE ELEVATIONS OF ALL SITE ELEMENTS FOR APPROVAL BY THE LANDSCAPE ARCHITECT PRIOR TO THE START OF CONSTRUCTION. THE CONTRACTOR SHALL REPORT ANY DISCREPANCIES IN WRITING TO THE CONSTRUCTION MANAGER. THE CONTRACTOR SHALL PROVIDE ELEVATIONS SIMULTANEOUSLY WITH LAYOUT.
2. THE CONTRACTOR SHALL FIELD VERIFY GRADES AND NOTIFY THE CONSTRUCTION MANAGER OF ANY DISCREPANCIES FOR RESOLUTION PRIOR TO STARTING CONSTRUCTION OPERATIONS. THE CONTRACTOR SHALL NOT PROCEED UNDER UNCERTAINTY AND SHALL ASSUME FULL RESPONSIBILITY OF ALL COSTS FOR REVISIONS DUE TO FAILURE TO GIVE SUCH NOTIFICATIONS.
3. THE CONTRACTOR SHALL BE RESPONSIBLE FOR POSITIVE SURFACE DRAINAGE IN ALL AREAS, UNLESS OTHERWISE NOTED. ALL NEWLY GRADED GROUND SURFACES SHALL BE FINISHED TO UNIFORM GRADES AND SLOPED IN SUCH A MANNER AS TO DRAIN PROPERLY AND BE FREE OF DEPRESSIONS THAT CAUSE AREAS OF STANDING WATER. WHERE PROPOSED GRADES MEET EXISTING, BLEND GRADES TO PROVIDE A SMOOTH TRANSITION BETWEEN THE NEW WORK AND THE EXISTING WORK. PONDING AT JOINTS WILL NOT BE ACCEPTED.
4. PATH LONGITUDINAL SLOPE NOT TO EXCEED 4.8%. VALUES OTHERWISE NOTED ON PLANS.
5. PATH CROSS SLOPE NOT TO EXCEED 1.8%. VALUES OTHERWISE NOTED ON PLANS.
6. PATH GRADES TO BE SMOOTH AND CONSISTENT BETWEEN PROVIDED SPOT ELEVATIONS, NOT TO EXCEED THE ABOVE NOTED SLOPES.
7. TRANSITION BETWEEN NEW PATH AND SIDEWALK TO BE SMOOTH AND CONSISTENT.
8. GRADING WITHIN THE DRIP LINES OF EXISTING TREES TO REMAIN AND NEW TREES SHALL BE DONE BY HAND TO AVOID DAMAGE TO TREE ROOTS.
9. THE CONTRACTOR SHALL ADJUST ALL UTILITY ELEMENTS OR COVERS TO BE FLUSH WITH THE FINAL FINISH GRADE WHETHER SHOWN ON THE DRAWINGS OR NOT.

**spackman  
mossop  
michaels**

1824 Sophie Wright Place  
New Orleans | LA | 70130  
T: 504.218.8991

LANDSCAPE ARCHITECT

FOR PERMIT ONLY



12/04/2020

**GERNON BROWN RECREATION CENTER  
NEW PLAY STRUCTURE  
1001 HARRISON AVENUE  
NEW ORLEANS, LOUISIANA  
100% DESIGN DEVELOPMENT**

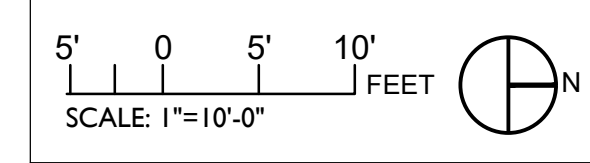

STATUS		
100% DESIGN DEVELOPMENT	10/21/2020	
REVISION		
NO.	DESCRIPTION	DATE

GRADING PLAN

DRAWING TITLE

SMM	<b>L301</b>
DRAWN BY	
20022	DRAWING NO.
JOB NO.	



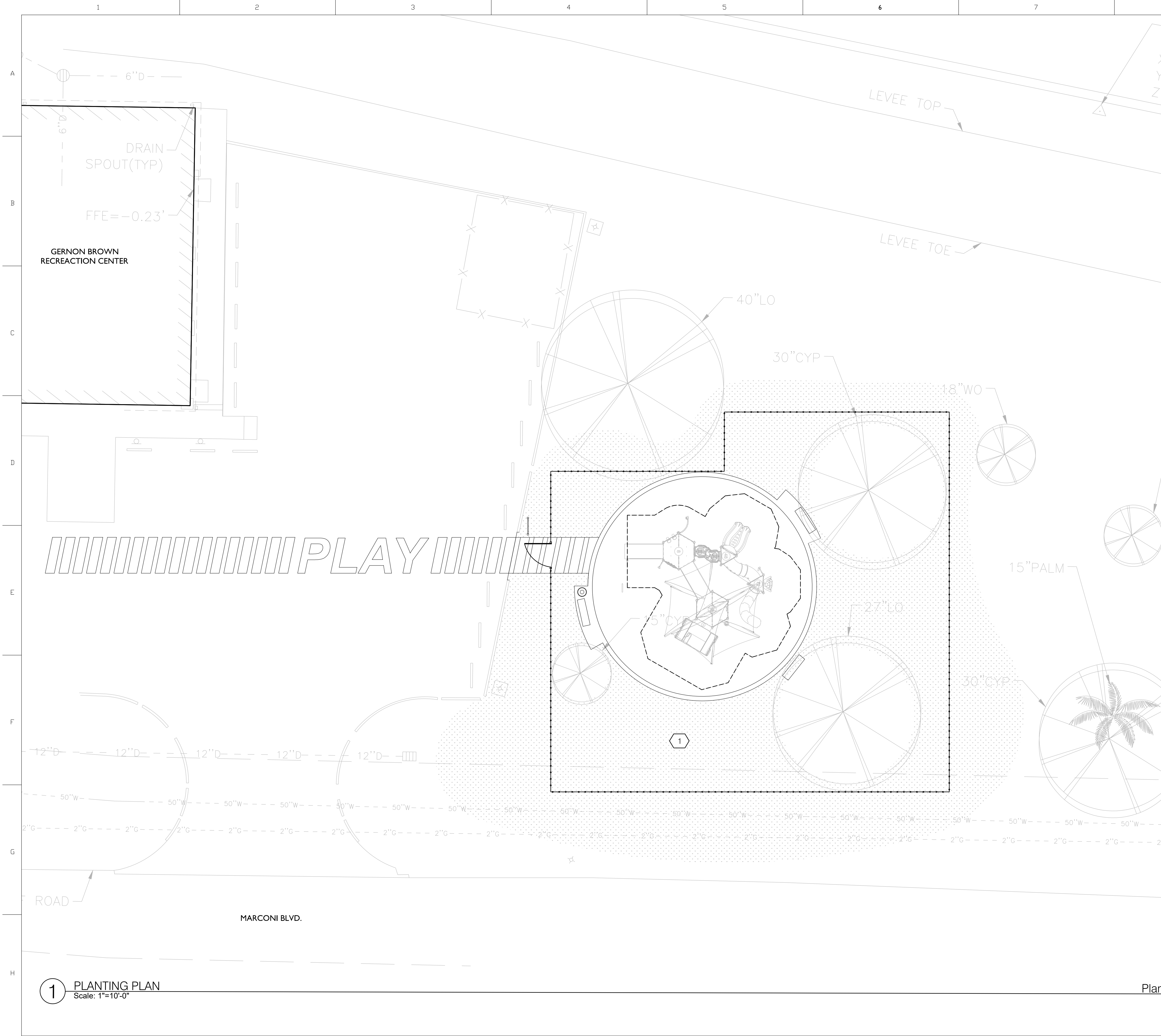

**GENERAL LEGEND**

- EXISTING BUILDINGS
- EXISTING TREES TO REMAIN AND BE PROTECTED
- EXISTING DRAIN INLETS
- EXISTING LIGHT POLES
- EXISTING CONTOURS
- EXISTING GAS LINE
- EXISTING WATER LINE
- EXISTING DRAIN LINE
- EXISTING FENCE LINE

**LEGEND**

- HYDRO-SEEDING (32 92 00) APPROX. 0.17 ACRES SEE NOTE 1

**NOTES**

- I. AREA TO BE REPAIRED/REPLACE WITH HYDRO-SEED. FILL AND LEVEL AREAS AS NECESSARY. DO NOT ALTER GRADES WITHIN THE CRITICAL ROOT ZONE OF ANY TREE BY MORE THAN 2".

**spackman  
mossop  
michaels**

1824 Sophie Wright Place  
New Orleans | LA | 70130  
T: 504.218.8991

LANDSCAPE ARCHITECT

FOR PERMIT ONLY



12/04/2020

**GERNON BROWN RECREATION CENTER  
NEW PLAY STRUCTURE  
1001 HARRISON AVENUE  
NEW ORLEANS, LOUISIANA  
100% DESIGN DEVELOPMENT**

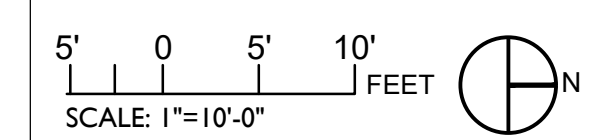

STATUS		
100% DESIGN DEVELOPMENT	10/21/2020	
REVISION		
NO.	DESCRIPTION	DATE

**PLANTING PLAN**

DRAWING TITLE

SMM	L501
DRAWN BY	
20022	DRAWING NO.
JOB NO.	

**1** PLANTING PLAN  
Scale: 1"=10'-0"

Plan

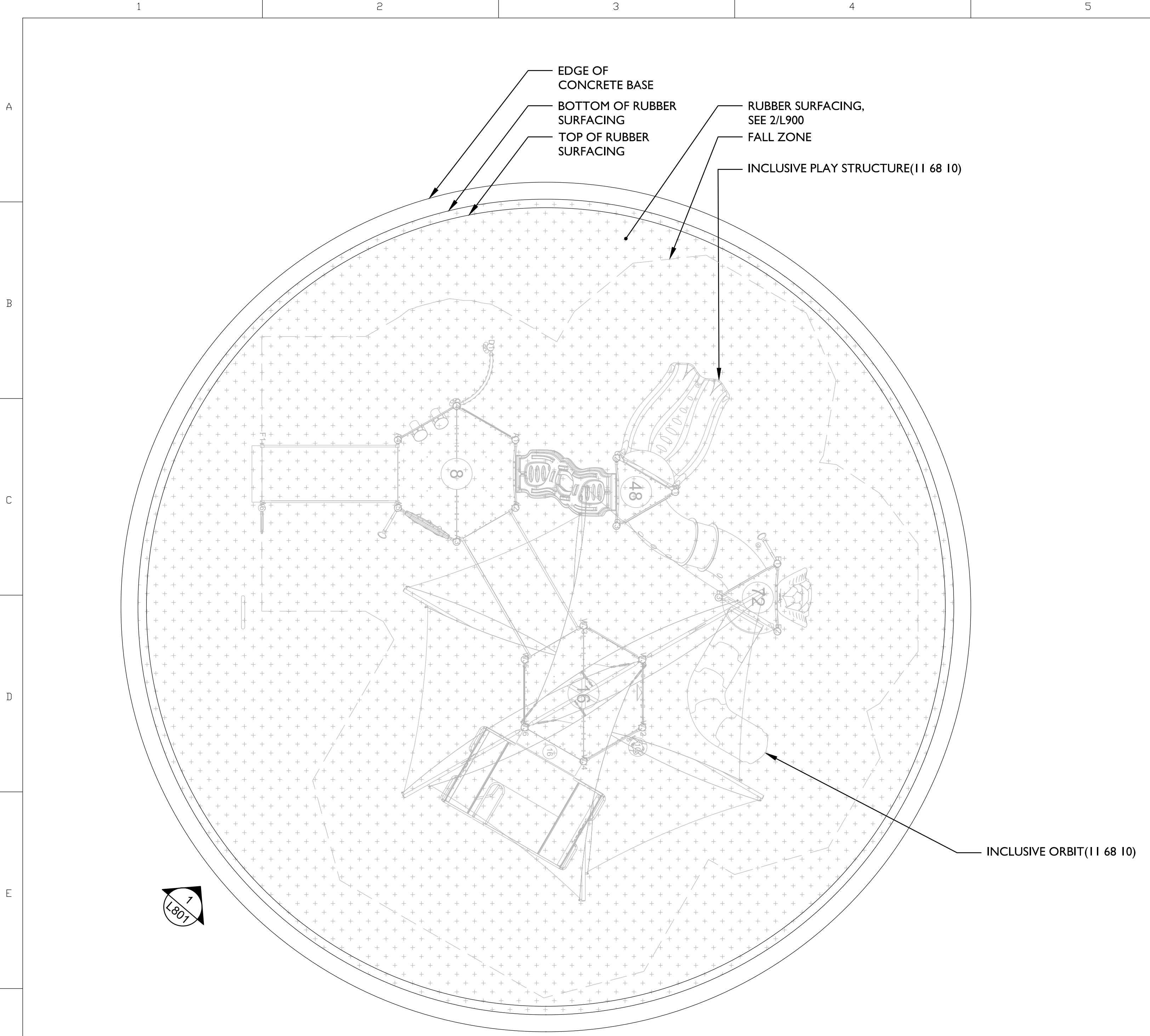

1 INCLUSIVE PLAY STRUCTURE ENLARGEMENT  
1/4"=1'-0"

Plan

**spackman  
mossop  
michaels**

1824 Sophie Wright Place  
New Orleans | LA | 70130  
T: 504.218.8991

LANDSCAPE ARCHITECT

FOR PERMIT ONLY



12/04/2020

**GERNON BROWN RECREATION CENTER  
NEW PLAY STRUCTURE  
1001 HARRISON AVENUE  
NEW ORLEANS, LOUISIANA  
100% DESIGN DEVELOPMENT**

**STATUS**  
100% DESIGN DEVELOPMENT 10/21/2020

REVISION		
NO.	DESCRIPTION	DATE

INCLUSIVE PLAY STRUCTURE  
ENLARGEMENT PLAN

DRAWING TITLE

SMM  
DRAWN BY

**L800**

20022  
JOB NO.

DRAWING NO.

**spackman  
mossop  
michaels**

1824 Sophie Wright Place  
New Orleans | LA | 70130  
T: 504.218.8991

LANDSCAPE ARCHITECT

FOR PERMIT ONLY



12/04/2020

**GERNON BROWN RECREATION CENTER  
NEW PLAY STRUCTURE  
1001 HARRISON AVENUE  
NEW ORLEANS, LOUISIANA  
100% DESIGN DEVELOPMENT**

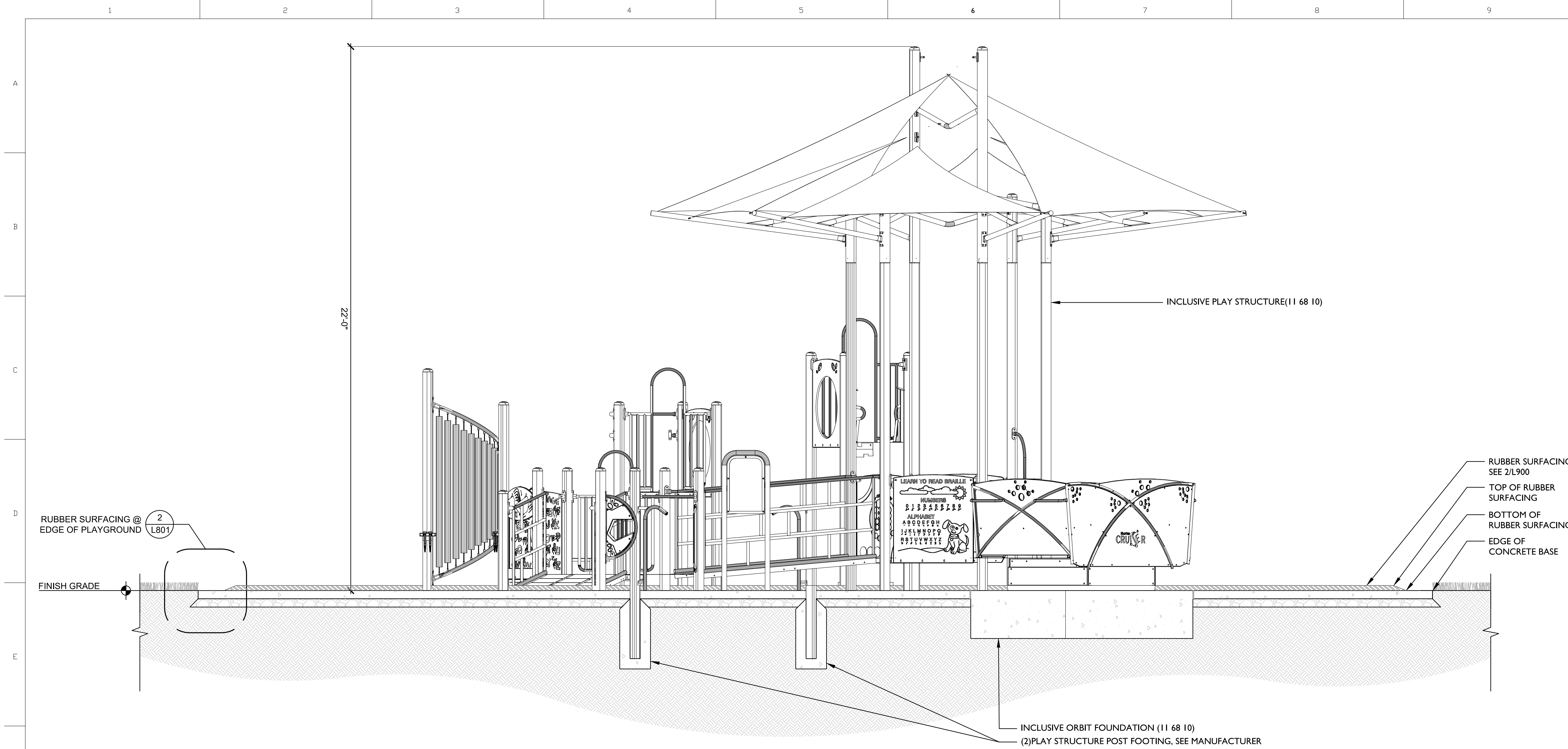

**1** INCLUSIVE PLAY STRUCTURE SECTION ELEVATION  
1/2"=1'-0"

Section Elevation

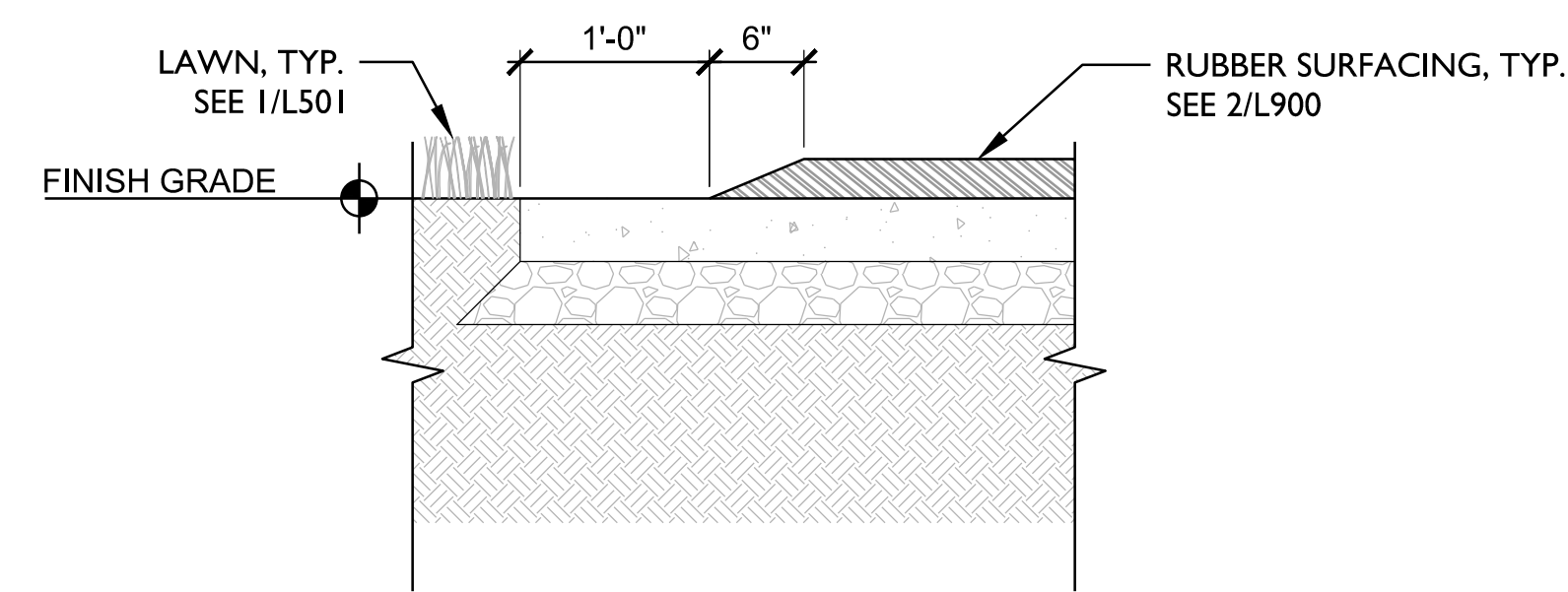

**2** RUBBER SURFACING @ EDGE OF PLAYGROUND  
1"=1'-0"

DETAIL

STATUS		
100% DESIGN DEVELOPMENT	10/21/2020	
REVISION		
NO.	DESCRIPTION	DATE

DRAWING TITLE	
SMM	<b>L801</b>
DRAWN BY	
20022	DRAWING NO.
JOB NO.	



**COLOR KEY**

- YELLOW
- B YELLOW/BLUE





ITEM	COMP.	DESCRIPTION
1	270-0001	OFFSET ENCLOSURE
2	270-0112	UNITARY ENCLOSURE
3	270-0129	TRIANGLE PLATFORM
4	270-0131	HEXAGONAL PLATFORM S5P
5	270-0221	8" RISE RAMP W/ GUARDRAILS
6	270-0223	8" RISE ENTRANCE RAMP W/ GU
7	270-0263	FUN PHONE GRND - GRND
8	370-0746	AMPED LINK I
9	370-1648	MANITOU CLIMBER 72"
10	470-0678	ARA HEX SHADE CANOPY
11	470-0737	VIPER L2 64-72 W/O HOOD
12	470-0755	LUGE SLIDE, 48"-56"
13	470-0805	SLIDE HOOD, HIGH SIDE WALL
14	560-0453	STEP SPOT POD 8-16"
15	560-0563	CRUISER WITH ADAPTER
16	570-0410	PLAYENSEMBLE TITAN CHIMES
17	570-0622	PLATFORM ROLL GUARD
18	570-0788	TIC TAC TOE PANEL ASSEMBLY
19	570-0811	BRaille PANEL
20	570-0848	SIGNING 2-SIDED PLAY PANEL
21	570-1506	TUNNEL, 24" OFFSET
22	570-1858	3-IN-A-ROW PANEL, ABOVE PLAT
23	570-2668	CAR ACCESSIBLE REACH PANEL
24	570-2670	DRUM ACCESSIBLE REACH PAN
25	570-2706	CHIMES CRESCENT PANEL, LEF
26	580-1022	FS SIGN, AGES 5-12 BOTH SID

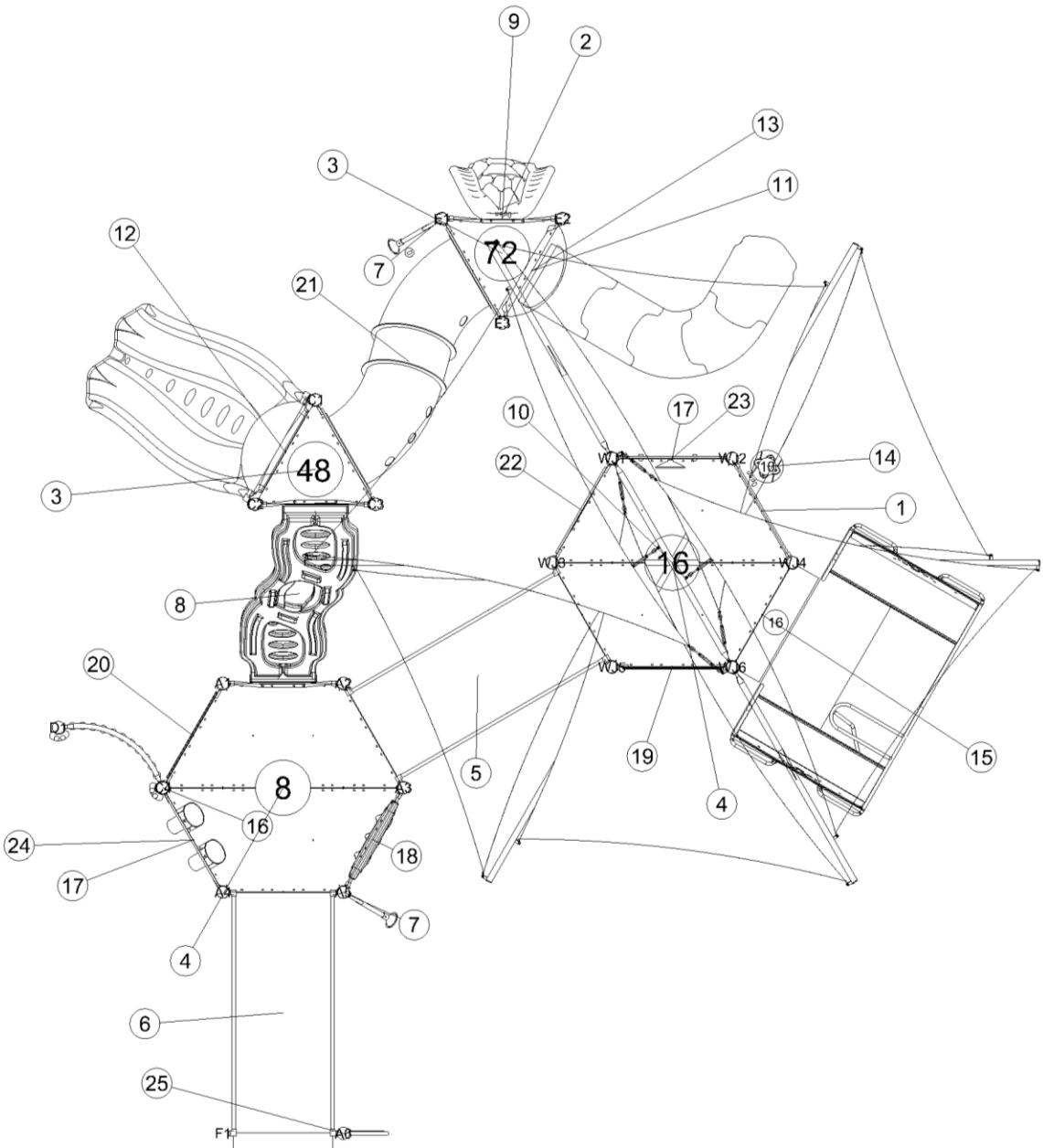

A BERM BY  
OTHERS MAY  
BE REQUIRED



SERIES: Basics, Nucleus  
COMPONENT PLAN  
DRAWN BY: Tyler Hess

New Orleans-Gerron Brown Park Option 1  
1001 Harrison Avenue  
N.O., LA 70124

September 25, 2020

Planet Recess  
140-131446-2

**spackman  
mossop  
michaels**

1824 Sophie Wright Place  
New Orleans | LA | 70130  
T: 504.218.8991

LANDSCAPE ARCHITECT

FOR PERMIT ONLY



12/04/2020

**GERNON BROWN RECREATION CENTER  
NEW PLAY STRUCTURE  
1001 HARRISON AVENUE  
NEW ORLEANS, LOUISIANA  
100% DESIGN DEVELOPMENT**

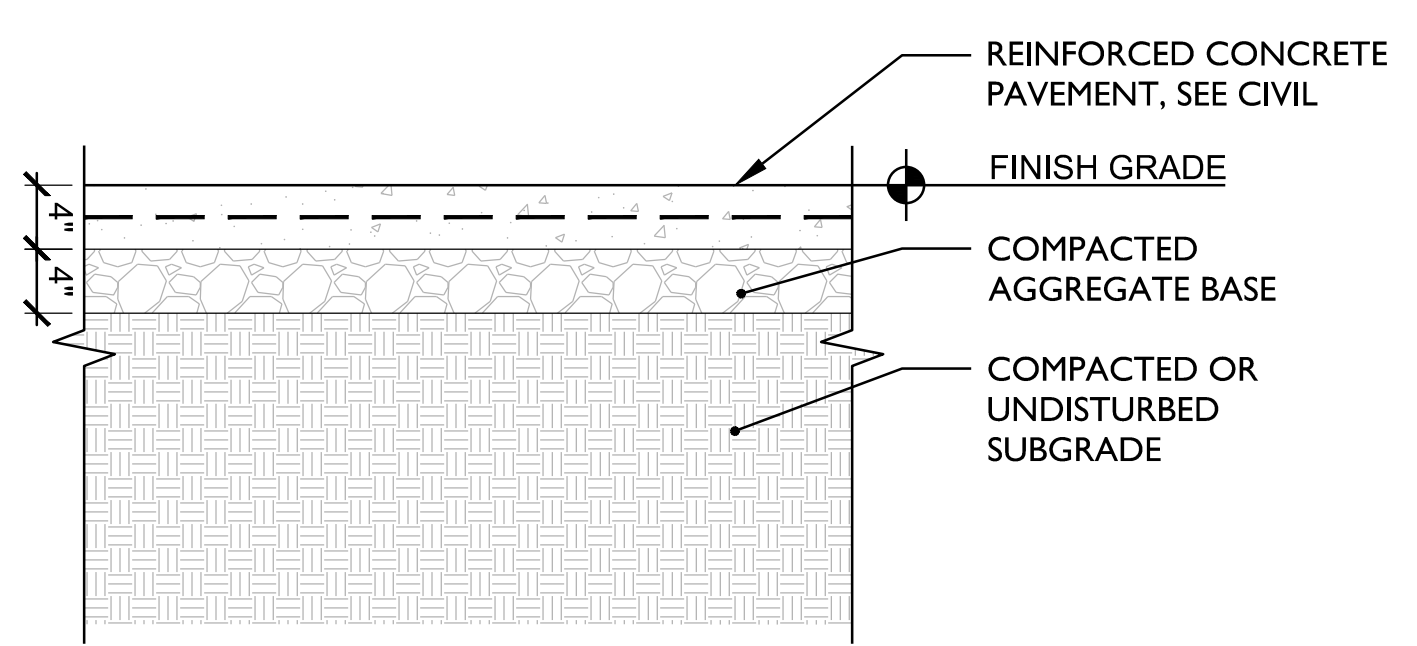

**1** CONCRETE PAVEMENT, TYP. 1"=1'-0" DETAIL

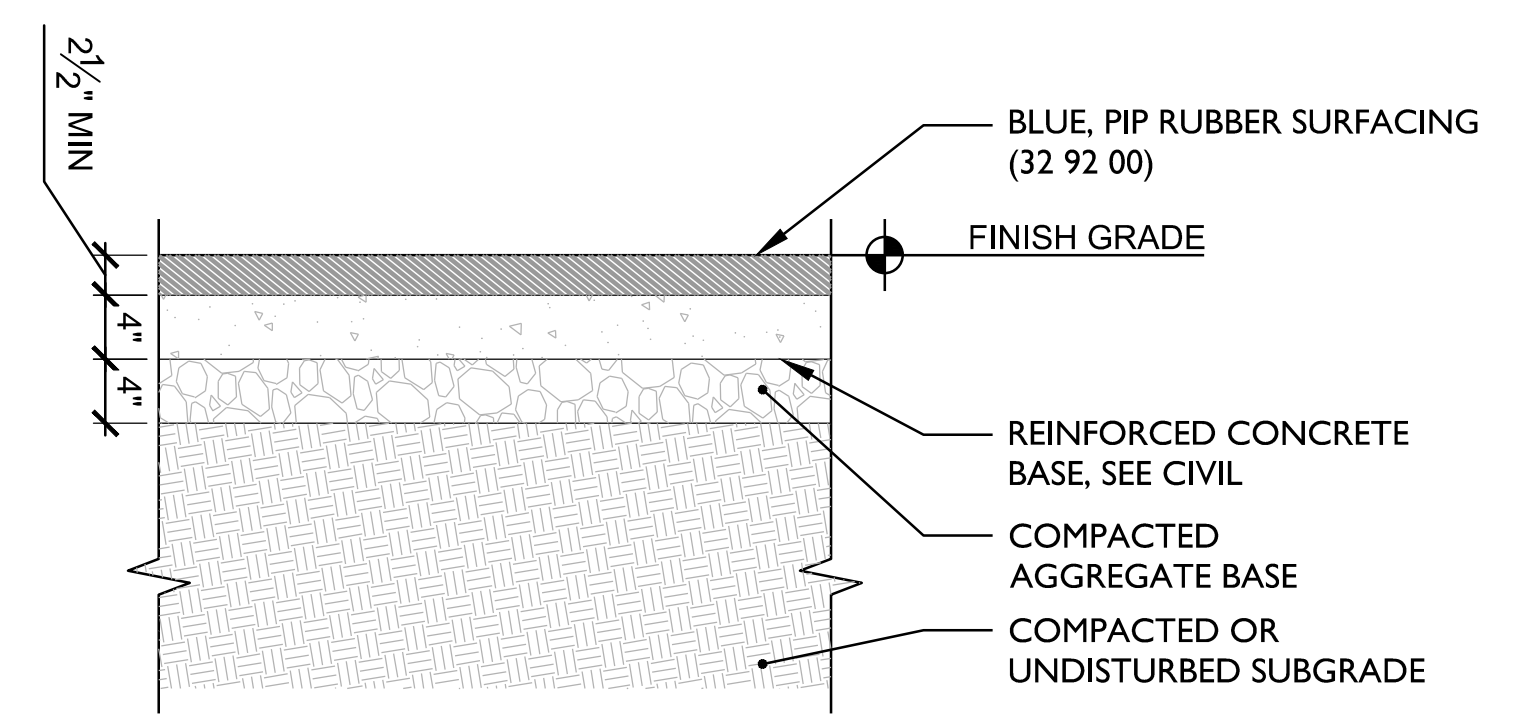

**2** RUBBER SURFACING, TYP. 1"=1'-0" DETAIL

- NOTES:**
- NO GAP IN FENCING SHALL BE LARGER THAN 4".
  - DRAWINGS OF FENCES, GATES, AND HARDWARE ARE FOR ILLUSTRATIVE PURPOSES ONLY. SHOP DRAWINGS OF FENCES, GATES, HARDWARE, AND GATE OPERATORS TO BE PROVIDED BY CONTRACTOR FOR REVIEW PRIOR TO INSTALLATION (32 31 19).
  - MANUFACTURER: ALUMI-GUARD®  
TYPE: FLAT TOP, ASCOT 3-CHANNELS, COMMERCIAL GRADES  
COLOR: MATTE BLACK

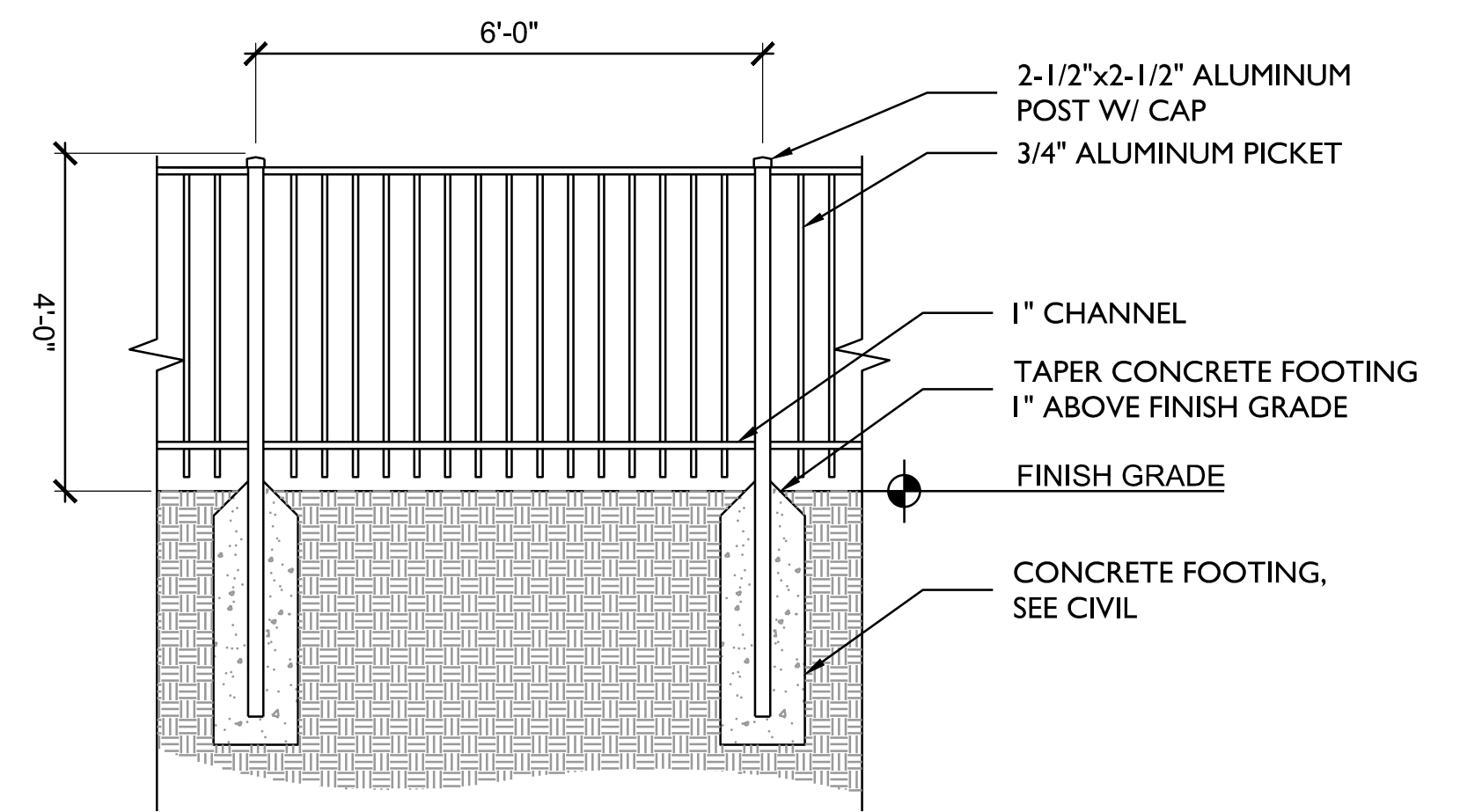

**3** FENCE, TYP. 1/2"=1'-0" DETAIL

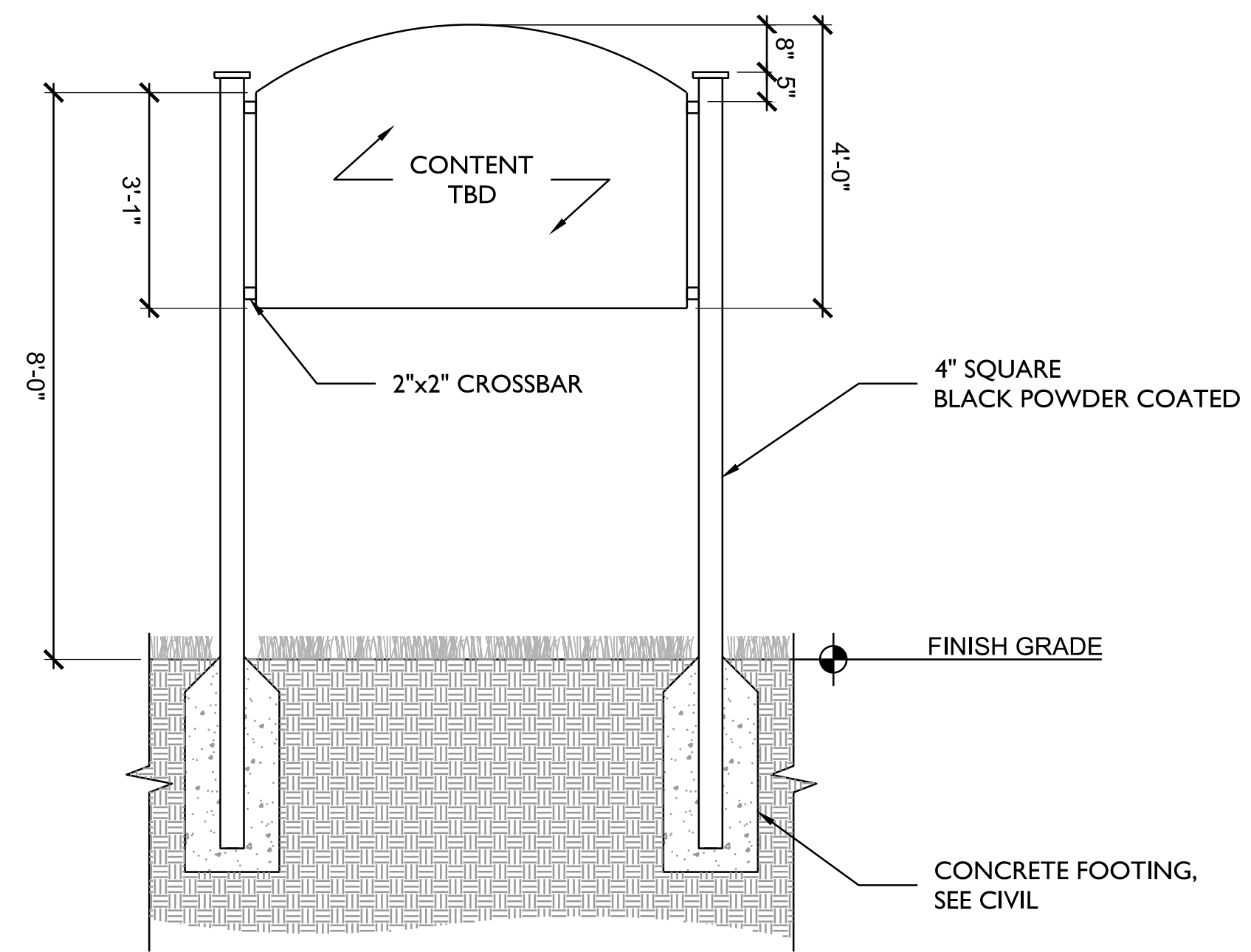

**4** NORD SIGN 1/2"=1'-0" DETAIL

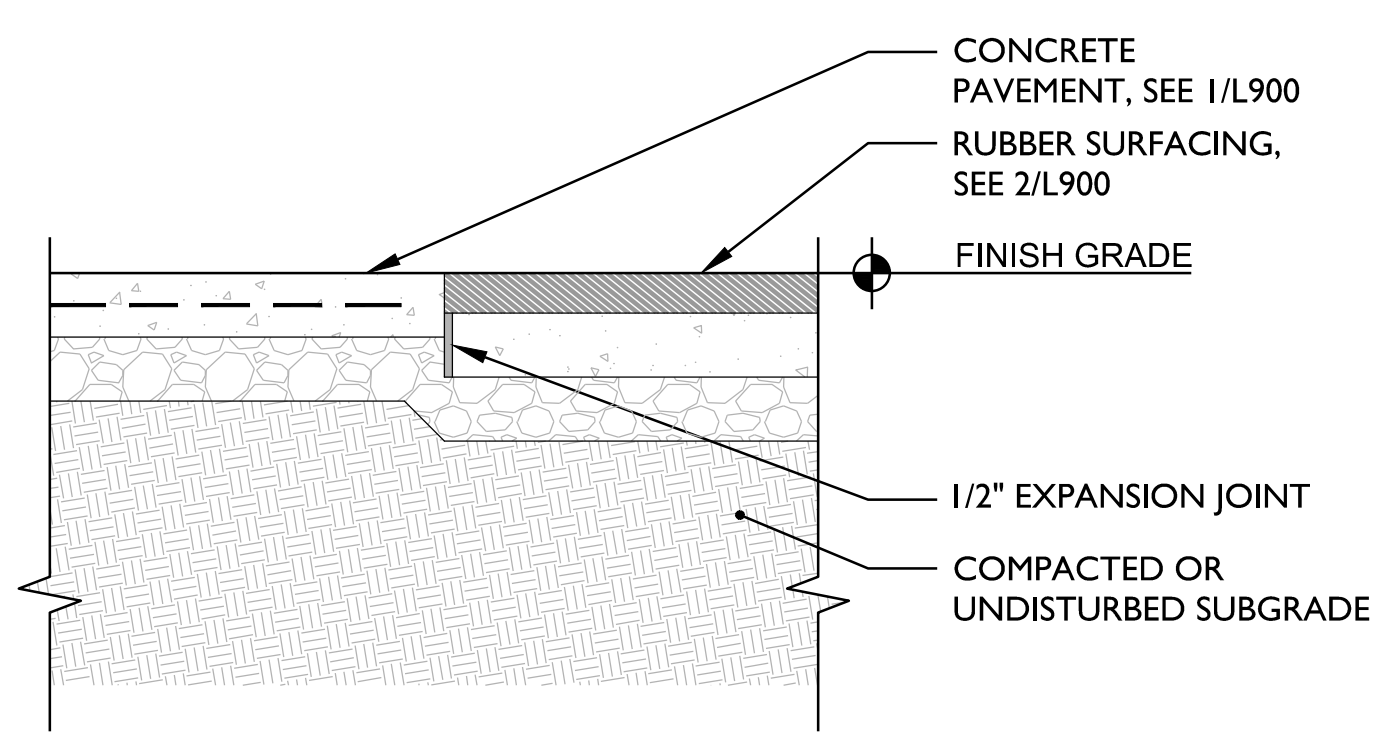

**5** RUBBER SURFACING @ CONCRETE PAVEMENT, TYP. 1"=1'-0" DETAIL

STATUS	
100% DESIGN DEVELOPMENT	10/21/2020
REVISION	
NO.	DESCRIPTION

SITE DETAILS	
DRAWING TITLE	
SMM	<b>L900</b>
DRAWN BY	
20022	DRAWING NO.
JOB NO.	

4" SQUARE  
BLACK POWDER COATED

2" x 2" CROSSBAR



www.nordc.org

A.L. Davis  
Playground



37"

2" x 2" CROSSBAR

2" space between  
pole and sign

8"

5"

4'

8'

5'

GROUND

**MATERIALS:**  
2 PANELS - 3MM ALUMINUM COMPOSITE  
DIGITALLY PRINTED  
VANDAL GUARD  
ANTI GRAFFITI LAMINATION

3'

11'4"



Same ownership > New name.

formerly



design | service | solutions

16" Diameter  
filled with cement

## AFTER CLIENT REVIEW OF ACTUAL SIGN

Colors Approved: \_\_\_\_\_

Date: \_\_\_\_\_

Layout Approved: \_\_\_\_\_

Date: \_\_\_\_\_

Material Approved: \_\_\_\_\_

Date: \_\_\_\_\_



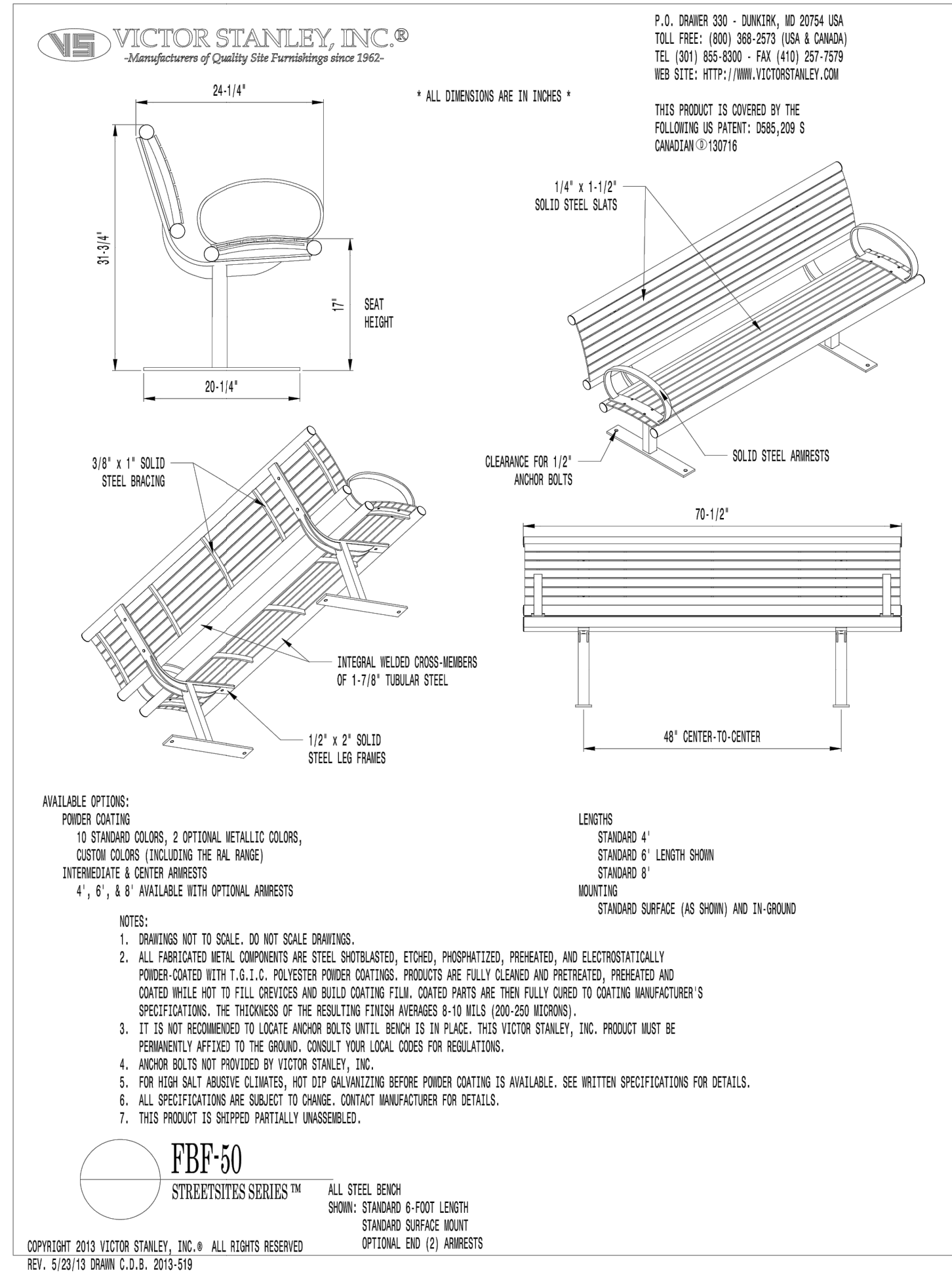
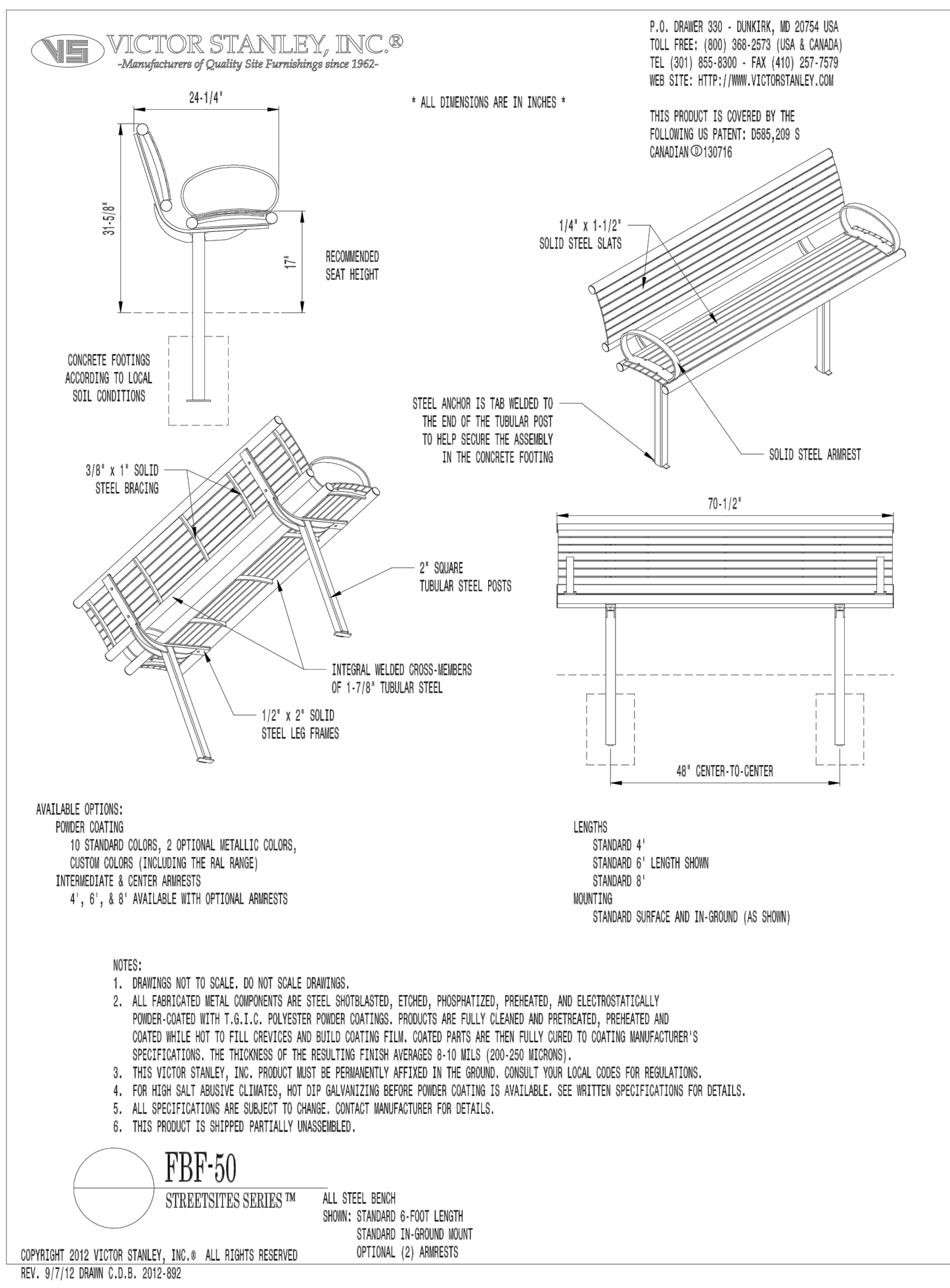
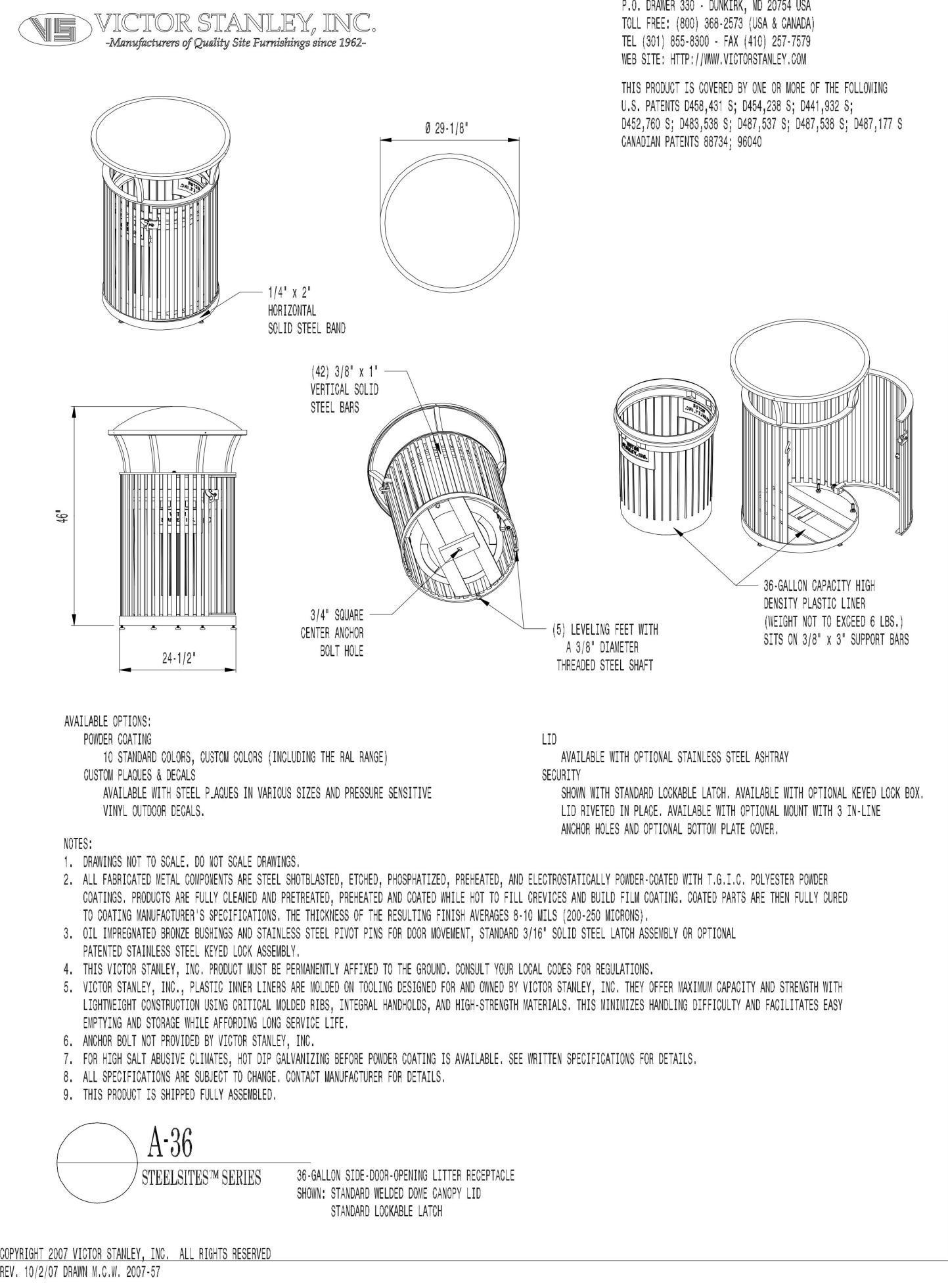

1 LITTER RECEPTACLE  
N.T.S. DETAIL

2 BENCH, IN GROUND MOUNT  
N.T.S. DETAIL

3 BENCH, SURFACE MOUNT  
N.T.S. DETAIL

spackman  
mossop  
michaels

1824 Sophie Wright Place  
New Orleans | LA | 70130  
T: 504.218.8991

LANDSCAPE ARCHITECT

FOR PERMIT ONLY



12/04/2020

GERNON BROWN RECREATION CENTER  
NEW PLAY STRUCTURE  
1001 HARRISON AVENUE  
NEW ORLEANS, LOUISIANA  
100% DESIGN DEVELOPMENT

STATUS		
100% DESIGN DEVELOPMENT	10/21/2020	
REVISION		
NO.	DESCRIPTION	DATE

SITE DETAILS	
DRAWING TITLE	
SMM	L901
DRAWN BY	
20022	
JOB NO.	DRAWING NO.

1

2

3

4

5

6

7

8

9

A

B

C

D

E

F

G

H

GENERAL LEGEND

	EXISTING BUILDINGS
	EXISTING TREES TO REMAIN AND BE PROTECTED
	EXISTING DRAIN INLETS
	EXISTING LIGHT POLES
	EXISTING CONTOURS
	EXISTING GAS LINE
	EXISTING WATER LINE
	EXISTING DRAIN LINE
	EXISTING FENCE LINE

**spackman  
mossop  
michaels**

1824 Sophie Wright Place  
New Orleans | LA | 70130  
T: 504.218.8991

LANDSCAPE ARCHITECT

STAMP DATE

**GERNON BROWN RECREATION  
CENTER NEW PLAY STRUCTURE**  
1001 HARRISON AVENUE  
NEW ORLEANS, LOUISIANA  
**100% DESIGN DEVELOPMENT**

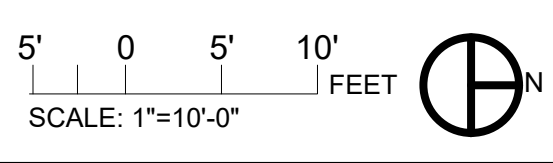

**STATUS**  
100% DESIGN DEVELOPMENT 10/21/2020

NO.	DESCRIPTION	DATE

**EXTERIOR:  
LIGHTING PLAN**

DRAWING TITLE

IHJ	<b>E1.0</b>
DRAWN BY	
20022	DRAWING NO.
JOB NO.	

- ELECTRICAL KEY NOTES:**
- ① REMOVE EXISTING LIGHT FIXTURE AND REPLACE WITH - CREE NTW A WM T3 1L 40K UL B2
  - ② REMOVE EXISTING LIGHT FIXTURE AND REPLACE WITH - CREE NTW A WM T3 1L 40K UL B2
  - ③ REMOVE EXISTING LIGHT FIXTURE AND REPLACE WITH - CREE NTF A NM N6 10L 40K UL B2
  - ④ REMOVE EXISTING LIGHT FIXTURE AND REPLACE WITH - CREE NTA A NM T4\* 11L 40K UL B2

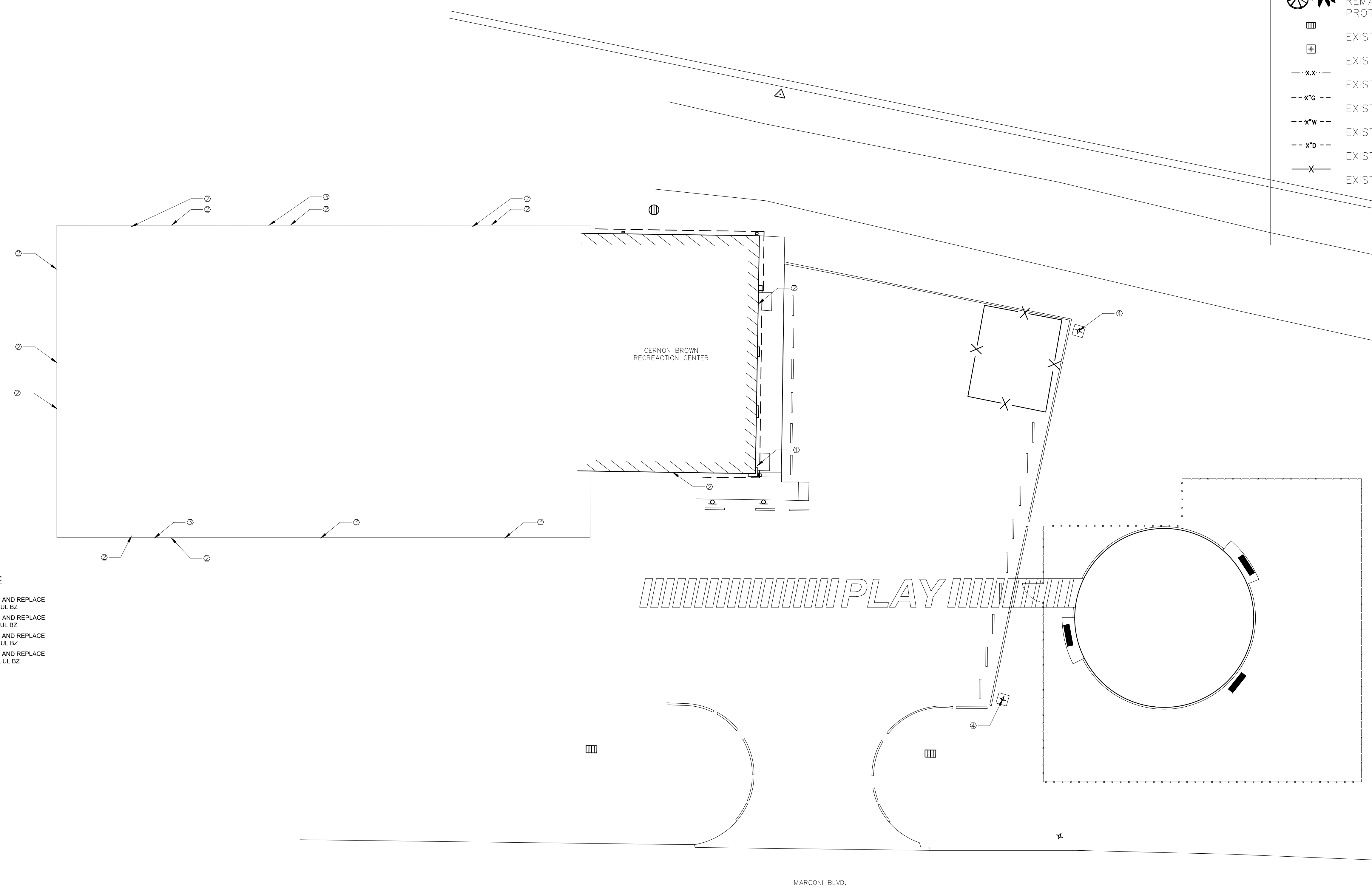

**1** EXTERIOR LIGHTING  
Scale: NONE

Plan

**pivotal**  
engineering  
A Full Service MEP, Civil and Environmental Firm  
1515 PONDRAIS STREET, STE. 1875  
NEW ORLEANS, LA. 70112  
(504) 799-3653 (504) 799-3654(FAX)

1

2

3

4

5

6

7

8

9



# Noctura Series

LED Area Luminaires

Rev. Date: V5 03/10/2020

## Product Description

The Noctura® LED Area luminaire minimizes cost of ownership with easy installation, high performance and quality backed by a Cree Lighting 5-year limited warranty. The Noctura Series has a coordinated style across area, flood and wall mount luminaires to provide a consistent daytime appearance across a building site or campus. Versatile mounting configurations offer installation flexibility and ease of application for direct pole, tenon or vertical flat surface mounting.

**Applications:** Ideal for both retrofit and new installation: parking area, security, or site pathway applications.

## Performance Summary

**Lumen Output:** Up to 35,600 lumens

**Efficacy:** Up to 155 LPW

**CRI:** Minimum 70 CRI

**CCT:** 4000K, 5000K

**Limited Warranty\*:** 5 years on luminaire, mounts, backlight shields, bird spikes and cables/1 year on photocells and shorting cap

\* See <http://creelighting.com/warranty> for warranty terms

## Accessories

Field-Installed		
<b>Backlight Shield</b> NTA-BLSF-11L - For use with 11L only NTA-BLSF-19L - For use with 19L only NTA-BLSF-35L - For use with 35L only	<b>Bird Spikes</b> NTA-BRDSPK-19L - For use with 19L only NTA-BRDSPK-35L - For use with 35L only <b>Button Photocell</b> C-ACC-A-PCCELL-LV - For use with 120V only C-ACC-A-PCCELL-HV - For use with 208-277V only	<b>Cable</b> NTX-QC-5 (120-277 Volt only) NTX-QC-5-U (120-480 Volt) - 5' (1.5m) cable replacement <b>Shorting Cap</b> XA-XSLSHRT <b>NEMA 3-Pin Photocell</b> C-ACC-A-PCCELL-NEMA3-LV - UL (120-277V) Voltage only

## Ordering Information

Fully assembled luminaire is composed of two components that must be ordered separately:

Example: **Mount:** NTA-DA-BZ + **Luminaire:** NTA-A-NM-T3-11L-40K-UL-BZ

Mount (Luminaire must be ordered separately)*		
<b>Direct Arm Mounts</b> NTA-DA-BZ (120-277 Volt only) NTA-DA-BZ-U (120-480 Volt) - Direct Arm Mount NTX-3R-BZ (120-277 Volt only) NTX-3R-BZ-U (120-480 Volt) - Extended Arm includes a NEMA® 3-Pin Photocell Receptacle and a knockout for an Occupancy Sensor - Must be used with NTA-DA-BZ or NTA-DA-BZ-U mounts	<b>Adjustable Arm Mounts</b> NTX-AA-BZ (120-277 Volt only) NTX-AA-BZ-U (120-480 Volt) - Adjustable Arm Mount w/ knockout for Field-Installed Button Photocell (by others) NTX-AA-3R-BZ (120-277 Volt only) NTX-AA-3R-BZ-U (120-480 Volt) - Adjustable Arm Mount w/NEMA® 3-Pin Photocell Receptacle NTX-3R-BZ (120-277 Volt only) NTX-3R-BZ-U (120-480 Volt) - Extended Arm includes a NEMA® 3-Pin Photocell Receptacle and a knockout for an Occupancy Sensor (by others) - Must be used with NTX-AA-BZ or NTX-AA-BZ-U mounts	<b>Trunnion Mounts</b> NTX-TR-BZ (120-277 Volt only) NTX-TR-BZ-U (120-480 Volt) - Trunnion Mount NTX-TR-3R-BZ (120-277 Volt only) NTX-TR-3R-BZ-U (120-480 Volt) - Trunnion Mount w/NEMA® 3-Pin Photocell Receptacle NTX-TR-PK-BZ (120-277 Volt only) NTX-TR-PK-BZ-U (120-480 Volt) - Trunnion Mount w/knockout for Field-Installed Button Photocell (by others) NTX-3R-BZ (120-277 Volt only) NTX-3R-BZ-U (120-480 Volt) - Extended Arm includes a NEMA® 3-Pin Photocell Receptacle and a knockout for an Occupancy Sensor (by others) - Must be used with NTX-TR-BZ or NTX-TR-BZ-U mounts

**Note:** NEMA® 3-Pin Photocell Receptacle requires photocell or shorting cap by others

## 11L Direct Mount (NTA-DA-BZ or NTA-DA-BZ-U)

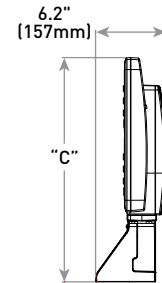
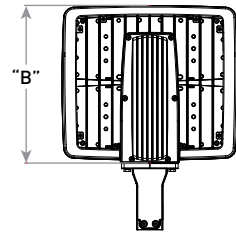
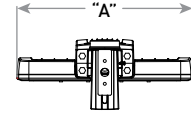

Lumen Package	Weight**	Dim "A"	Dim "B"	Dim "C"
11L*	12.5 lbs. (5.7kg)	10.6" (269mm)	12.9" (328mm)	18.7" (476mm)
19L*	16.0 lbs. (7.3kg)	15.4" (391mm)	13.8" (351mm)	19.6" (499mm)
35L*	21.1 lbs. (9.6kg)	15.4" (391mm)	19.8" (502mm)	25.6" (650mm)

\* See pages 3-5 for additional line drawings

\*\* Includes housing & mount (for housing weight only refer to page 2)

NTA	A	NM					BZ
Product	Version	Mounting	Optic	Lumen Package**	CCT	Voltage	Color Options
NTA	A	NM No Mount	T3* Type III Medium T4* Type IV Medium T5 Type V Medium	11L 11,000 lumens 19L 19,000 lumens 35L 35,000 lumens	40K 4000K 50K 5000K	UL Universal 120-277V UH Universal 347-480V	BZ Bronze

\* Available with Backlight Shield when ordered with field-installed accessory (see table above)

\*\* Lumen Package codes identify approximate light output only. Actual lumen output levels may vary depending on CCT and optic selection. Refer to Initial Delivered Lumen tables for specific lumen values



US: [creelighting.com](http://creelighting.com) (800) 236-6800

Canada: [creelighting-canada.com](http://creelighting-canada.com) (800) 473-1234

# Noctura™ Series - Luminaires & Accessories



Noctura™ Area



Noctura™ Flood



Noctura™ Wall Mount



Noctura™ Accessories

Platt Item #	Cat #	Description	Replaces
--------------	-------	-------------	----------

## NOCTURA™ SERIES - AREA

1434325	NTA-A-NM-T3-11L-40K-UL-BZ	NOCTURA, AREA, T3, 11L, 75W, 40K, 120-277	250W MH / HPS / PSMH
1434327	NTA-A-NM-T5-11L-40K-UL-BZ	NOCTURA, AREA, T5, 11L, 75W, 40K, 120-277	250W MH / HPS / PSMH
1434326	NTA-A-NM-T3-19L-40K-UL-BZ	NOCTURA, AREA, T3, 19L, 130W, 40K, 120-277	400W MH / HPS / PSMH
1434328	NTA-A-NM-T5-19L-40K-UL-BZ	NOCTURA, AREA, T5, 19L, 130W, 40K, 120-277	400W MH / HPS / PSMH

## NOCTURA™ SERIES - FLOOD

1434317	NTF-A-NM-N4-3L-40K-UL-BZ	NOCTURA, FLOOD, N4, 3L, 21W, 40K, 120-277	70W MH / 100W HPS / PSMH
1434320	NTF-A-NM-N6-3L-40K-UL-BZ	NOCTURA, FLOOD, N6, 3L, 21W, 40K, 120-277	70W MH / 100W HPS / PSMH
1434321	NTF-A-NM-N4-10L-40K-UL-BZ	NOCTURA, FLOOD, N4, 10L, 64W, 40K, 120-277	250W MH / PSMH / 200W HPS
1434322	NTF-A-NM-N6-10L-40K-UL-BZ	NOCTURA, FLOOD, N6, 10L, 64W, 40K, 120-277	250W MH / PSMH / 200W HPS
1434323	NTF-A-NM-N4-21L-40K-UL-BZ	NOCTURA, FLOOD, N4, 21L, 140W, 40K, 120-277	400W PSMH / HPS
1434324	NTF-A-NM-N6-21L-40K-UL-BZ	NOCTURA, FLOOD, N6, 21L, 140W, 40K, 120-277	400W PSMH / HPS

## NOCTURA™ SERIES - WALL MOUNT

1434247	NTW-A-WM-T3-3L-50K-UL-BZ	NOCTURA, WALL, 3L, 24W, 50K, 120-277, BZ	100W MH / HPS / PSMH
1434249	NTW-A-WM-T3-7L-40K-UL-BZ	NOCTURA, WALL, 7L, 46W, 40K, 120-277, BZ	150W MH / HPS / PSMH
1434251	NTW-A-WM-T3-11L-40K-UL-BZ	NOCTURA, WALL, 11L, 74W, 40K, 120-277, BZ	250W MH / HPS / PSMH
1434253	NTW-A-WM-T3-17L-40K-UL-BZ	NOCTURA, WALL, 17L, 111W, 40K, 120-277, BZ	400W MH

## NOCTURA™ SERIES - ACCESSORIES

1434330	NTA-DA-BZ	NOCTURA DIRECT ARM, 120-277	
1434331	NTF-KN-BZ	NOCTURA SMALL FLOOD KNUCKLE	
1434332	NTF-YM-3L-BZ	NOCTURA SMALL FLOOD 3L YOKE	
1434333	NTF-YM-10L-BZ	NOCTURA SMALL FLOOD 10L YOKE	
1434334	NTX-AA-BZ	NOCTURA ADJUSTABLE ARM, 120-277	
1434335	NTX-TR-BZ	NOCTURA TRUNNION, 120-277	
1434337	NTX-TR-3R-BZ	NOCTURA TRUNNION WITH 3-PIN NEMA RECEPTACLE, 120-277	
1434338	NTX-3R-BZ	NOCTURA EXTENSION ARM WITH 3-PIN NEMA RECEPTACLE, 120-277	

Visit [creelighting.com](http://creelighting.com) or contact a Cree Lighting representative to learn more.

[info@creelighting.com](mailto:info@creelighting.com) | 800.236.6800

© 2019 Cree Lighting, A company of IDEAL Industries. All rights reserved. For informational purposes only. Not a warranty or specification. See [creelighting.com](http://creelighting.com) for specifications. Cree®, and the Cree logo are registered trademarks of Cree, Inc. Noctura™ is a trademark of Cree Lighting, A company of IDEALINDUSTRIES. NEMA® is a registered trademark of the National Electrical Manufacturers Association. CAT/CSJ-C042 Rev. Date 06/27/19