









-  Proposed Building Demolition Area
-  Proposed Overhead Building Demolition Area
-  Proposed Site Demolition Area
-  Proposed Temporary Building Closure Wall
-  Proposed Demolition Phase Screen Fence
-  Footprint of Proposed Hotel

DEMOLITION PACKAGE - LEVEL ONE PLAN

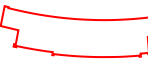
← EXISTING CASINO TO REMAIN UNLESS NOTED OTHERWISE →





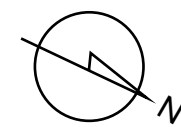

-  Proposed Building Demolition Area
-  Proposed Overhead Building Demolition Area
-  Proposed Temporary Closure Wall
-  Footprint of Proposed Hotel

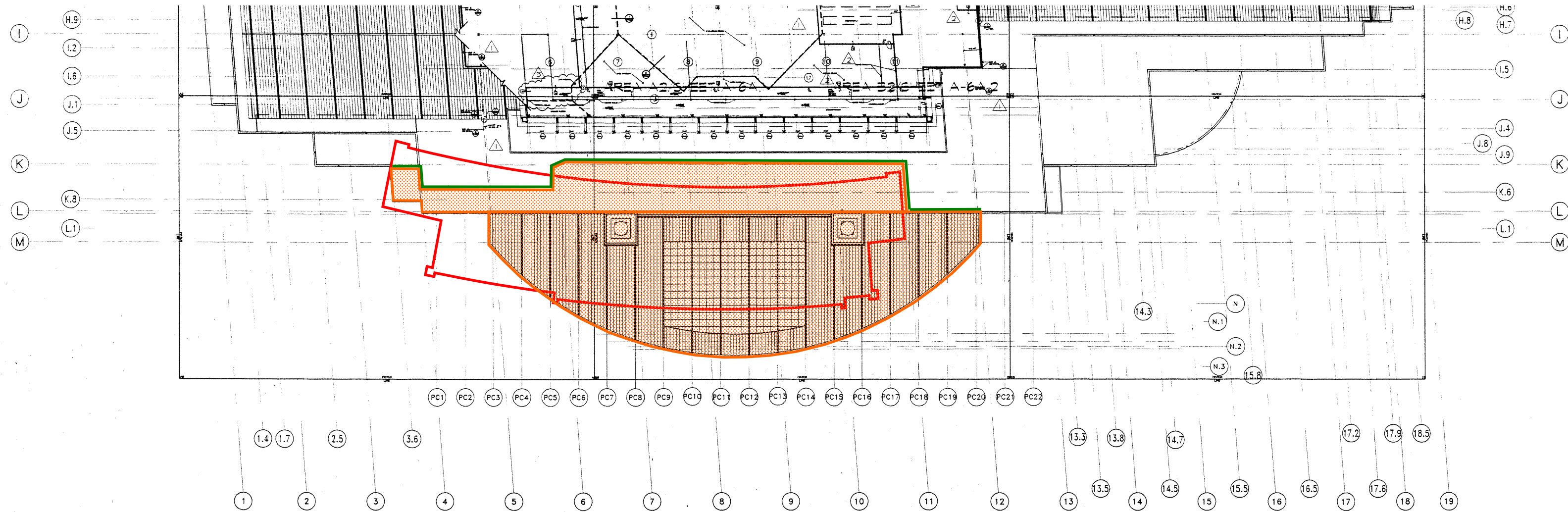

DEMOLITION PACKAGE - LEVEL TWO PLAN

← EXISTING CASINO TO REMAIN UNLESS NOTED OTHERWISE →



-  Proposed Building Demolition Area
-  Proposed Temporary Closure Wall Parapet and Roofing Tie-in
-  Footprint of Proposed Hotel

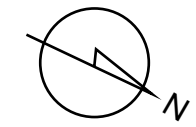

DEMOLITION PACKAGE - MECHANICAL LEVEL & PORTE COCHERE ROOF PLAN

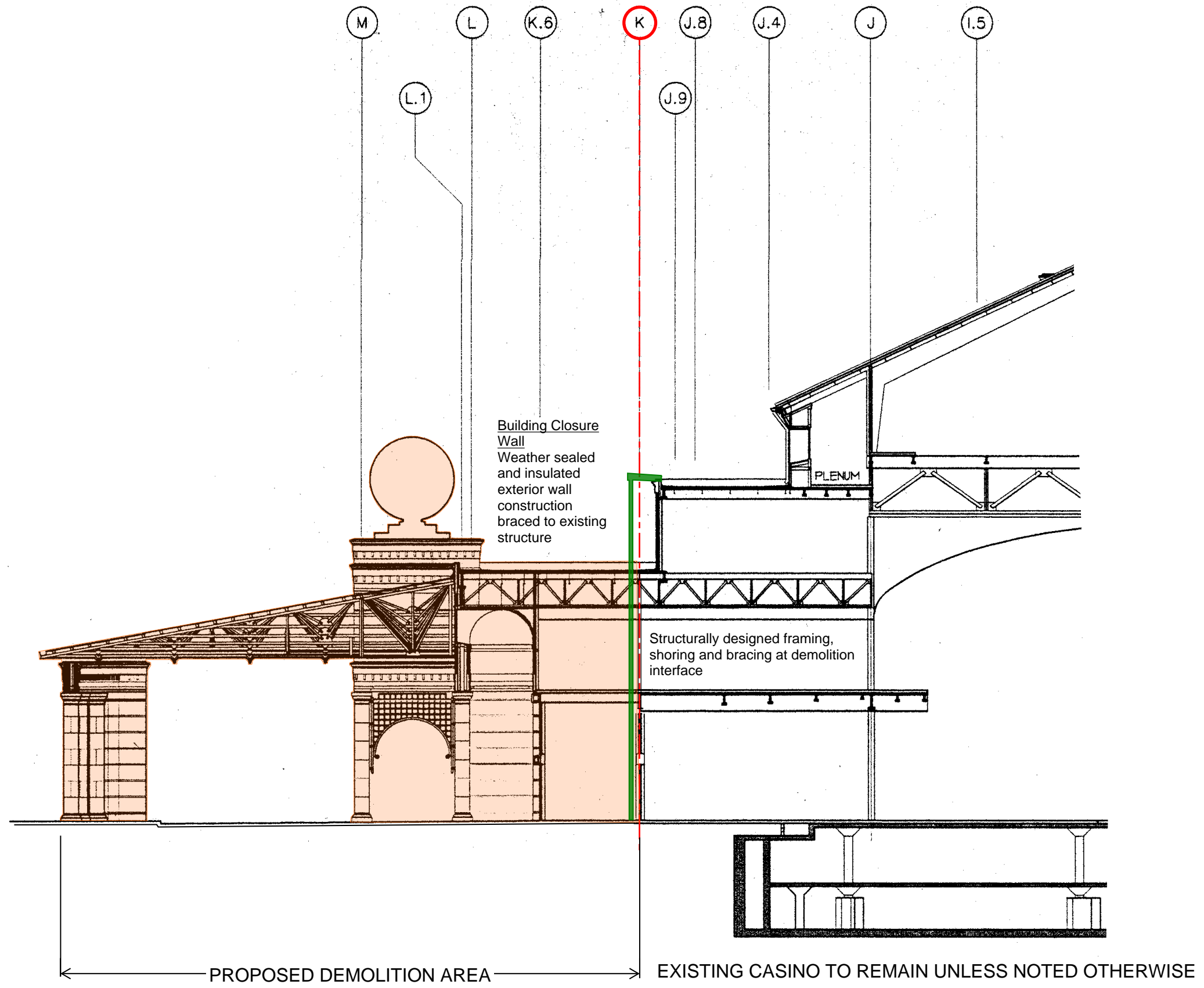

DEMOLITION PACKAGE - SECTION AT DEMOLITION AREA

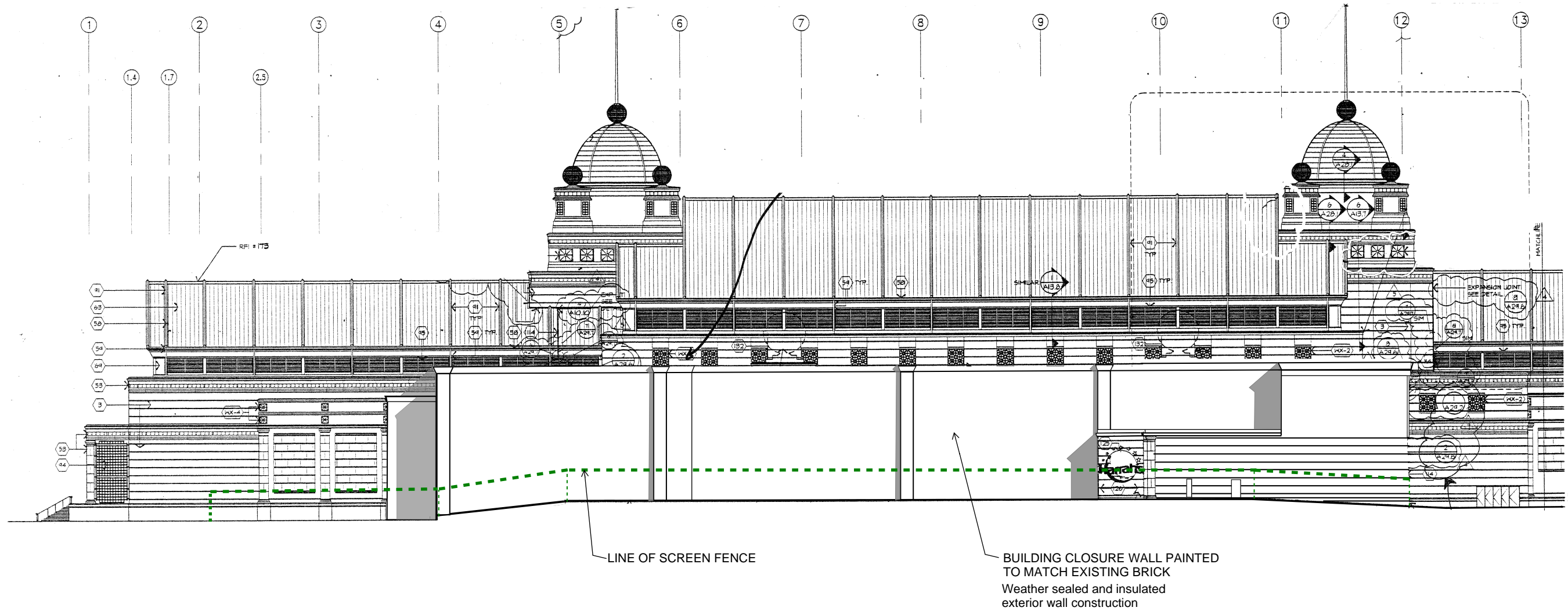

Screen Fence
Opaque exterior grade panels - paint finish with graphics wrap - set above site traffic barriers

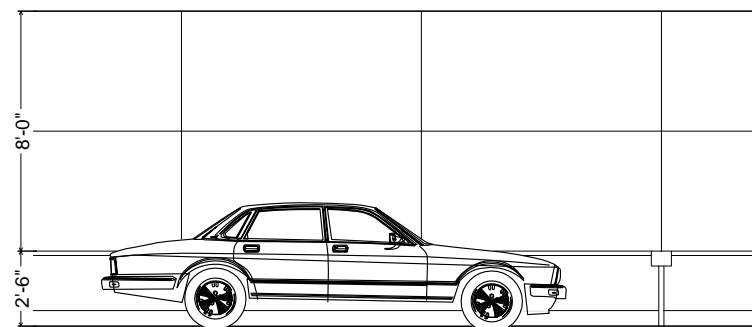

SCREEN FENCE ELEVATION

DEMOLITION PACKAGE - BUILDING CLOSURE WALL ELEVATION



EXISTING CASINO TO
REMAIN UNLESS NOTED
OTHERWISE

NEW TEMPORARY
MODULAR
STRUCTURE
PORTE COCHERE

EXISTING PORTE COCHERE TO BE
REMOVED FOR PROPOSED NEW
HOTEL TOWER

CASINO VIEW FROM POYDRAS AND CONVENTION CENTER BLVD
TEMPORARY DROP OFF / PORTE COCHERE

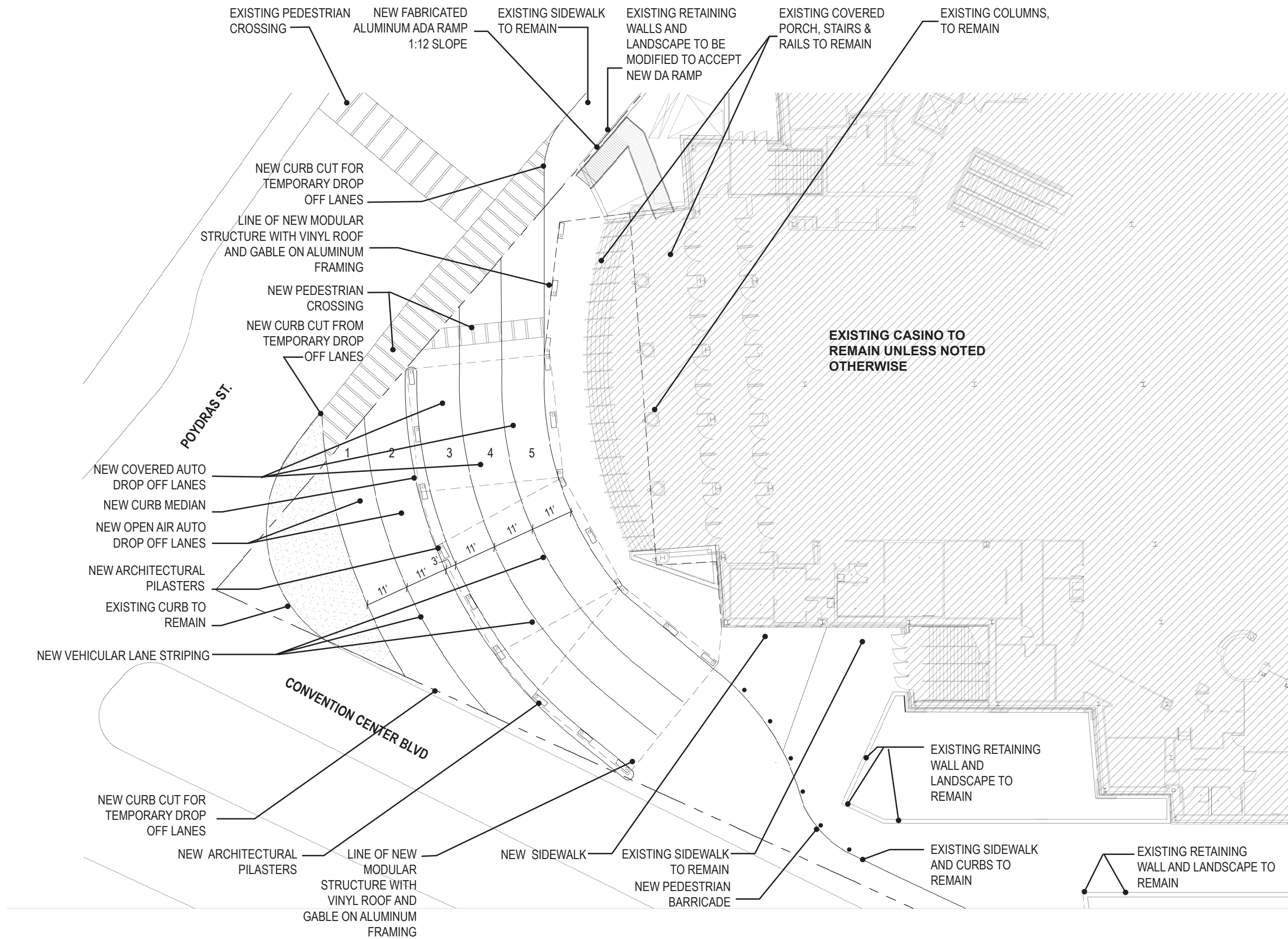

PROPOSED SITE PLAN ↻

TEMPORARY DROP OFF

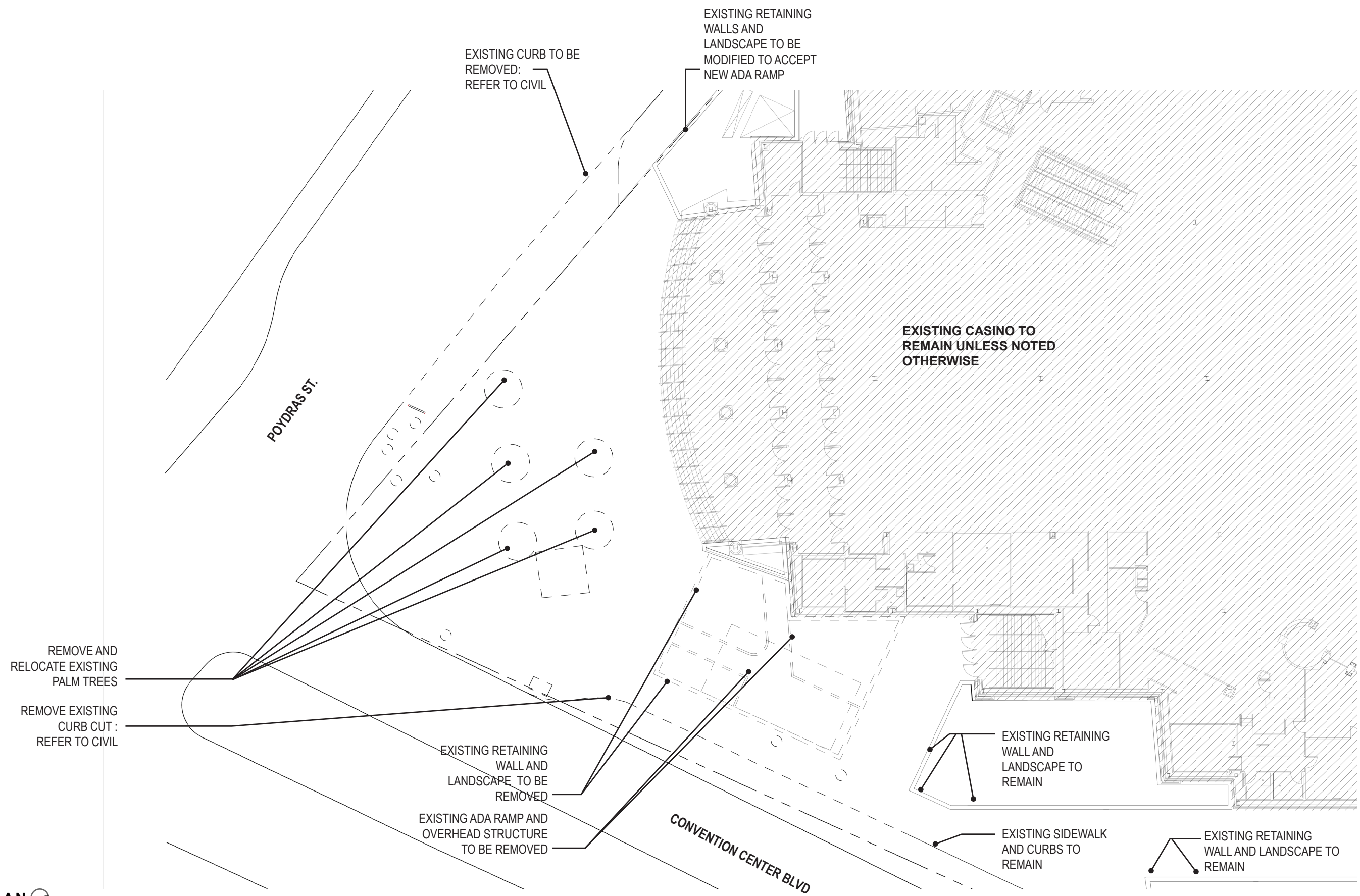

PROPOSED DEMOLITION PLAN ↻

TEMPORARY DROP OFF

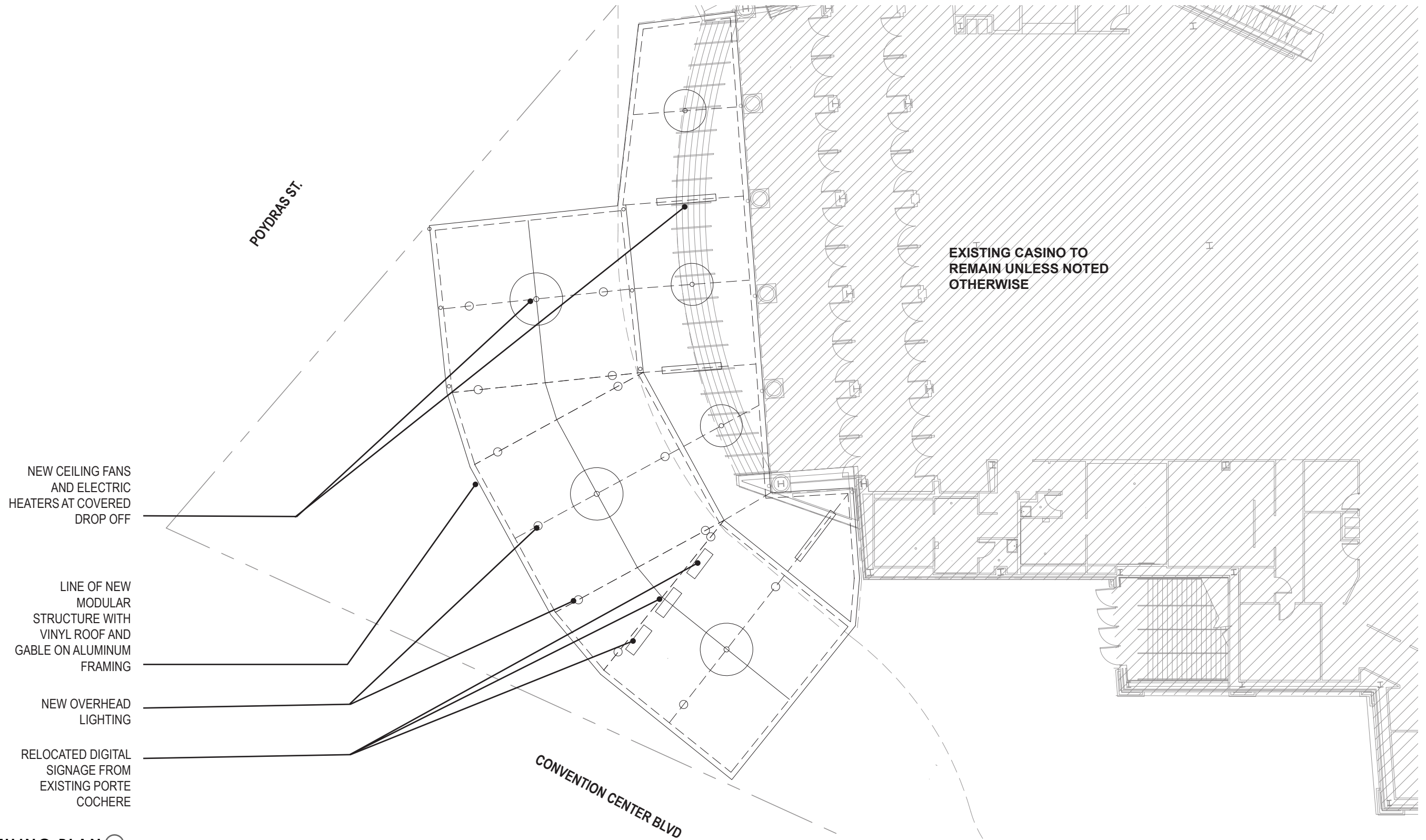

PROPOSED REFLECTIVE CEILING PLAN ↻

TEMPORARY DROP OFF



TEMPORARY DROP OFF / PORTE COCHERE



EXISTING BUILDING
FACADE TO REMAIN
UNLESS NOTED
OTHERWISE

NEW CEMENT BOARD
HEADER AND TRIM:
PAINTED

NEW ACCESSIBLE ADA
RAMP

NEW DECORATIVE
LIGHTING

EXISTING STAIRS AND
RAILS TO REMAIN

NEW CEMENT BOARD
PILASTER, TRIM AND
BASE: PAINTED

NEW PEDESTRIAN
PATH

NEW ELECTRIC HEATERS AND
CEILING FANS IN COVERED DROP
OFF

NEW MODULAR
STRUCTURE WITH
VINYL GABLE ROOF
ON ALUMINUM
FRAMING

NEW CEMENT
BOARD HEADER &
TRIM WITH
INTEGRAL GUTTER:
PAINTED

NEW CEMENT
BOARD
PILASTER, TRIM
AND BASE:
PAINTED

NEW DECORATIVE
LIGHTING

TEMPORARY DROP OFF / PORTE COCHERE

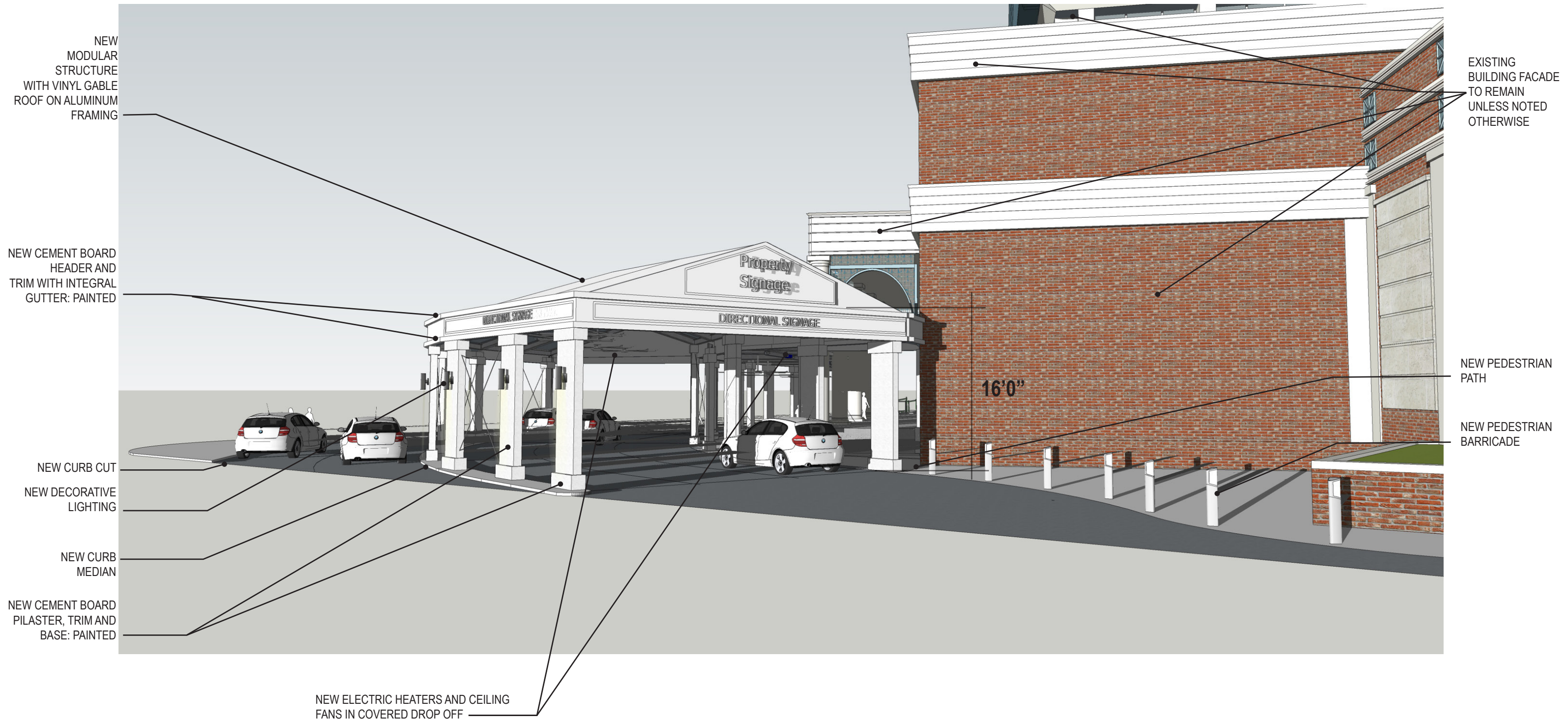

TEMPORARY DROP OFF / PORTE COCHERE

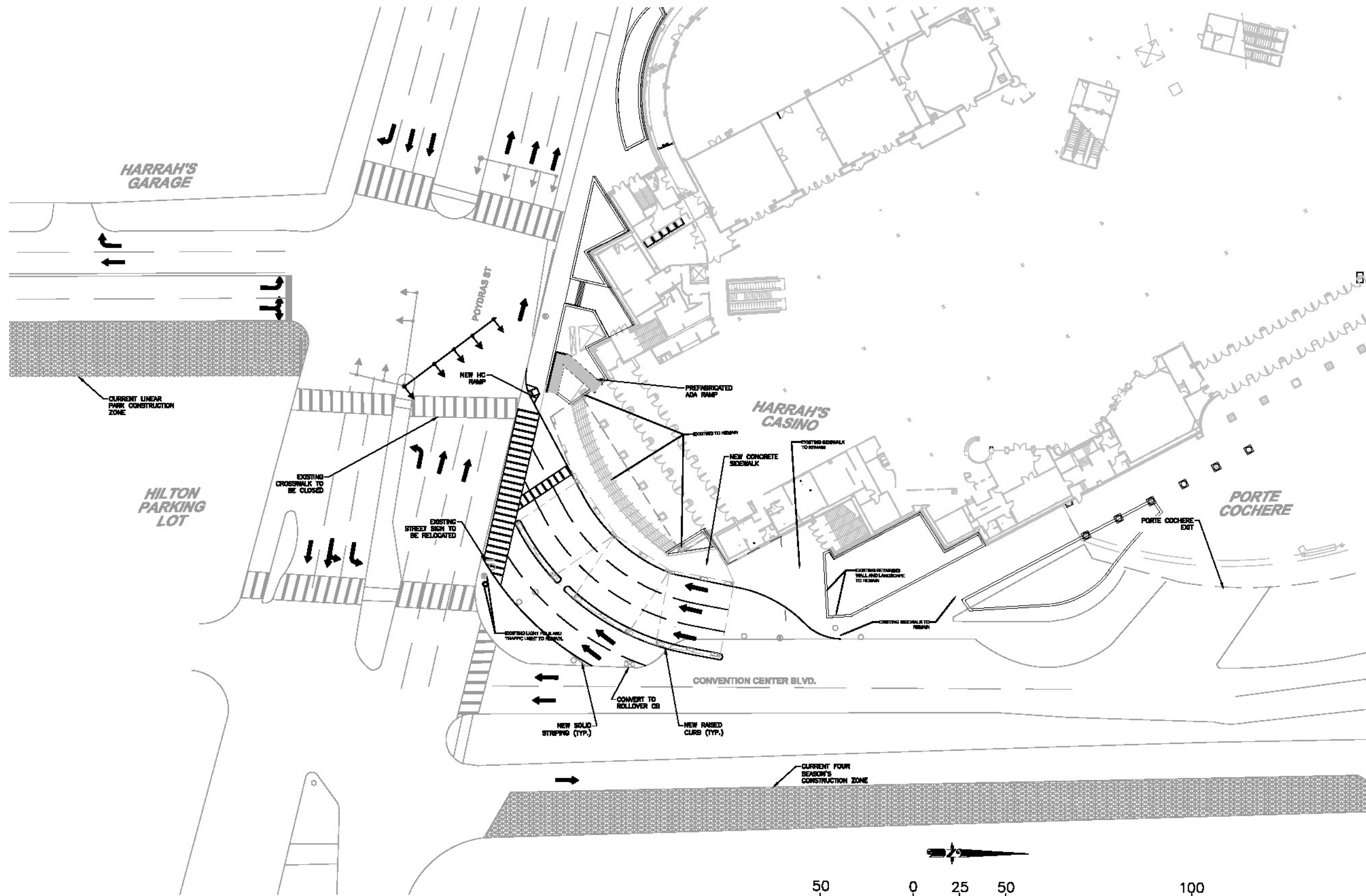

LEGEND	
	EXISTING CROSSWALK
	NEW CROSSWALK
	AVG. SEDAN (8.25' X 14.7')
	AVG. PICKUP (6.67' X 17')
	RIDE SHARE OR TAXI
	BARRICADE
	TRAFFIC DELINEATOR
	EXISTING TRAFFIC LIGHT
	EXISTING UTILITY COVER
	EXISTING LIGHT POLE
	EXISTING CATCH BASIN
	EXISTING PALM TREE

- NOTES:**
- EXISTING HANDICAPPED RAMP, PALM TREES AND MISC. ADVERTISING STRUCTURE ARE TO BE REMOVED.
 - VEHICLES ARE TO BE RAMPED UP ON TO EXISTING PAVERS VIA NEW ASPHALT RAMPS.
 - STRIPING TO BE USED TO GUIDE VEHICLES.
 - CONVENTION CENTER BLVD ON THE SOUTH SIDE OF POYDRAS ST IS SHOWN AS THE SOON TO BE COMPLETED NEW ROADWAY VIA THE LINEAR PARK PROJECT

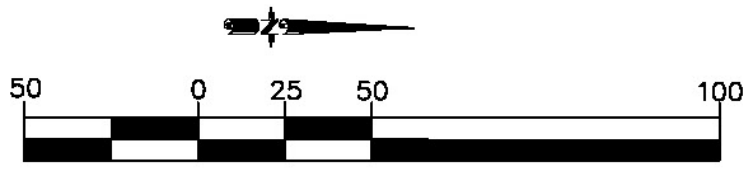

SCALE: 1" = 50'

TEMPORARY PORTE COCHERE_OPTION 1 (SIGNALIZED)

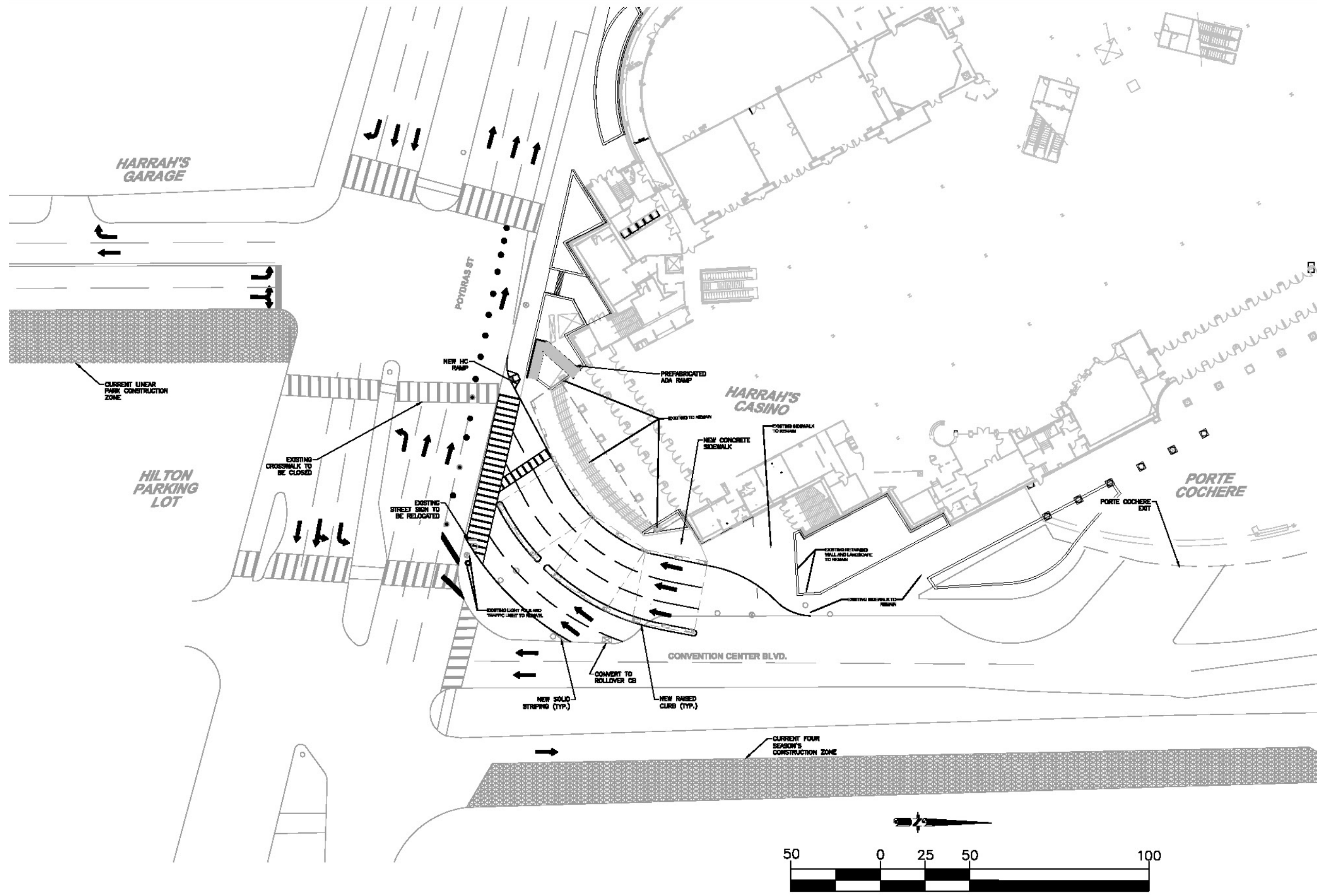

LEGEND

	EXISTING CROSSWALK
	NEW CROSSWALK
	AVG. SEDAN (8.25' X 14.7')
	AVG. PICKUP (6.67' X 17')
	RIDE SHARE OR TAXI
	BARRICADE
	TRAFFIC DELINEATOR
	EXISTING TRAFFIC LIGHT
	EXISTING UTILITY COVER
	EXISTING LIGHT POLE
	EXISTING CATCH BASIN
	EXISTING PALM TREE

- NOTES:**
- EXISTING HANDICAPPED RAMP, PALM TREES AND MISC. ADVERTISING STRUCTURE ARE TO BE REMOVED.
 - VEHICLES ARE TO BE RAMPED UP ON TO EXISTING PAVERS VIA NEW ASPHALT RAMPS.
 - STRIPING TO BE USED TO GUIDE VEHICLES.
 - VEHICLES EXITING THE DROP OFF AREA MAY NEED TO BE CONTROLLED BY THE TRAFFIC LIGHT ON POYDRAS IN ORDER TO ALLOW PEDESTRIANS TO USE THE EXISTING CROSSWALK.
 - TRAFFIC BARRIERS AND DELINEATORS WILL BE USED IN ORDER TO ALLOW VEHICLES TO EXIT ON TO POYDRAS WITHOUT CONFLICTING WITH OTHER TRAFFIC MOVEMENTS.
 - CONVENTION CENTER BLVD ON THE SOUTH SIDE OF POYDRAS ST IS SHOWN AS THE SOON TO BE COMPLETED NEW ROADWAY VIA THE LINEAR PARK PROJECT

TEMPORARY PORTE COCHERE_OPTION 2 (TRAFFIC BARRIERS)