

INDEX TO SHEETS

SHEET NO.	TITLE
G-1	TITLE SHEET
C-1	PROPOSED SITE PLAN
# 2	TOTAL SHEETS

SCOPE OF WORK:

1. PATCH REPAIR TO CONCRETE COLUMN WITH EXPOSED REBAR
2. REMOVAL OF EXTENSIVE DAMAGE CONCRETE AND REPLACEMENT
3. INSTALLATION OF AGGREGATE SURFACE AND TRUEGRID SURFACE
4. TEMPORARY LIGHTING AND GENERATOR
5. TEMPORARY LAYOUT OF BARRIER CURBS
6. CLEANING AND LANDSCAPING WORKS
7. PAVEMENT STRIPPING
8. INSTALLATION OF TEMPORARY FENCING

CITY OF NEW ORLEANS
STATE OF LOUISIANA
CAPITAL PROJECTS ADMINISTRATION
EARHART BLVD. FOOD TRUCK
PLAZA FOR SUPER BOWL 2025
2739 EARHART BLVD.,
NEW ORLEANS, LA 70113

PREPARED BY:
PIVOTAL ENGINEERING, L.L.C.
1515 POYDRAS ST, STE. 1150, NEW ORLEANS, LA 70112
P: 504.799.3653 F: 504.799.3654

PROJECT NO.	SHEET NO.
TASK 30	G-1 OF 2

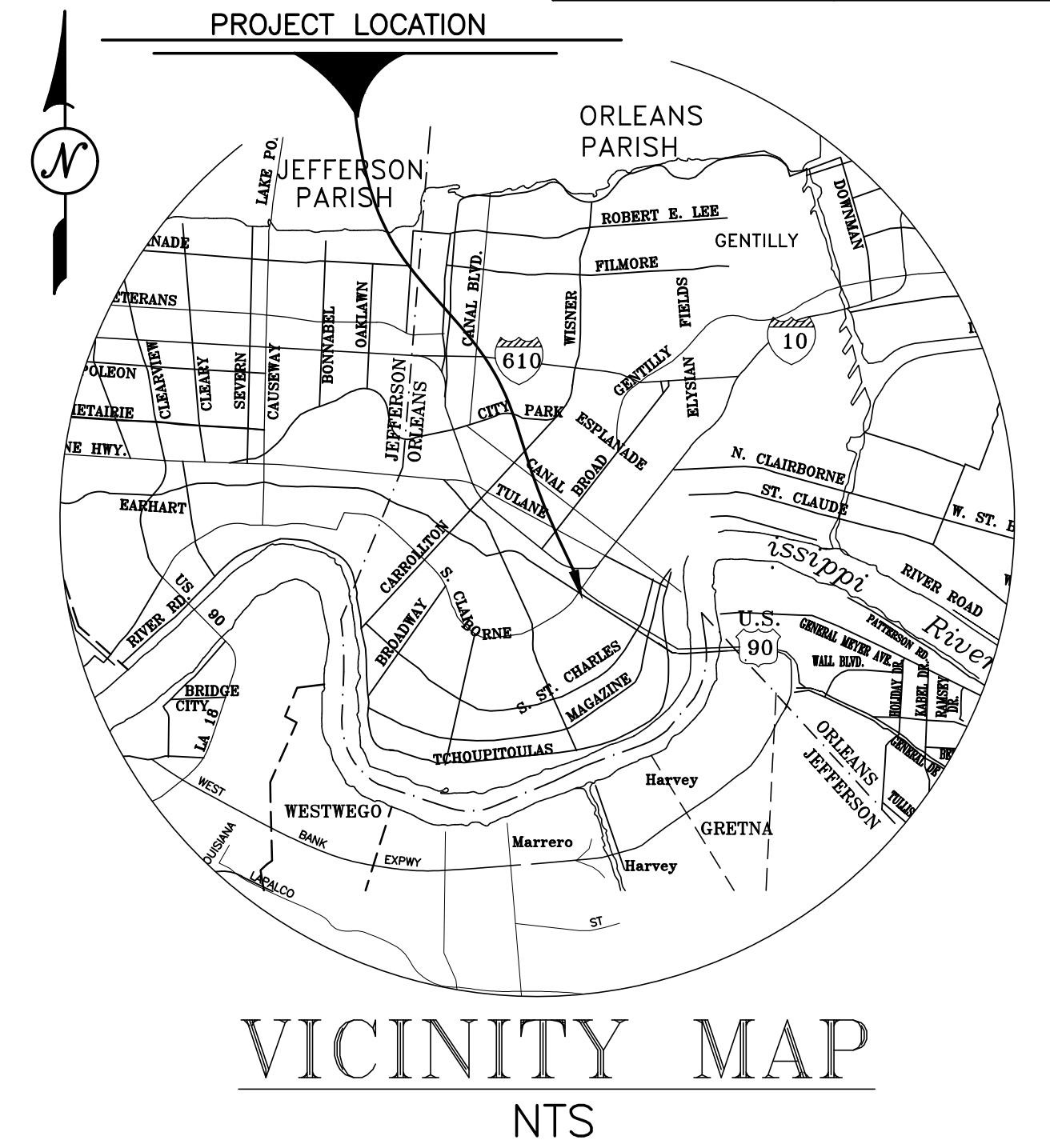

SCHEDULE OF REVISIONS

DATE	REVISION	DATE	REVISION	DATE	REVISION

TYPE OF CONSTRUCTION:

PAVEMENT REPAIR AND INSTALLATION, AGGREGATE SURFACING, TEMPORARY FENCE, MISCELLANEOUS CLEANING AND LIGHTING WORK, LANDSCAPING WORKS

PROJECT LIMITS

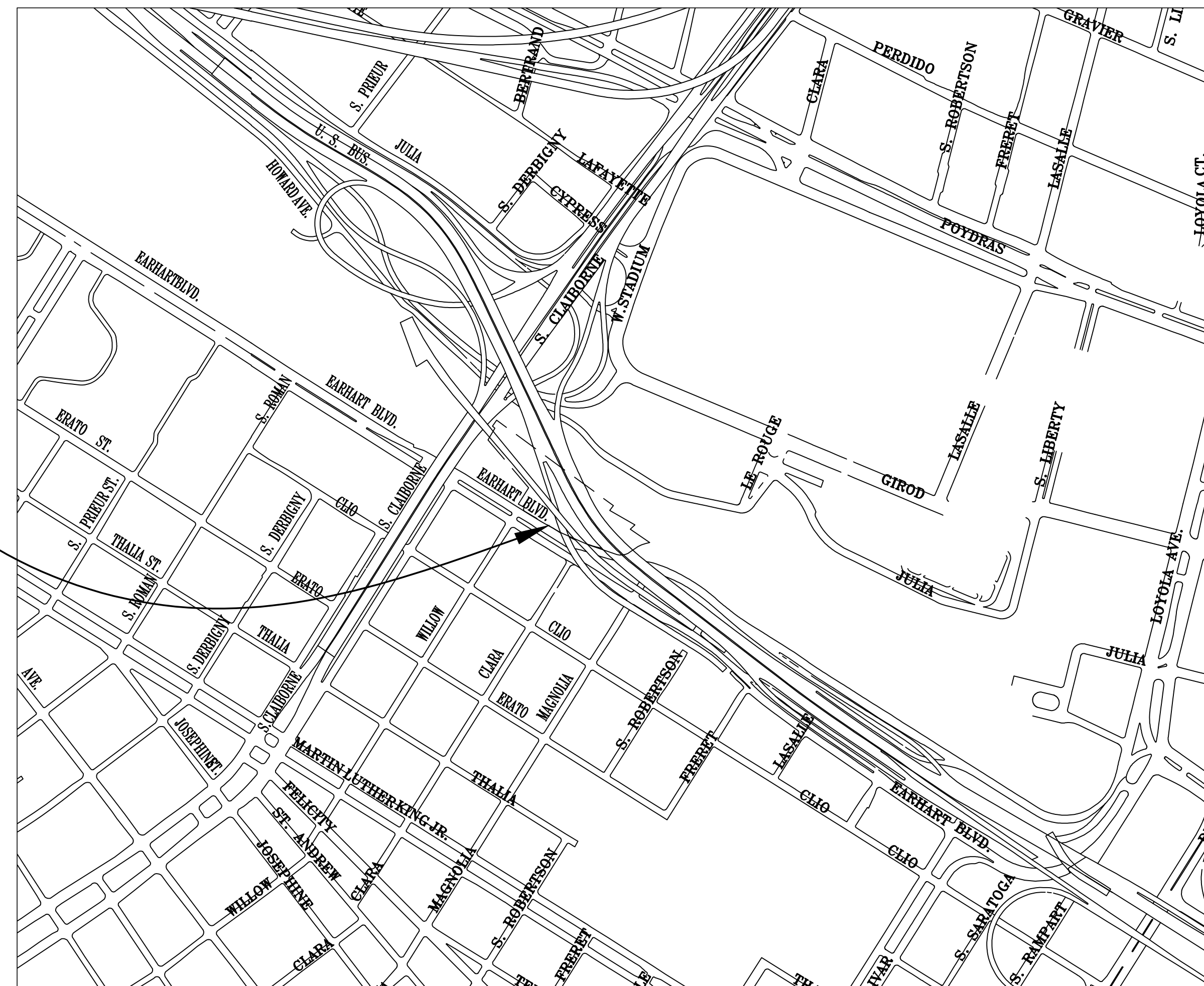

LAYOUT MAP

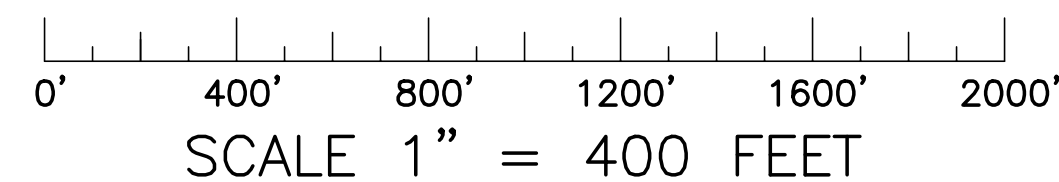

PLANS PREPARED BY
AND RECOMMENDED FOR APPROVAL:

DATE:

PIVOTAL ENGINEERING, LLC.

RECOMMENDED BY:

DATE:

CAPITAL PROJECTS ADMINISTRATION

PRELIMINARY PLANS

NOT TO BE USED FOR BIDDING, CONSTRUCTION, RECONSTRUCTION, CONVEYANCE, SALES OR AS THE BASIS FOR THE ISSUANCE OF A PERMIT
PREPARED UNDER THE SUPERVISION OF
YOSEPH SHIFARE, PE, FTOE
LOUISIANA P.E. LIC. NO. 42747
PIVOTAL ENGINEERING, LLC

* REVIEW AND APPROVAL OF THESE PLANS AND SPECIFICATIONS BY THE CITY OF NEW ORLEANS IS FOR THE GENERAL CONFORMANCE TO THE PROJECT REQUIREMENTS ONLY AND DOES NOT RELIEVE THE ENGINEERS OF THEIR RESPONSIBILITY FOR THE RELEVANCE AND ACCURACY OF ALL ITEMS AND DETAILS INCLUDED IN THESE PLANS AND SPECIFICATIONS.

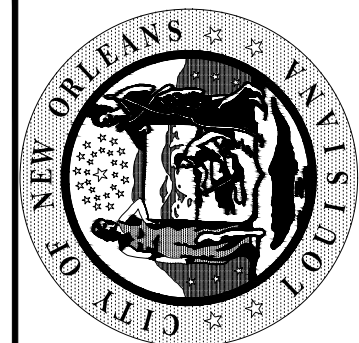
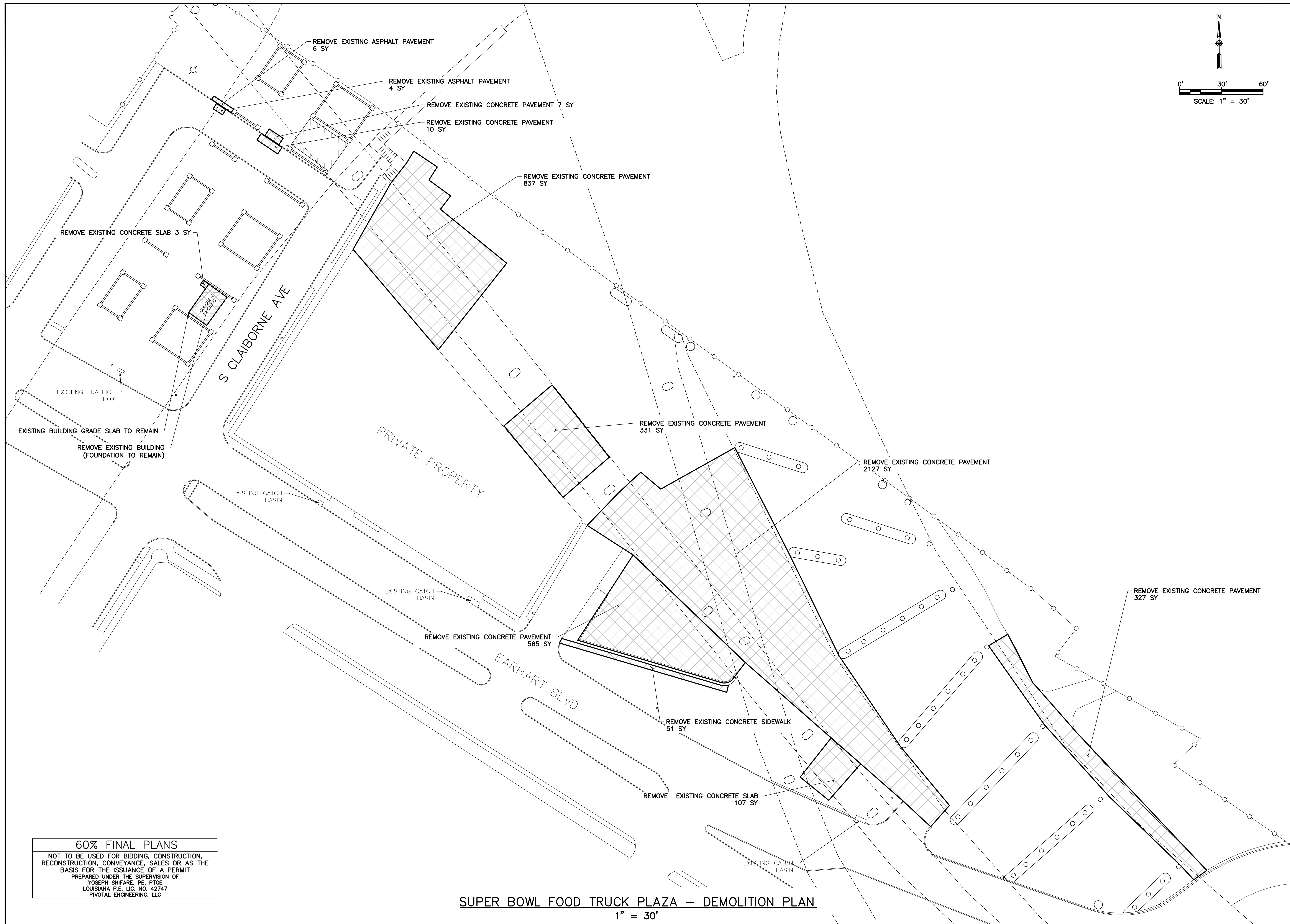

DEPARTMENT OF
CAPITAL PROJECTS
1601 PERDIDO ST
NEW ORLEANS, LA 70112

PIVOTAL ENGINEERING
CIVIL, ELECTRICAL, ENVIRONMENTAL
& MECHANICAL ENGINEERING
1515 POYDRAS STREET, STE. 1150
NEW ORLEANS, LA. 70112
504.799.3653 504.799.3654 FAX

THESE DRAWINGS HAVE BEEN PREPARED BY THE ENGINEER OR ARCHITECT AND TO THE BEST OF MY KNOWLEDGE AND BELIEF THEY COMPLY WITH ALL LOCAL AND STATE REQUIREMENTS AND I AM NOT PROVIDING CONSTRUCTION SUPERVISION. MY FEE SHALL BE PREDEFINED BY OUR OFFICE.
Joseph Shifare
REGISTERED PROFESSIONAL ENGINEER
07/03/24 42747
DATE

EARHART BLVD. FOOD TRUCK PLAZA
2739 EARHART BLVD, NEW ORLEANS, LA 70113

revisions	
no.	date & description
1	
2	
3	
4	

job number Task 30
drawn by E.G. P.S., T.G.
checked by Y.S.
date 07-12-2024
phase 60% FIANTL PLAN

DEMOLITION PLAN

drawing number
C-2

60% FINAL PLANS
NOT TO BE USED FOR BIDDING, CONSTRUCTION, RECONSTRUCTION, CONVEYANCE, SALES OR AS THE BASIS FOR THE ISSUANCE OF A PERMIT PREPARED UNDER THE SUPERVISION OF
YOSEPH SHIFARE, PE, PTOE
LOUISIANA P.E. LIC. NO. 42747
PIVOTAL ENGINEERING, LLC

SUPER BOWL FOOD TRUCK PLAZA – DEMOLITION PLAN
1" = 30'

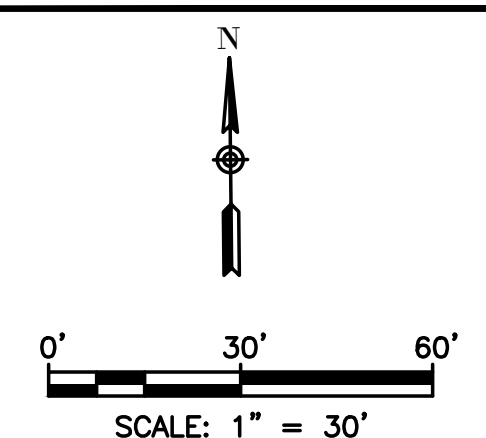
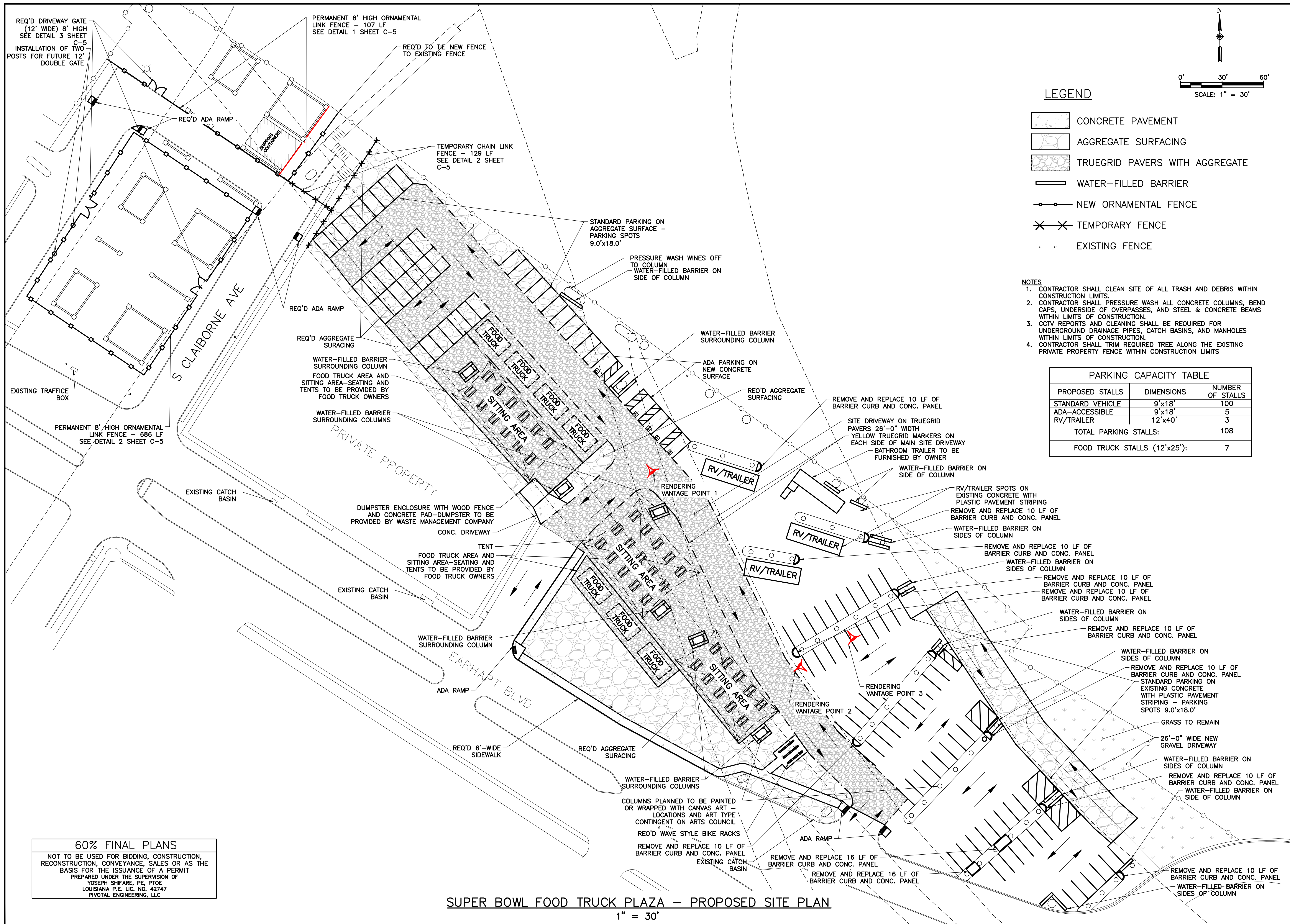

LEGEND

- CONCRETE PAVEMENT
- AGGREGATE SURFACING
- TRUEGRID PAVERS WITH AGGREGATE
- WATER-FILLED BARRIER
- NEW ORNAMENTAL FENCE
- TEMPORARY FENCE
- EXISTING FENCE

NOTES

1. CONTRACTOR SHALL CLEAN SITE OF ALL TRASH AND DEBRIS WITHIN CONSTRUCTION LIMITS.
2. CONTRACTOR SHALL PRESSURE WASH ALL CONCRETE COLUMNS, BEND CAPS, UNDERSIDE OF OVERPASSES, AND STEEL & CONCRETE BEAMS WITHIN LIMITS OF CONSTRUCTION.
3. CCTV REPORTS AND CLEANING SHALL BE REQUIRED FOR UNDERGROUND DRAINAGE PIPES, CATCH BASINS, AND MANHOLES WITHIN LIMITS OF CONSTRUCTION.
4. CONTRACTOR SHALL TRIM REQUIRED TREE ALONG THE EXISTING PRIVATE PROPERTY FENCE WITHIN CONSTRUCTION LIMITS

PARKING CAPACITY TABLE		
PROPOSED STALLS	DIMENSIONS	NUMBER OF STALLS
STANDARD VEHICLE	9'x18'	100
ADA-ACCESSIBLE	9'x18'	5
RV/TRAILER	12'x40'	3
TOTAL PARKING STALLS:		108
FOOD TRUCK STALLS (12'x25'):		7

60% FINAL PLANS
 NOT TO BE USED FOR BIDDING, CONSTRUCTION, RECONSTRUCTION, CONVEYANCE, SALES OR AS THE BASIS FOR THE ISSUANCE OF A PERMIT PREPARED UNDER THE SUPERVISION OF YOSEPH SHIFARE, PE, P10E LOUISIANA P.E. LIC. NO. 42747 PIVOTAL ENGINEERING, LLC

SUPER BOWL FOOD TRUCK PLAZA - PROPOSED SITE PLAN
 1" = 30"

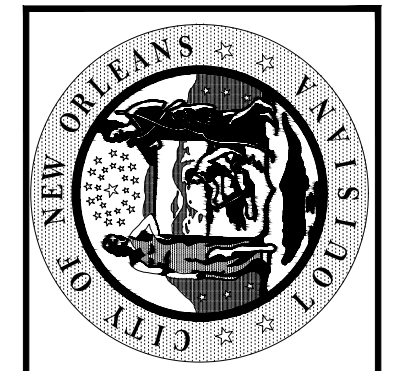

DEPARTMENT OF CAPITAL PROJECTS
 1901 PERDIDO ST
 NEW ORLEANS, LA 70112

PIVOTAL ENGINEERING
 CIVIL, ELECTRICAL, ENVIRONMENTAL & MECHANICAL ENGINEERING
 1515 POYDRAS STREET, STE. 1150
 NEW ORLEANS, LA. 70112
 504.799.3653 504.799.3654 FAX

THESE DRAWINGS HAVE BEEN PREPARED TO THE BEST OF MY KNOWLEDGE AND BELIEF IN ACCORDANCE WITH THE STATE AND FEDERAL REQUIREMENTS AND I AM NOT PROVIDING ANY GUARANTEE OR REPRESENTATION OF THE WORK, WHICH WILL BE PERFORMED BY THE CONTRACTOR.
 Yoseph Shifare
 PROFESSIONAL ENGINEER
 07/03/24 42747
 STATE LICENSE NO.

EARHART BLVD. FOOD TRUCK PLAZA
 2739 EARHART BLVD, NEW ORLEANS, LA 70113





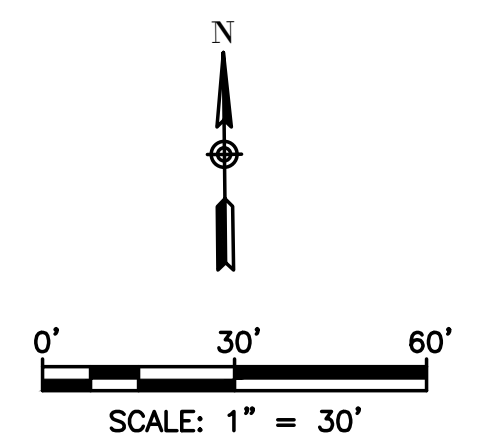
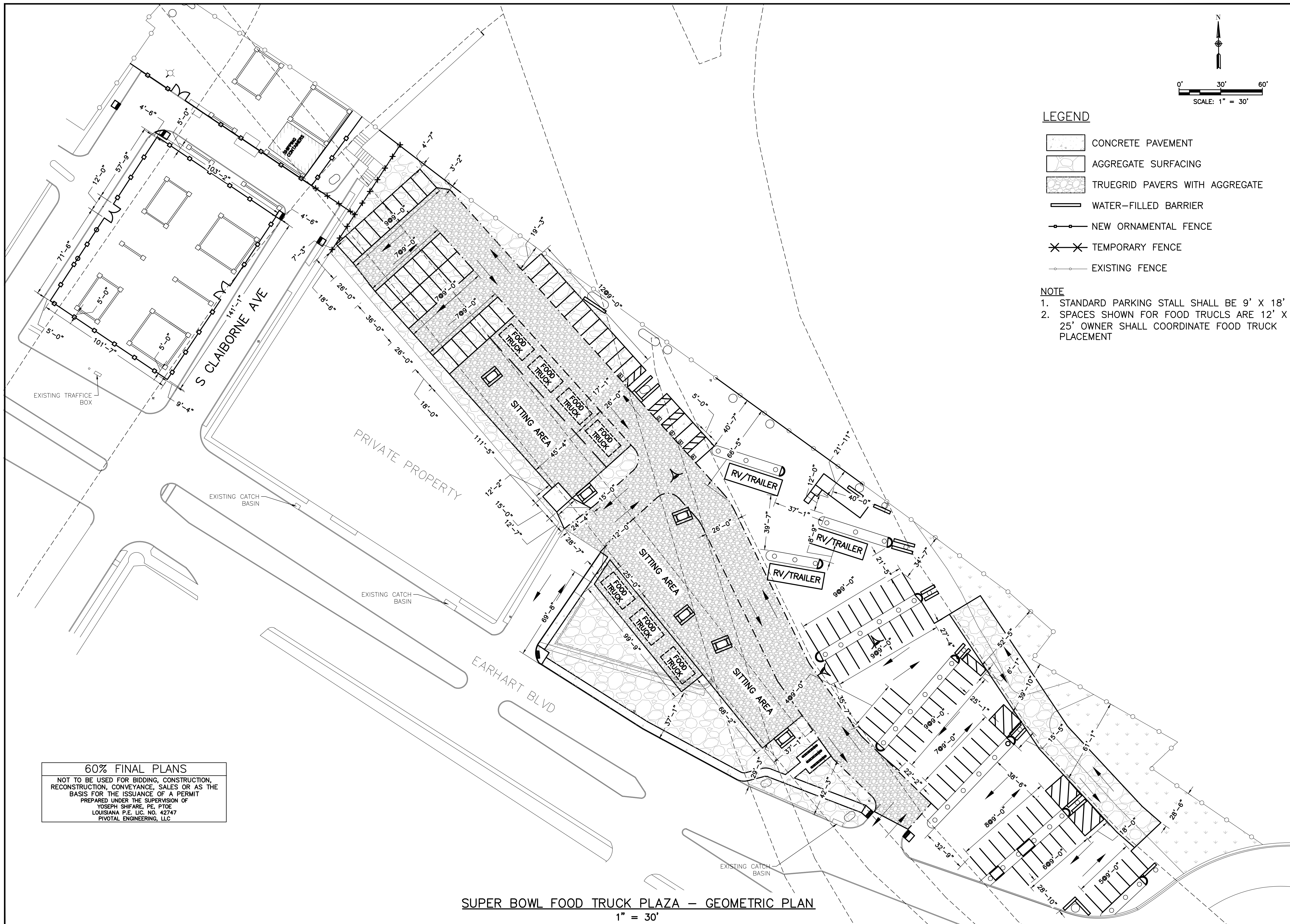

revisions	
no.	date & description
1	
2	
3	
4	

job number Task 30
 drawn by E.G. P.S., T.G.
 checked by Y.S.
 date 07-12-2024
 phase 60% FINAL PLAN

PROPOSED SITE PLAN
 drawing number
 C-3

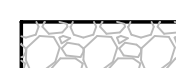

LEGEND

-  CONCRETE PAVEMENT
-  AGGREGATE SURFACING
-  TRUEGRID PAVERS WITH AGGREGATE
-  WATER-FILLED BARRIER
-  NEW ORNAMENTAL FENCE
-  TEMPORARY FENCE
-  EXISTING FENCE

NOTE

1. STANDARD PARKING STALL SHALL BE 9' X 18'
2. SPACES SHOWN FOR FOOD TRUCKS ARE 12' X 25'. OWNER SHALL COORDINATE FOOD TRUCK PLACEMENT

60% FINAL PLANS
 NOT TO BE USED FOR BIDDING, CONSTRUCTION,
 RECONSTRUCTION, CONVEYANCE, SALES OR AS THE
 BASIS FOR THE ISSUANCE OF A PERMIT
 PREPARED UNDER THE SUPERVISION OF
 YOSEPH SHIFARE, P.E., P.T.O.E.
 LOUISIANA P.E. LIC. NO. 42747
 PIVOTAL ENGINEERING, LLC

SUPER BOWL FOOD TRUCK PLAZA – GEOMETRIC PLAN
 1" = 30'



DEPARTMENT OF
 CAPITAL PROJECTS
 1801 PERDIDO ST
 NEW ORLEANS, LA 70112

PIVOTAL ENGINEERING
 CIVIL, ELECTRICAL, ENVIRONMENTAL
 & MECHANICAL ENGINEERING
 1515 POYDRAS STREET, STE. 1150
 NEW ORLEANS, LA. 70112
 504.799.3653 504.799.3654 FAX

THESE DRAWINGS HAVE BEEN PREPARED
 TO THE BEST OF MY KNOWLEDGE AND
 BELIEF IN ACCORDANCE WITH THE
 STATE AND FEDERAL REQUIREMENTS,
 AND I AM NOT PROVIDING ANY
 GUARANTEE OR WARRANTY, AND I WILL
 BE RESPONSIBLE FOR THE WORK, AND I
 AM NOT PROVIDING ANY OTHER
 INFORMATION.

Yoseph Shifare
 PROFESSIONAL OF RECORD
 07/05/24 42747
 STATE LIC. NO.

**EARHART BLVD. FOOD
 TRUCK PLAZA**
 2739 EARHART BLVD, NEW ORLEANS, LA 70113

revisions	
no.	date & description
1	
2	
3	
4	
job number	Task 30
drawn by	E.G. P.S., T.G.
checked by	Y.S.
date	07-12-2024
phase	60% FINAL PLAN

**GEOMETRIC
 PLAN**
 drawing number
C-4

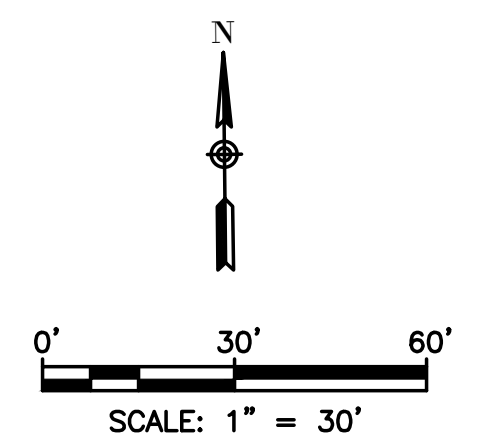
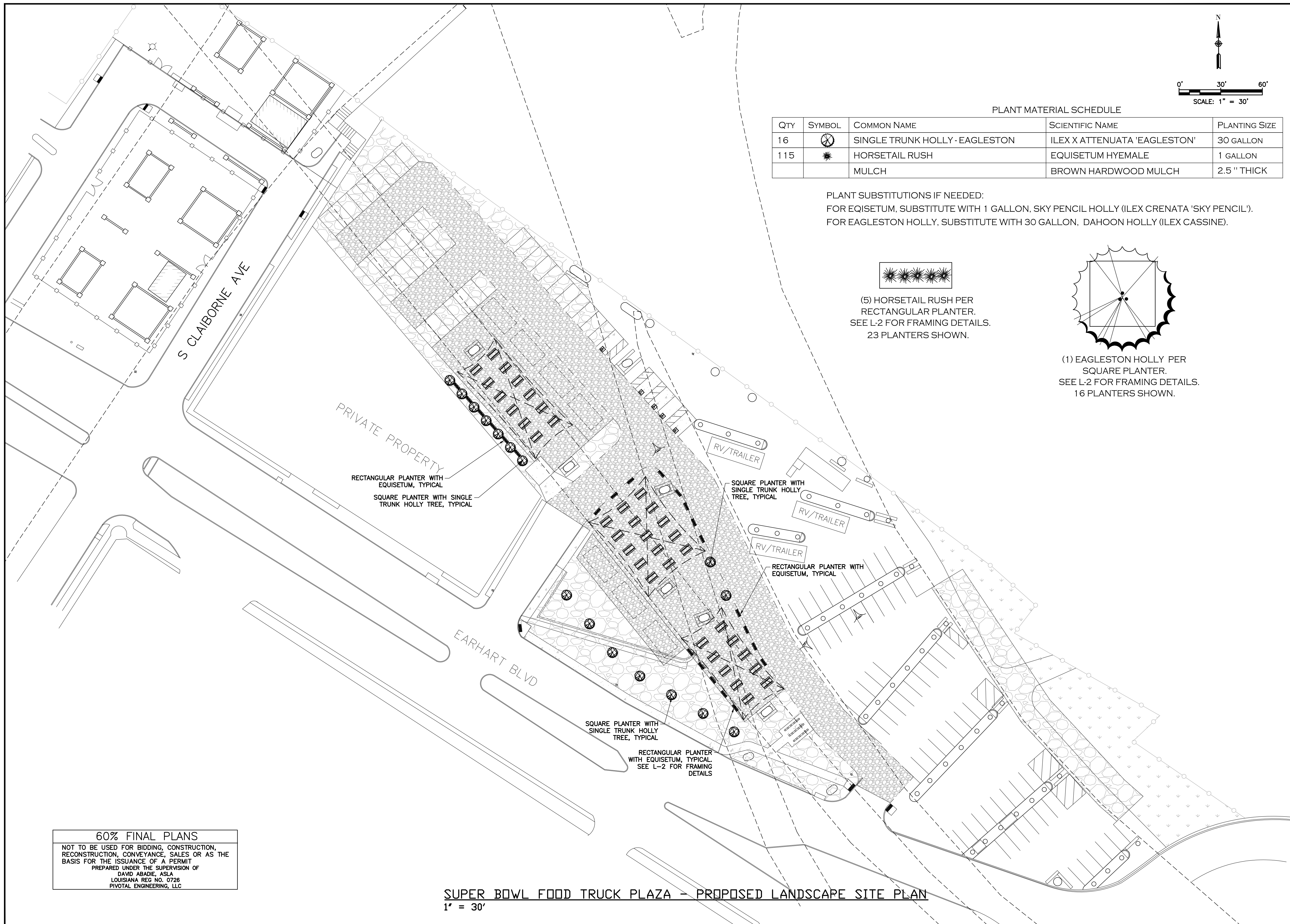

PLANT MATERIAL SCHEDULE

QTY	SYMBOL	COMMON NAME	SCIENTIFIC NAME	PLANTING SIZE
16		SINGLE TRUNK HOLLY - EAGLESTON	ILEX X ATTENUATA 'EAGLESTON'	30 GALLON
115		HORSETAIL RUSH	EQUISETUM HYEMALE	1 GALLON
		MULCH	BROWN HARDWOOD MULCH	2.5" THICK

PLANT SUBSTITUTIONS IF NEEDED:
 FOR EQUISETUM, SUBSTITUTE WITH 1 GALLON, SKY PENCIL HOLLY (ILEX CRENATA 'SKY PENCIL').
 FOR EAGLESTON HOLLY, SUBSTITUTE WITH 30 GALLON, DAHOON HOLLY (ILEX CASSINE).

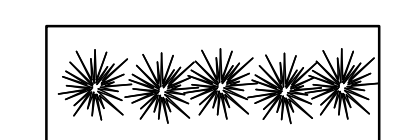

(5) HORSETAIL RUSH PER
 RECTANGULAR PLANTER.
 SEE L-2 FOR FRAMING DETAILS.
 23 PLANTERS SHOWN.

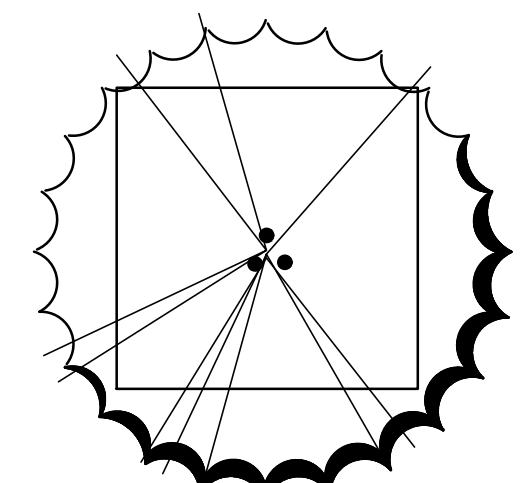

(1) EAGLESTON HOLLY PER
 SQUARE PLANTER.
 SEE L-2 FOR FRAMING DETAILS.
 16 PLANTERS SHOWN.

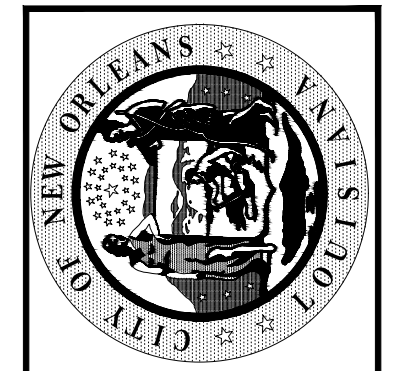

DEPARTMENT OF
 CAPITAL PROJECTS
 1901 PERDIDO ST
 NEW ORLEANS, LA 70112

PIVOTAL ENGINEERING
 CIVIL, ELECTRICAL, ENVIRONMENTAL
 & MECHANICAL ENGINEERING
 1515 POYDRAS STREET, STE. 1150
 NEW ORLEANS, LA. 70112
 504.799.3653 504.799.3654 FAX

THESE DRAWINGS HAVE BEEN PREPARED
 TO THE BEST OF MY KNOWLEDGE AND
 BELIEF IN ACCORDANCE WITH THE
 STATE AND FEDERAL REQUIREMENTS,
 AND I AM NOT PROVIDING ANY
 GUARANTEE OR WARRANTY OF ANY KIND.
 OBSERVATION OF THE WORK WILL BE
 PERFORMED BY OUR OFFICE.

PROFESSIONAL OF RECORD
 DATE _____ LIC. NO. _____

EARHART BLVD. FOOD
 TRUCK PLAZA
 2739 EARHART BLVD, NEW ORLEANS, LA 70113

revisions	
no.	date & description
1	
2	
3	
4	

job number Task 30
 drawn by E.G. P.S., T.G.
 checked by Y.S.
 date 07-12-2024
 phase 60% FINAL PLAN

PROPOSED
 LANDSCAPE
 SITE PLAN

drawing number
 L-1

60% FINAL PLANS
 NOT TO BE USED FOR BIDDING, CONSTRUCTION,
 RECONSTRUCTION, CONVEYANCE, SALES OR AS THE
 BASIS FOR THE ISSUANCE OF A PERMIT
 PREPARED UNDER THE SUPERVISION OF
 DAVID ABADIE, ASLA
 LOUISIANA REG NO. 0726
 PIVOTAL ENGINEERING, LLC

SUPER BOWL FOOD TRUCK PLAZA - PROPOSED LANDSCAPE SITE PLAN
 1" = 30'

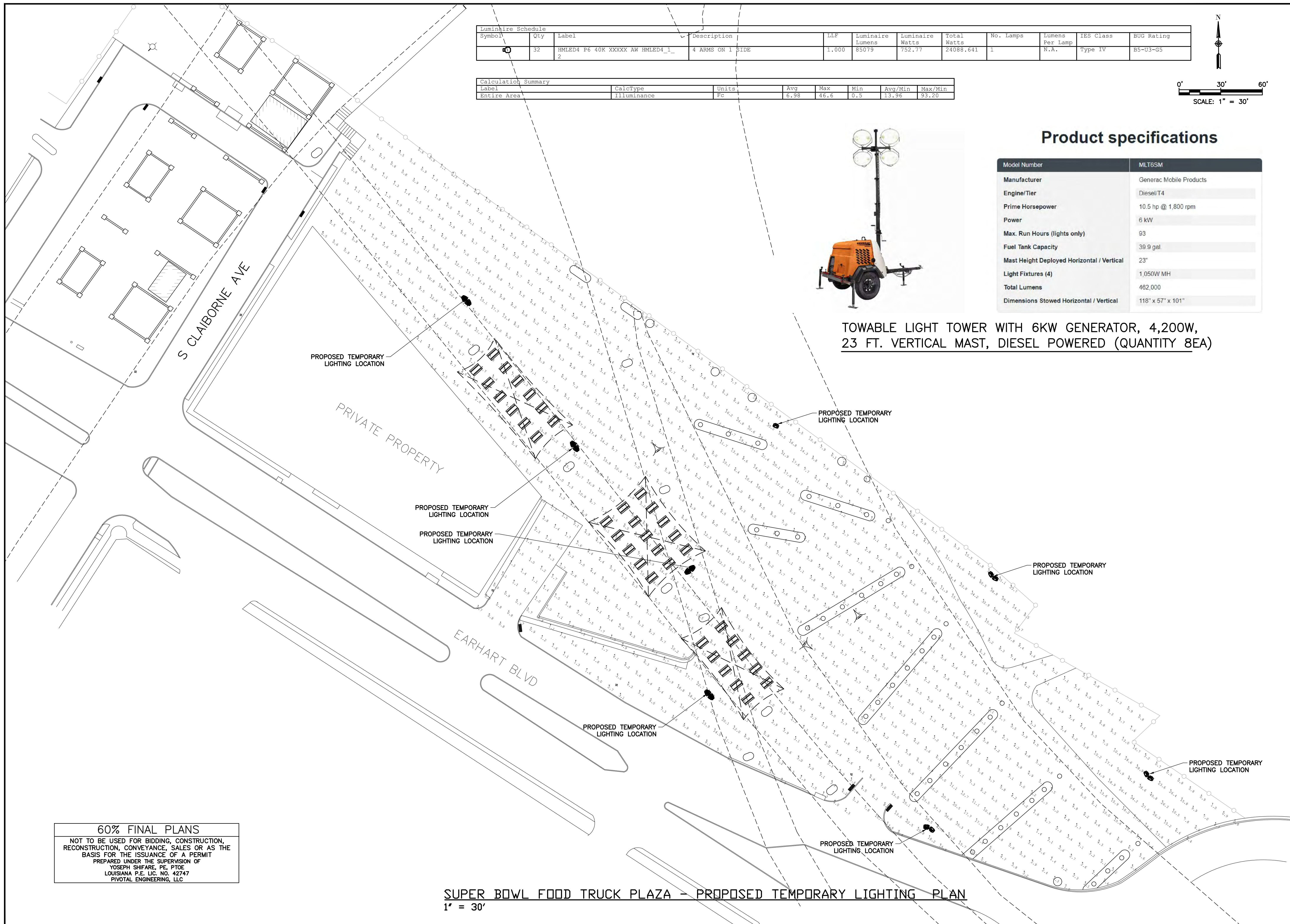

Luminaire Schedule											
Symbol	Qty	Label	Description	LLF	Luminaire Lumens	Luminaire Watts	Total Watts	No. Lamps	Lumens Per Lamp	IES Class	BUG Rating
⊙	32	HMLEd4 P6 40K XXXXX AW HMLEd4_1_2	4 ARMS ON 1 SIDE	1.000	85079	752.77	24088.641	1	N.A.	Type IV	B5-U3-G5

Calculation Summary							
Label	CalcType	Units	Avg	Max	Min	Avg/Min	Max/Min
Entire Area	Illuminance	Fc	6.98	46.6	0.5	13.96	93.20

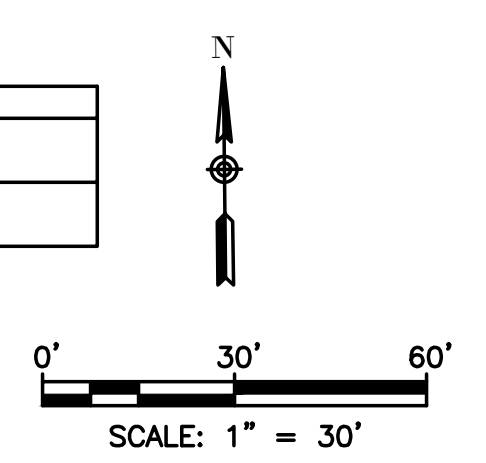

Product specifications

Model Number	MLT6SM
Manufacturer	Generac Mobile Products
Engine/Tier	Diesel/T4
Prime Horsepower	10.5 hp @ 1,800 rpm
Power	6 kW
Max. Run Hours (lights only)	93
Fuel Tank Capacity	39.9 gal
Mast Height Deployed Horizontal / Vertical	23"
Light Fixtures (4)	1,050W MH
Total Lumens	462,000
Dimensions Stowed Horizontal / Vertical	118" x 57" x 101"

TOWABLE LIGHT TOWER WITH 6KW GENERATOR, 4,200W, 23 FT. VERTICAL MAST, DIESEL POWERED (QUANTITY 8EA)

60% FINAL PLANS
 NOT TO BE USED FOR BIDDING, CONSTRUCTION, RECONSTRUCTION, CONVEYANCE, SALES OR AS THE BASIS FOR THE ISSUANCE OF A PERMIT
 PREPARED UNDER THE SUPERVISION OF
 YOSEPH SHIFARE, PE, PTCE
 LOUISIANA P.E. LIC. NO. 42747
 PIVOTAL ENGINEERING, LLC

SUPER BOWL FOOD TRUCK PLAZA - PROPOSED TEMPORARY LIGHTING PLAN
 1" = 30'



DEPARTMENT OF CAPITAL PROJECTS
 1601 PERDIDO ST
 NEW ORLEANS, LA 70112

PIVOTAL ENGINEERING
 CIVIL, ELECTRICAL, ENVIRONMENTAL & MECHANICAL ENGINEERING
 1515 POYDRAS STREET, STE. 1150
 NEW ORLEANS, LA. 70112
 504.799.3653 504.799.3654 FAX

THESE DRAWINGS HAVE BEEN PREPARED TO THE BEST OF MY KNOWLEDGE AND BELIEF IN ACCORDANCE WITH THE STATE AND FEDERAL REQUIREMENTS, AND I AM NOT PROVIDING ANY GUARANTEE OR OBSERVATION OF THE WORK, WILL BE PERFORMED BY OUR OFFICE.

PROFESSIONAL OF RECORD
 DATE _____ LIC. NO. _____

EARHART BLVD. FOOD TRUCK PLAZA
 2739 EARHART BLVD, NEW ORLEANS, LA 70113

revisions	
no.	date & description
1	
2	
3	
4	

job number Task 30
 drawn by E.G. P.S., T.G.
 checked by Y.S.
 date 07-12-2024
 phase 60% FINAL PLAN

PROPOSED TEMPORARY LIGHTING PLAN

drawing number
E-1

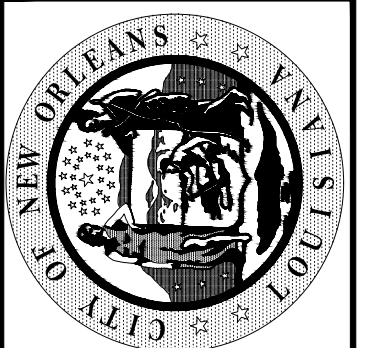

DEPARTMENT OF
CAPITAL PROJECTS
1601 PERDIDO ST
NEW ORLEANS, LA 70112

PIVOTAL ENGINEERING
CIVIL, ELECTRICAL, ENVIRONMENTAL
& MECHANICAL ENGINEERING
1515 POYDRAS STREET, STE. 1150
NEW ORLEANS, LA. 70112
504.799.3653 504.799.3654 FAX

THESE DRAWINGS HAVE BEEN PREPARED
BY THE ENGINEER OR ARCHITECT AND
TO THE BEST OF HIS KNOWLEDGE AND
FAITHFUL BELIEF THEY COMPLY WITH ALL
REQUIREMENTS OF THE CITY OF NEW
ORLEANS. THE ENGINEER OR ARCHITECT
TAKES NO RESPONSIBILITY FOR THE
PROVISION OF MATERIALS OR THE
PERFORMANCE OF THE CONTRACTOR.
PREPARED BY OUR OFFICE.
Joseph Shifare
07/03/24 42747
DATE

2739 EARHART BLVD, NEW ORLEANS, LA 70113
**EARHART BLVD. FOOD
TRUCK PLAZA**

revisions	
no.	date & description
1	
2	
3	
4	
job number	Task 30
drawn by	E.G.
checked by	Y.S.
date	07-01-2024
phase	100% PRELIMINARY PLAN

**PROPOSED
SITE PLAN**

drawing number
C-1

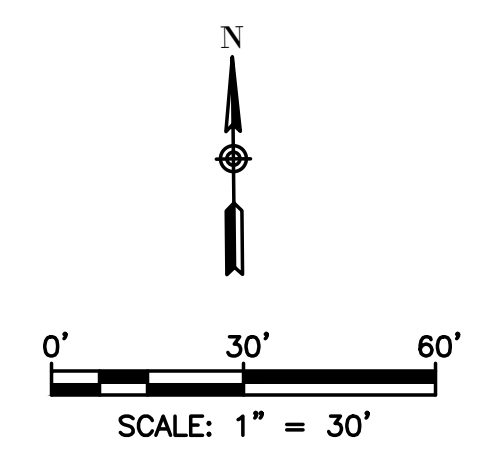

LEGEND

- CONCRETE PAVEMENT
- AGGREGATE SURFACING
- TRUEGRID PAVERS WITH AGGREGATE
- TEMPORARY CONCRETE JERSEY BARRIER

NOTES

1. CONTRACTOR SHALL CLEAN SITE OF ALL TRASH AND DEBRIS WITHIN CONSTRUCTION LIMITS.
2. CONTRACTOR SHALL PRESSURE WASH ALL CONCRETE COLUMNS, BEND CAPS, UNDERSIDE OF OVERPASSES, AND STEEL & CONCRETE BEAMS WITHIN LIMITS OF CONSTRUCTION.
3. CCTV REPORTS AND CLEANING SHALL BE REQUIRED FOR UNDERGROUND DRAINAGE PIPES, CATCH BASINS, AND MANHOLES WITHIN LIMITS OF CONSTRUCTION.

PARKING CAPACITY TABLE		
PROPOSED STALLS	DIMENSIONS	NUMBER OF STALLS
STANDARD VEHICLE	9'x18'	100
ADA-ACCESSIBLE	9'x18'	5
RV/TRAILER	12'x40'	4
TOTAL PARKING STALLS:		109
FOOD TRUCK STALLS (12'x25'):		7

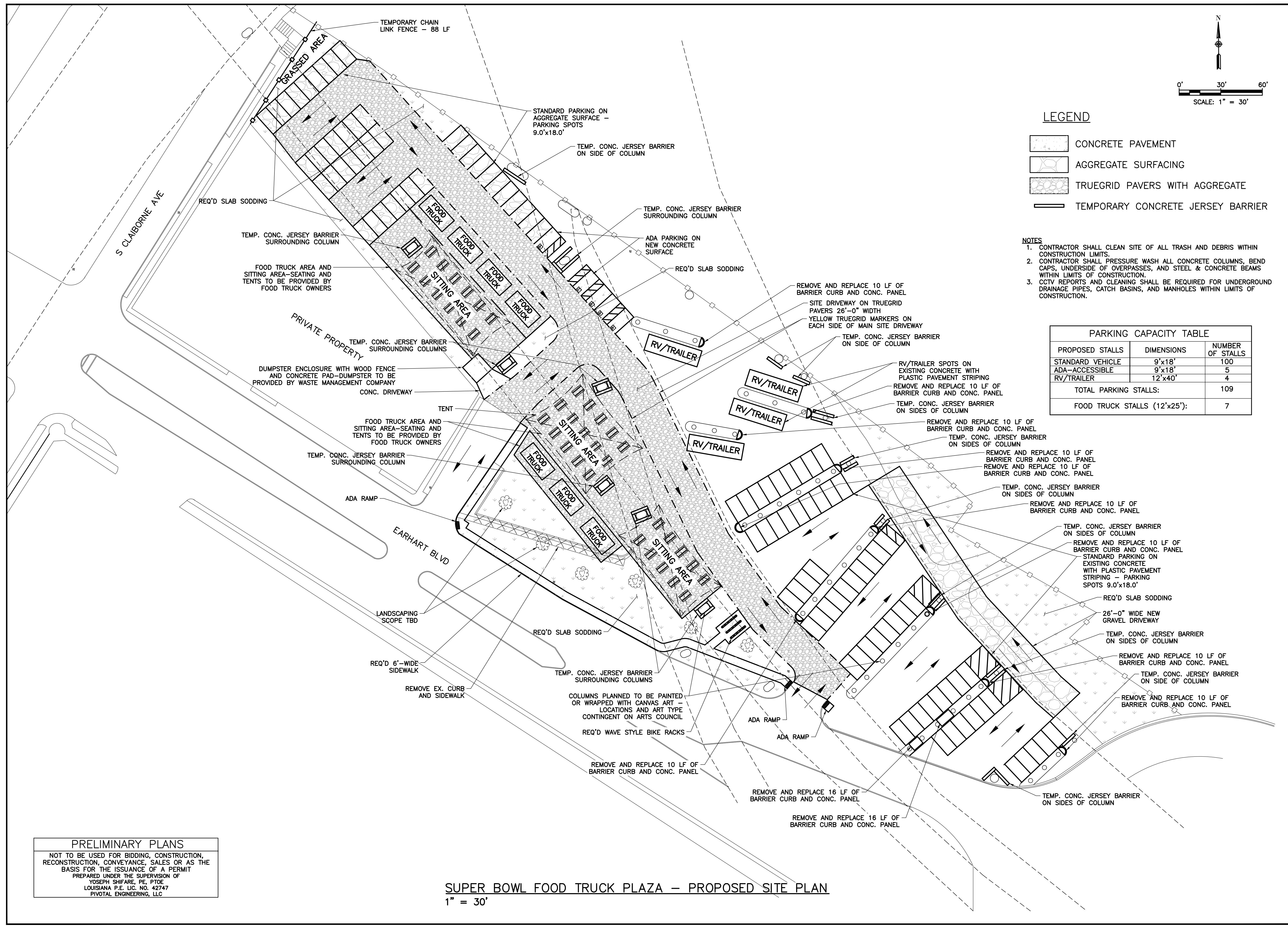

PRELIMINARY PLANS
NOT TO BE USED FOR BIDDING, CONSTRUCTION,
RECONSTRUCTION, CONVEYANCE, SALES OR AS THE
BASIS FOR THE ISSUANCE OF A PERMIT
PREPARED UNDER THE SUPERVISION OF
YOSEPH SHIFARE, PE, PTOE
LOUISIANA P.E. LIC. NO. 42747
PIVOTAL ENGINEERING, LLC

SUPER BOWL FOOD TRUCK PLAZA – PROPOSED SITE PLAN
1" = 30'

NOTES:

1. SUB-BASE DEPTH AND PREPARATION IS DEPENDENT ON SITE CONDITIONS PLUS LOADING REQUIREMENTS.
2. TRUEGRID PRO & PRO PLUS PRODUCTS DESIGNED FOR LOAD CAPACITIES OF 120,000 LBS PER SQ. FT. TRUEGRID PRODUCTS STRENGTHEN WITH FILL MATERIAL.
3. TRUEGRID PRO & PRO PLUS PRODUCTS ARE SUFFICIENTLY RATED FOR H-20 /HS-20 LOADING AND GREATER.
4. GEOGRID MESH OR GEOFABRIC MAY BE REQUIRED BETWEEN SUB-GRADE & SUB-BASE FOR CERTAIN SOILS AND SITE SPECIFIC REQUIREMENTS.
5. INCREASE SUB-BASE DEPTH FOR INCREASED STORM WATER DETENTION.
6. NO STAKING NECESSARY WITH TRUEGRID PRO & PRO PLUS WHEN SLOPE IS BELOW 10 DEGREES. ASSESS PROJECT, AS NEEDED.
7. FINAL ENGINEERED CROSS SECTION AGGREGATES AND DEPTH SHOULD ALLOW FOR EXPECTED INFILTRATION RATES, STORAGE CAPACITIES, OUTLET FLOW RATES, AND OTHER SITE SPECIFIC CONDITIONS AND LOAD REQUIREMENTS.
8. THIS CROSS SECTION IS FOR INFORMATION ONLY.

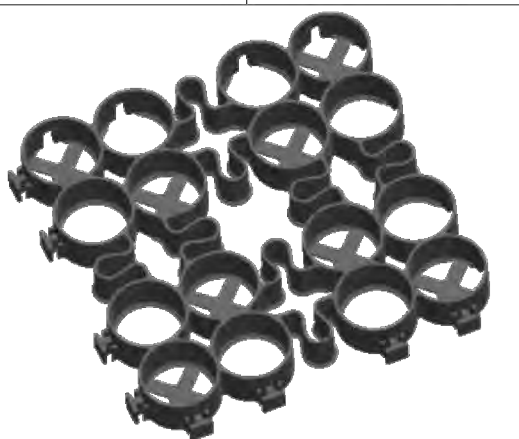

TRUEGRID BLOCK REFERENCE VIEW
PREASSEMBLED & DELIVERED IN 4' X 4' SHEET, RECONFIGURED AS NEEDED NO EXTRA TOOLING OR ACCESSORIES REQUIRED

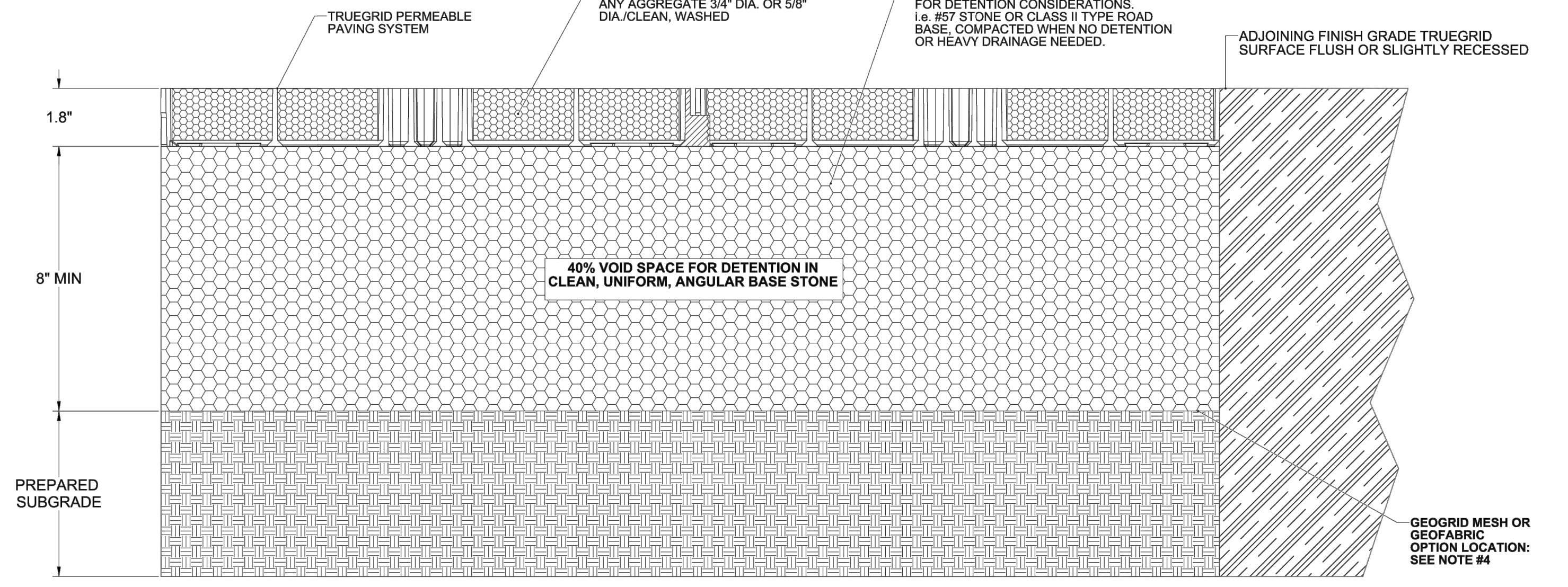

APPLICATION: HEAVY LOAD PARKING LOT, FIRE LANES, EQUIPMENT YARD, SERVICE ROADS.

GRAVEL FILL HEAVY LOAD TRUEGRID PRO & PRO PLUS

REV	DESCRIPTION	DATE	CHECKED	APPROVED
02	REVISED NOTE 8	03/02/2017	JT	CM

CLIENT / PROJECT		APPROVAL INFORMATION	
UNLESS OTHERWISE SPECIFIED, "DIMENSIONS ARE IN INCHES"			
<small>PROPRIETARY DESIGN RIGHTS NOTICE: THIS DESIGN IS THE PROPERTY OF TRUEGRID. ANY REPRODUCTION OR USE OF THIS DESIGN WITHOUT THE WRITTEN PERMISSION OF TRUEGRID IS STRICTLY PROHIBITED. THE USER ASSUMES ALL LIABILITY FOR THE PROPER USE OF THIS DESIGN. THE USER SHALL BE RESPONSIBLE FOR OBTAINING ALL NECESSARY PERMITS AND APPROVALS FROM THE APPROPRIATE AGENCIES.</small>		DESIGNER: J. Thilly DATE: 02/01/15 PROJECT: TRUEGRID GRAVEL FILL INSTALLATION HEAVY LOAD DRAWING NUMBER: TG-GRV-HL SHEET: 02	



- TRUEGRID PRO PLUS 24" X 24" X 1.8"**
- US PATENT NO. 8,734,049
- PROPRIETARY FEATURES:**
- 1) X-ANCHORS (NO STAKING NEEDED)
 - 2) 3 POINT MALE/FEMALE LOCKING TABS
 - 3) S-FLEX JOINTS (BUILT IN EXPANSION JOINTS FOR SOIL MOVEMENT AND SEASONAL CHANGES)
 - 4) HOOP STRENGTH DESIGN
- OTHER:**
- 1) 100 % POST-CONSUMER RECYCLED HDPE.
 - 2) DELIVERED IN PREASSEMBLED 4' X 4' SHEETS THAT CAN BE RECONFIGURED, AS NEEDED.

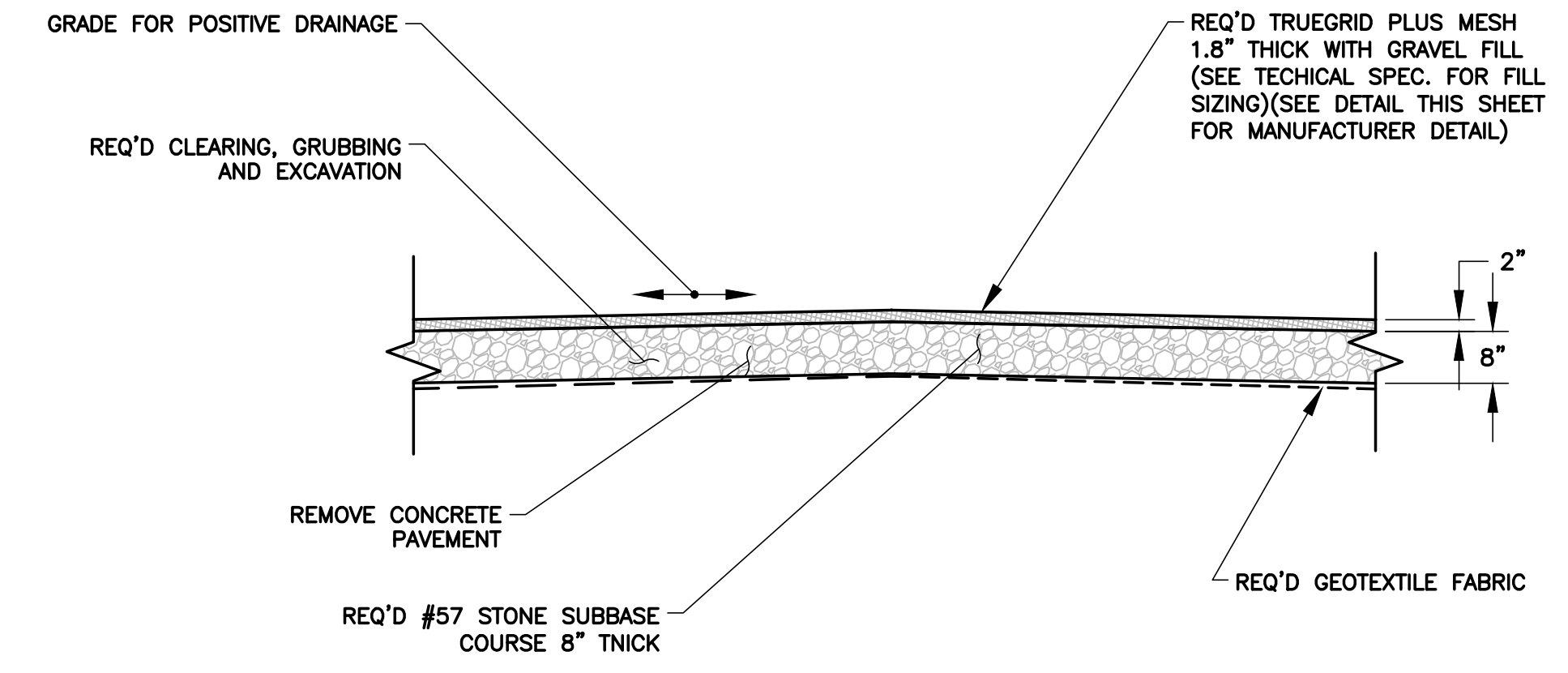
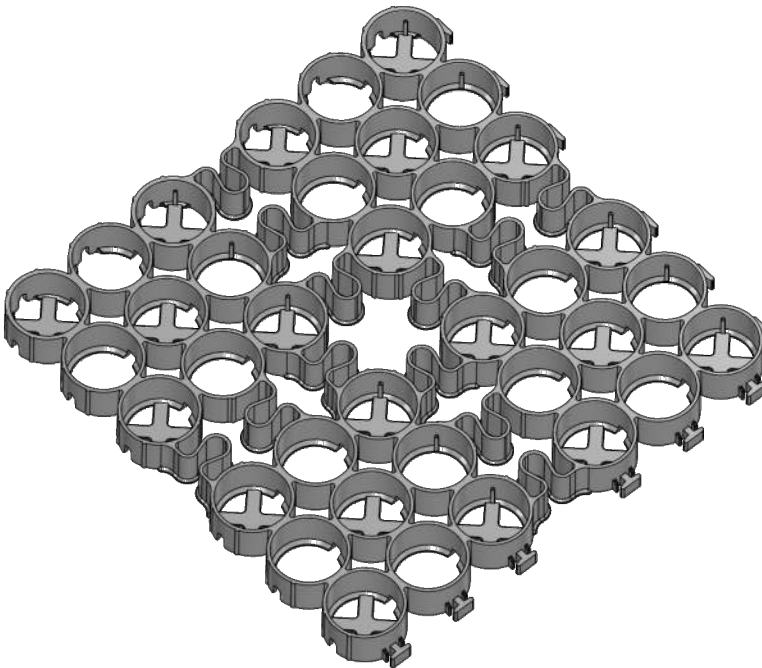
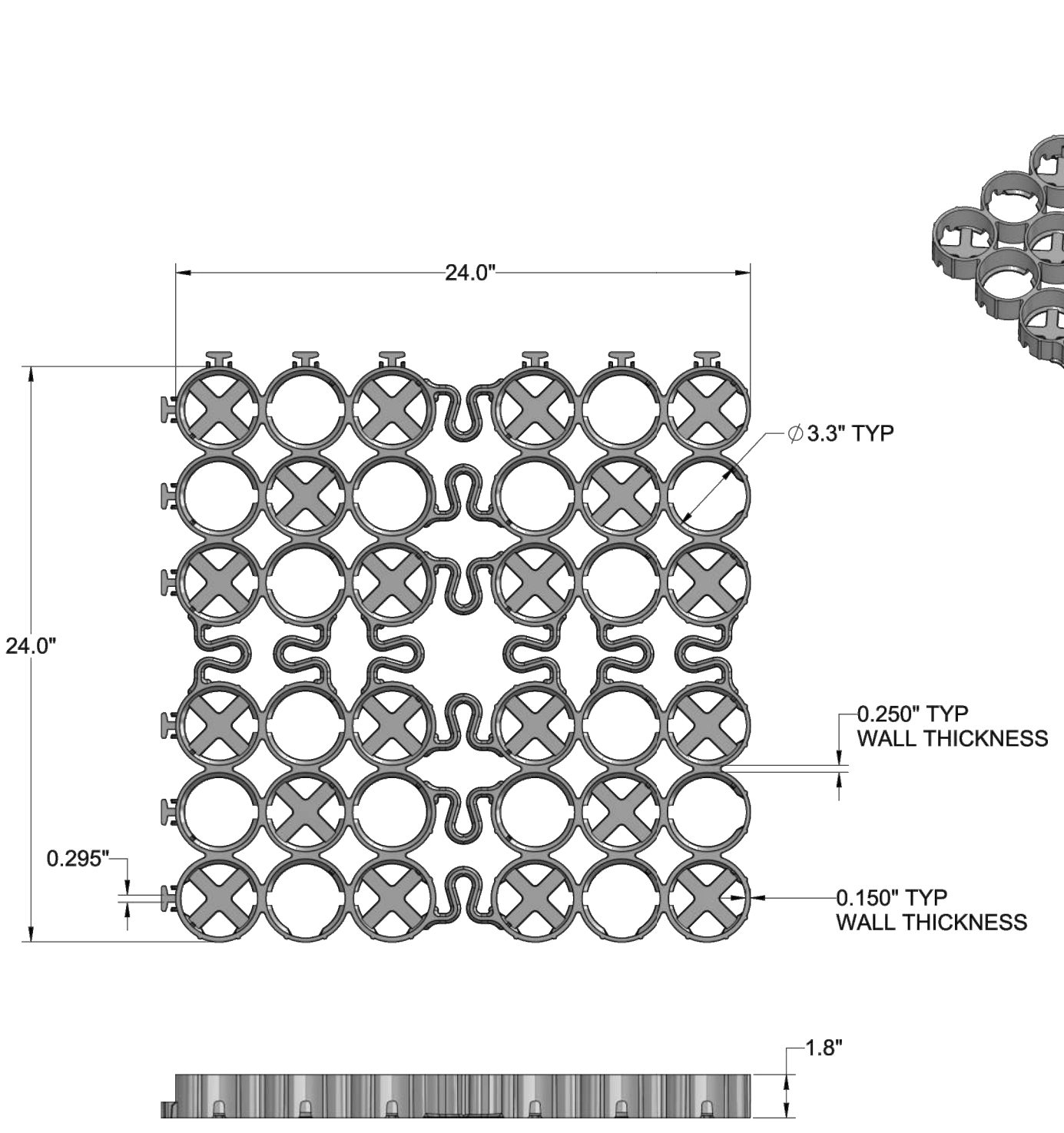

TRUEGRID DETAIL
SCALE: 1/2" = 1'-0"

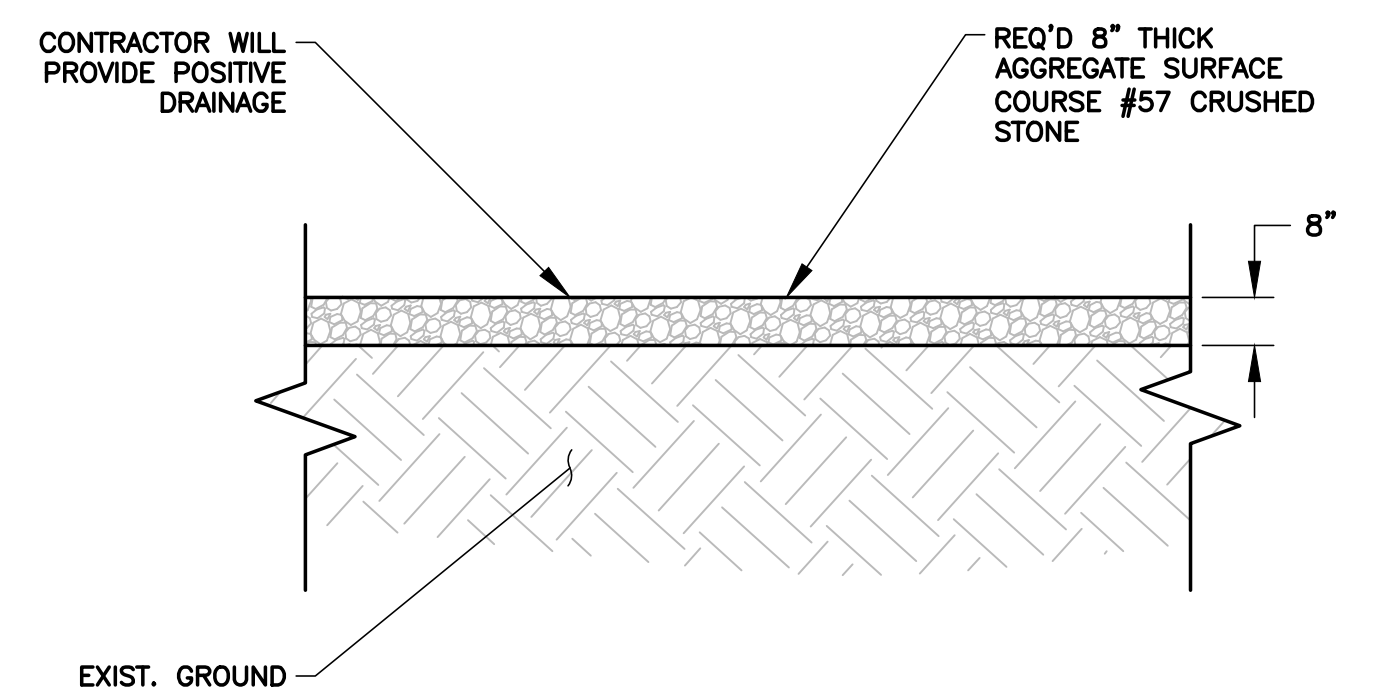

GRAVEL PARKING SURFACE DETAIL
SCALE: 3/8" = 1'-0"

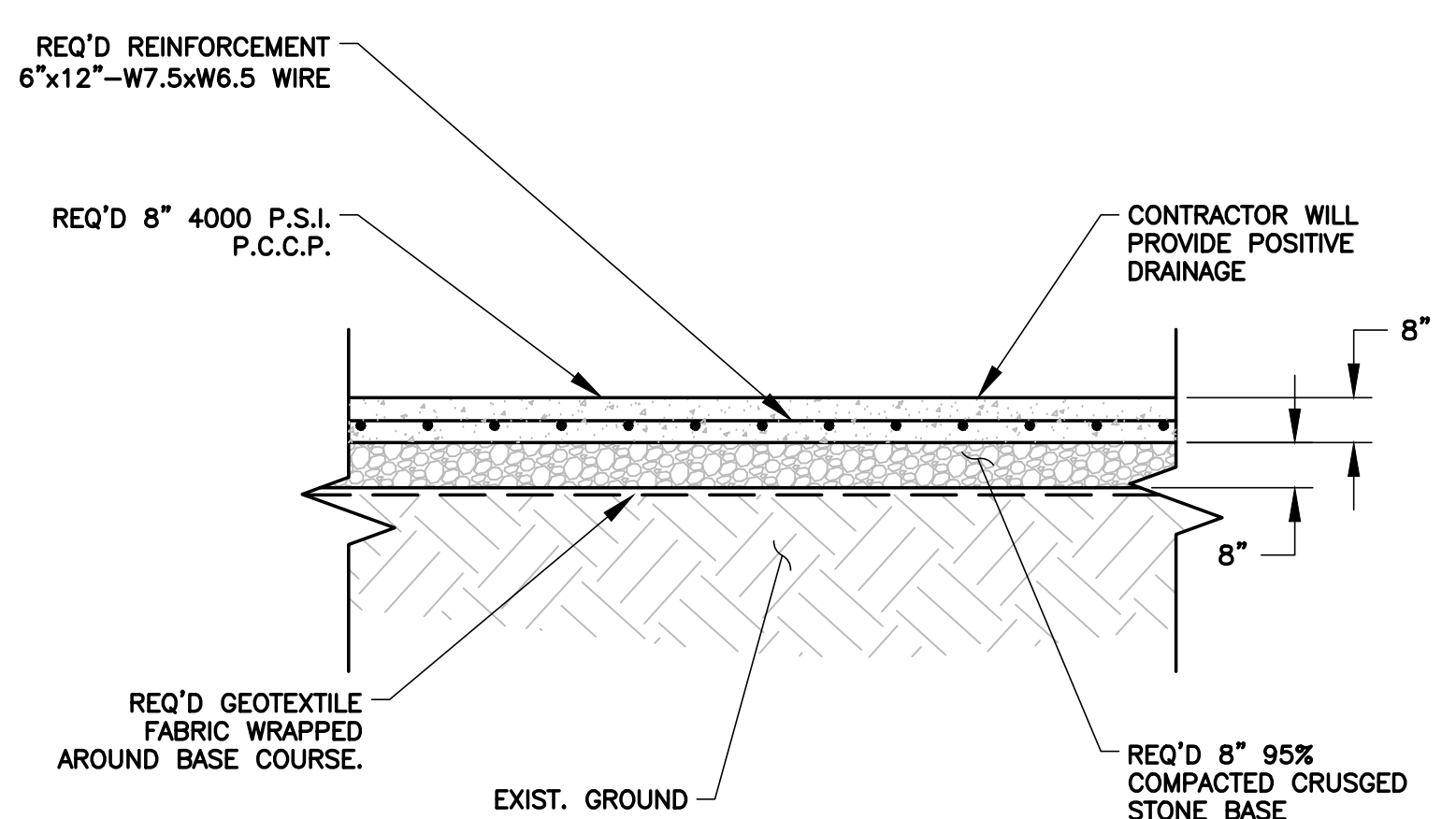

CONCRETE PAVEMENT DETAIL (ADA PARKING & DUMPSTER PAD)
SCALE: 3/8" = 1'-0"

60% FINAL PLANS

NOT TO BE USED FOR BIDDING, CONSTRUCTION, RECONSTRUCTION, CONVEYANCE, SALES OR AS THE BASIS FOR THE ISSUANCE OF A PERMIT PREPARED UNDER THE SUPERVISION OF

YOSEPH SHIFARE, PE, PTOE
LOUISIANA P.E. LIC. NO. 42747
PIVOTAL ENGINEERING, LLC

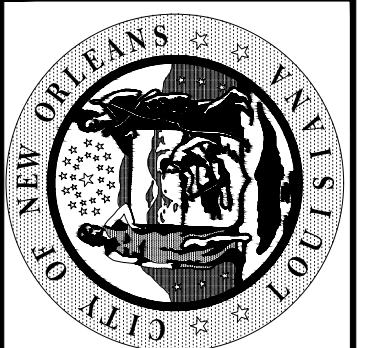

DEPARTMENT OF CAPITAL PROJECTS
1601 PERDIDO ST
NEW ORLEANS, LA 70112

PIVOTAL ENGINEERING
CIVIL, ELECTRICAL, ENVIRONMENTAL & MECHANICAL ENGINEERING
1515 POYDRAS STREET, STE. 1150
NEW ORLEANS, LA. 70112
504.799.3653 504.799.3654 FAX

THESE DRAWINGS HAVE BEEN PREPARED BY THE ENGINEER AND TO THE BEST OF MY KNOWLEDGE AND BELIEF THEY COMPLY WITH ALL LOCAL AND STATE REQUIREMENTS AND ALL APPLICABLE FEDERAL CONSTRUCTION REQUIREMENTS. I WILL BE RESPONSIBLE FOR OBTAINING ALL NECESSARY PERMITS AND APPROVALS FROM THE APPROPRIATE AGENCIES.

Yoseph Shifare
07/03/24 42747
DATE

2739 EARHART BLVD, NEW ORLEANS, LA 70113

EARHART BLVD. FOOD TRUCK PLAZA

revisions	
no.	date & description
1	
2	
3	
4	

job number Task 30
drawn by E.G. P.S., T.G.
checked by Y.S.
date 07-12-2024
phase 60% FIANT PLAN

DETAILS

drawing number
C-1

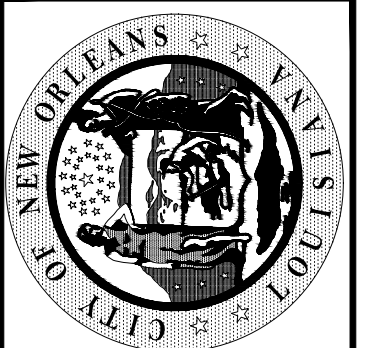

DEPARTMENT OF
CAPITAL PROJECTS
1601 PERDIDO ST
NEW ORLEANS, LA 70112

PIVOTAL ENGINEERING
CIVIL, ELECTRICAL, ENVIRONMENTAL
& MECHANICAL ENGINEERING
1515 POYDRAS STREET, STE. 1150
NEW ORLEANS, LA. 70112
504.799.3653 504.799.3654 FAX

THESE DRAWINGS HAVE BEEN PREPARED
BY AN INDIVIDUAL WHO IS NOT A LICENSED
PROFESSIONAL ENGINEER OR ARCHITECT
AND WHO HAS NOT BEEN REGISTERED WITH
THE BOARD OF PROFESSIONAL ENGINEERS
AND ARCHITECTS OF THE STATE OF LOUISIANA.
THESE DRAWINGS SHALL BE
PREPARED BY OUR OFFICE.
PROFESSIONAL OF RECORD
DATE

**EARHART BLVD. FOOD
TRUCK PLAZA**
2739 EARHART BLVD, NEW ORLEANS, LA 70113

revisions	
no.	date & description
1	
2	
3	
4	
job number	Task 30
drawn by	E.G. P.S., T.G.
checked by	Y.S.
date	07-12-2024
phase	60% FIANTL PLAN

**GATE AND
FENCE DETAIL**

drawing number
C-5

NOTES

- ORNAMENTAL GATE AND FENCE SHALL BE OF ONE OF THE FOLLOWING MANUFACTURERS OR APPROVED EQUAL:
 - AMERISTAR
 - ELITE FENCE PRODUCTS, INC.
 - ALUMINUM-FENCE

SKU: SSTP9610

SONCO
SAFETY MARKETPLACE

8' X 10' VERSA CHAIN LINK TEMP FENCE PANEL

Cross-braced 8x10 temporary fence panels with 2-1/4" x 11.5-gauge chain link wire, stand and hardware options.

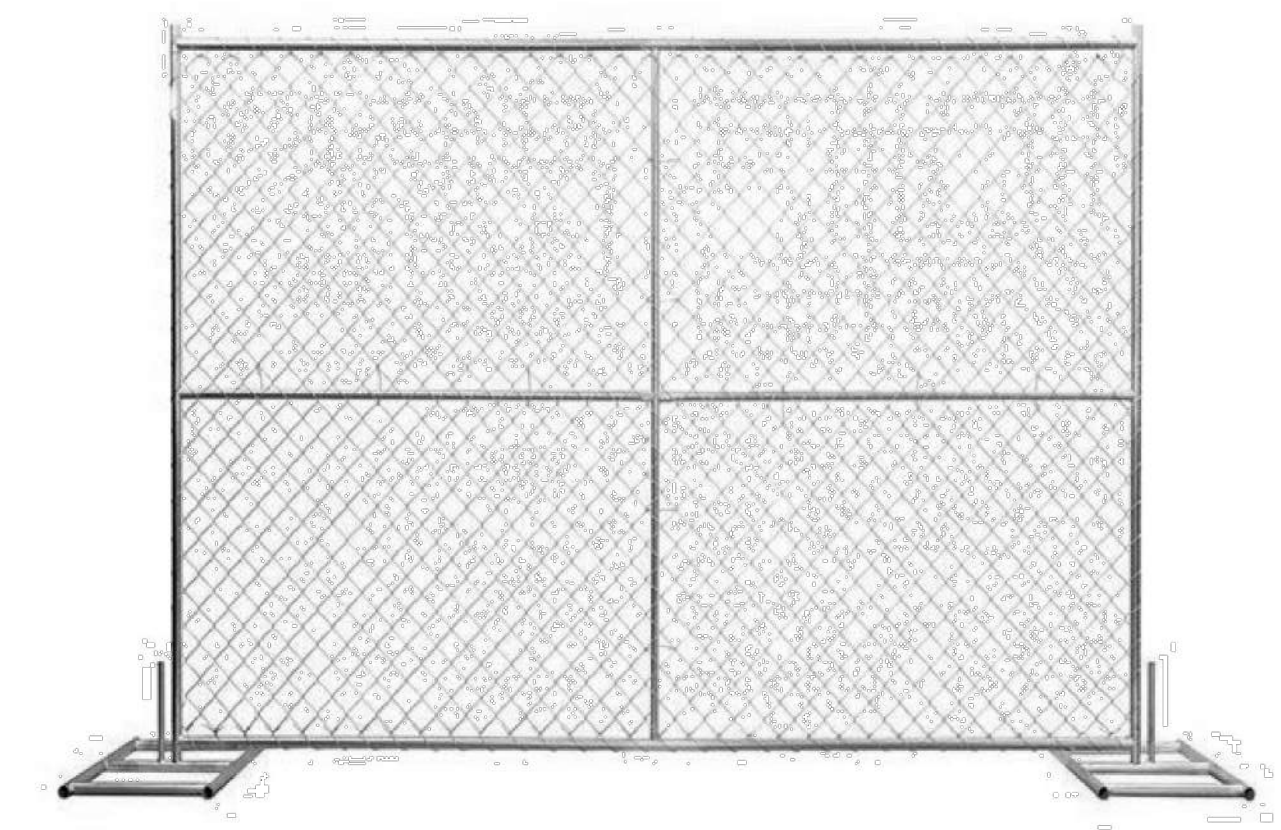

2 TEMPORARY FENCE DETAILS
NOT TO SCALE

ADA + 9 Restroom 600-2159



ADA + 9 Restroom Trailer 600-2159
Events from 250-750 people
19' with 1100 gallon waste tank
Requires up to 4 - 110v - 20 amp separate circuits
** Generator rentals if needed
Water - standard garden hose to water source hookup
** Onboard water tank if needed additional charge

4 TEMPORARY BATHROOM DETAILS
NOT TO SCALE

60% FINAL PLANS
NOT TO BE USED FOR BIDDING, CONSTRUCTION,
RECONSTRUCTION, CONVEYANCE, SALES OR AS THE
BASIS FOR THE ISSUANCE OF A PERMIT
PREPARED UNDER THE SUPERVISION OF
YOSEPH SHIFARE, PE, PTOE
LOUISIANA P.E. LIC. NO. 42747
PIVOTAL ENGINEERING, LLC

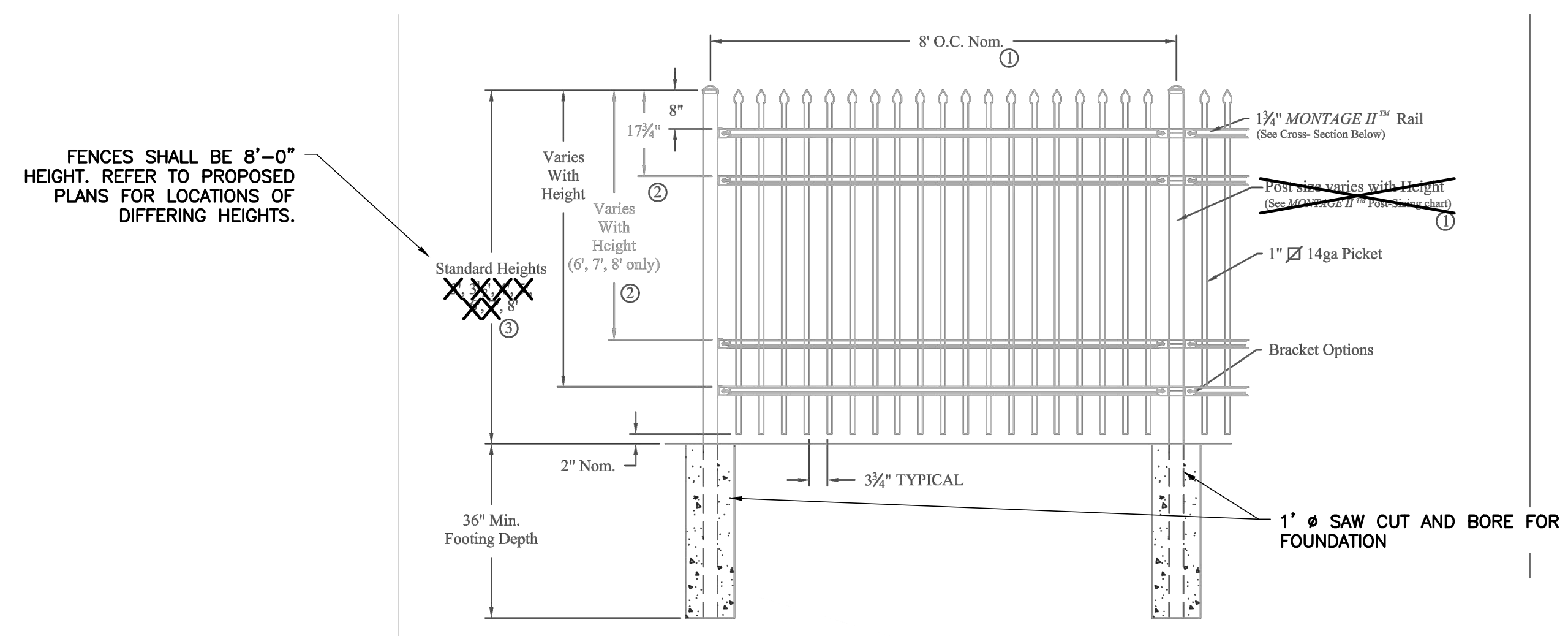

FENCES SHALL BE 8'-0" HEIGHT. REFER TO PROPOSED PLANS FOR LOCATIONS OF DIFFERING HEIGHTS.

MONTAGE II CLASSIC 2/3-4-RAIL

DR: RTM	SH: 1of1	SCALE: DO NOT SCALE
CK: ME	Date: 6/28/10	REV: b

AMERISTAR
1555 N. Mingo
Tulsa, OK 74116
1-888-333-3422
www.ameristarfence.com

1 NEW FENCE DETAILS
NOT TO SCALE

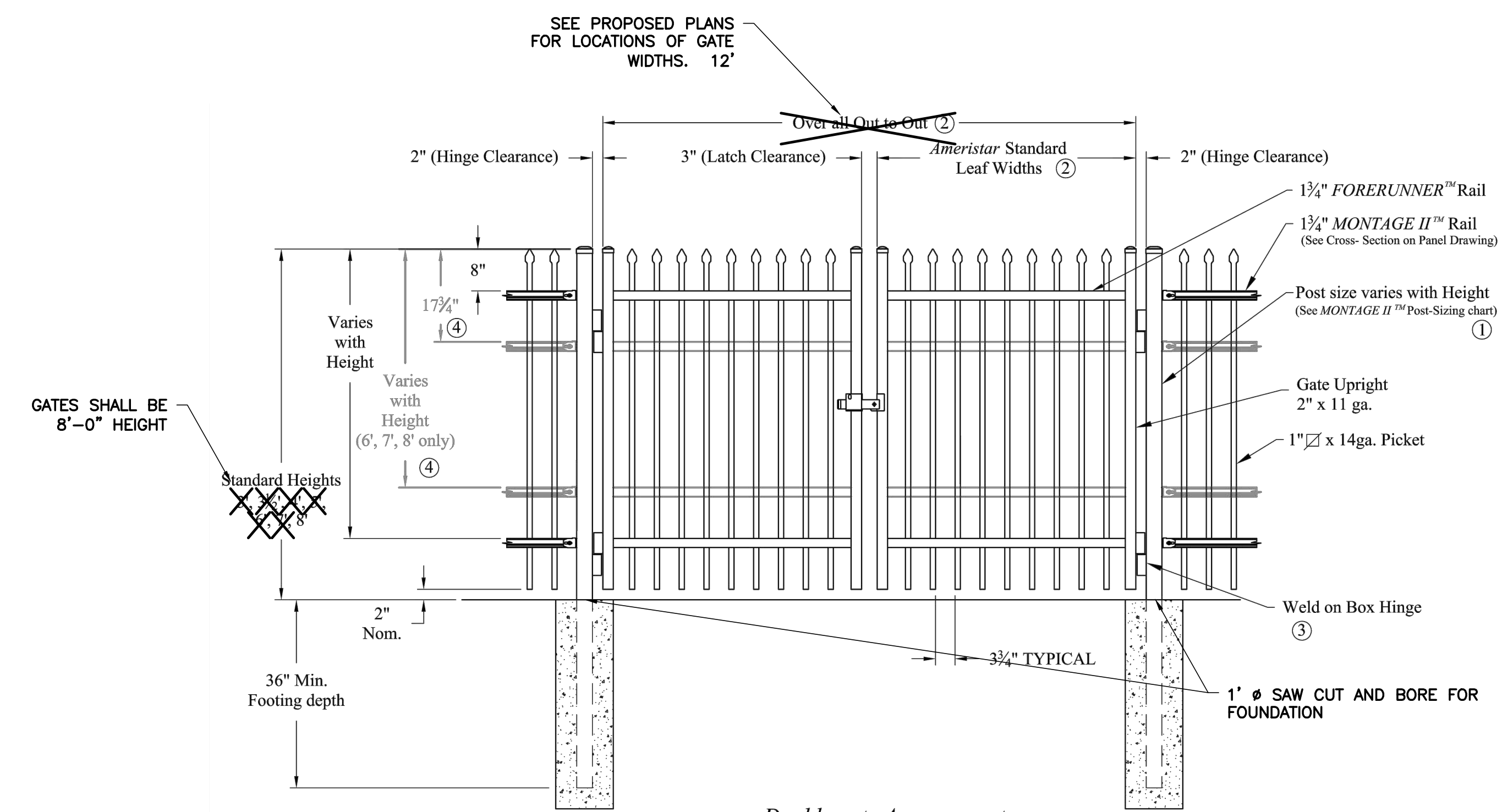

GATES SHALL BE 8'-0" HEIGHT

MONTAGE II CLASSIC 2/3-4-RAIL SGL & DBL GATE

DR: RTM	SH: 1of1	SCALE: DO NOT SCALE
CK: ME	Date: 6/28/10	REV: b

AMERISTAR
1555 N. Mingo
Tulsa, OK 74116
1-888-333-3422
www.ameristarfence.com

3 NEW GATE DETAILS
NOT TO SCALE

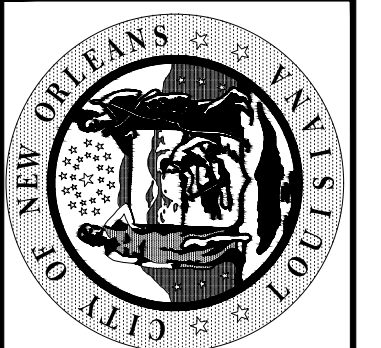

DEPARTMENT OF
CAPITAL PROJECTS
1601 PERDIDO ST
NEW ORLEANS, LA 70112

PIVOTAL ENGINEERING
CIVIL, ELECTRICAL, ENVIRONMENTAL
& MECHANICAL ENGINEERING
1515 POYDRAS STREET, STE. 1150
NEW ORLEANS, LA. 70112
504.799.3653 504.799.3654 FAX

THESE DRAWINGS HAVE BEEN PREPARED BY ME OR UNDER MY CLOSE PERSONAL SUPERVISION AND TO THE BEST OF MY KNOWLEDGE AND BELIEF THEY COMPLY WITH ALL LOCAL AND STATE REQUIREMENTS AND ALL APPLICABLE FEDERAL REQUIREMENTS. I AM A LICENSED PROFESSIONAL ENGINEER IN THE STATE OF LOUISIANA. MY LICENSE NO. IS 36533. I AM NOT PROVIDING CONTRACT ADMINISTRATION SERVICES FOR THIS PROJECT.
DATE: 07-12-2024
PROFESSIONAL OF RECORD: [Signature]

2739 EARHART BLVD, NEW ORLEANS, LA 70113
EARHART BLVD. FOOD TRUCK PLAZA

revisions	
no.	date & description
1	
2	
3	
4	

job number Task 30
drawn by E.G. P.S., T.G.
checked by Y.S.
date 07-12-2024
phase 60% FIANL PLAN

LANDSCAPE DETAILS

drawing number
L-2

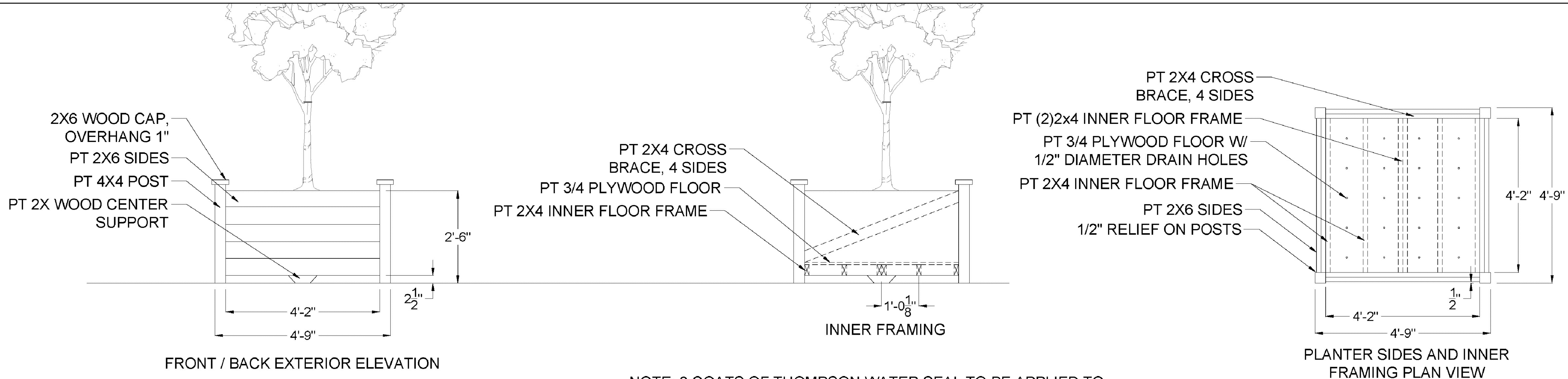
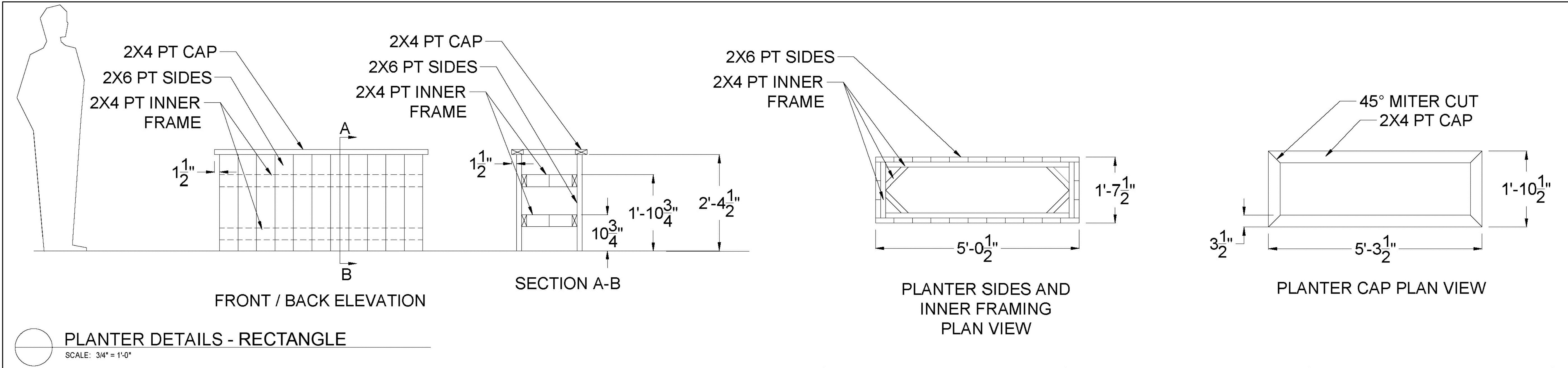

NOTE: 3 COATS OF THOMPSON WATER SEAL TO BE APPLIED TO INTERIOR OF PLANTER BOX. LINE BOTTOM WITH 1/4" X 1/4" GALVANIZED HARDWARE CLOTH ON BOTTOM OF PLANTER. PLACE 2" OF WASHED PEA GRAVEL ON TOP OF HARDWARE CLOTH. PLACE 2" OF MASON SAND ON TOP OF PEA GRAVEL. BACKFILL PLANTER BOX WITH ORGANIC SOIL MIX FOR PLANTINGS.

60% FINAL PLANS
NOT TO BE USED FOR BIDDING, CONSTRUCTION, RECONSTRUCTION, CONVEYANCE, SALES OR AS THE BASIS FOR THE ISSUANCE OF A PERMIT
PREPARED UNDER THE SUPERVISION OF
DAVID ABADIE, ASLA
LOUISIANA REG NO. 0728
PIVOTAL ENGINEERING, LLC

SUPER BOWL PROJECT - EARHART FOOD TRUCK PLAZA

PRELIMINARY RENDERING



VIEW -1



VIEW -2

SUPER BOWL PROJECT - EARHART FOOD TRUCK PLAZA

60% FINAL RENDERING



VIEW -3



VIEW -1



VIEW -2



Building/Construction Related Permit



Date _____	Received by _____
Tracking Number _____	

DEVELOPMENT PLAN AND DESIGN REVIEW APPLICATION

Covid-19 Submittal Protocol: Please submit complete applications via email to CPCinfo@nola.gov. Applicants without the ability to submit via email should contact (504) 658-7100 to make alternative arrangements. Incomplete applications will not be accepted and will be returned to the applicant. Review time depends on the complexity of the project and can take up to 90 days.

Type of application: Design Review Interim Zoning Districts Appeal Moratorium Appeal

Property Location _____

APPLICANT INFORMATION

Applicant Identity: Property Owner Agent

Applicant Name _____

Applicant Address _____

City _____ State _____ Zip _____

Applicant Contact Number _____ Email _____

PROPERTY OWNER INFORMATION SAME AS ABOVE

Property Owner Name _____

Property Owner Address _____

City _____ State _____ Zip _____

Property Owner Contact Number _____ Email _____

PROJECT DESCRIPTION

REASON FOR REVIEW (REQUIRED FOR DESIGN REVIEW)

Design Overlay District Review

- Character Preservation Corridor
- Riverfront Design Overlay
- Enhancement Corridor
- Corridor Transformation
- Greenway Corridor
- Others as required

Non-Design Overlay District Review

- Development over 40,000 sf
- Public Market
- CBD FAR Bonus
- Wireless Antenna/Tower
- Educational Facility

- Changes to Approved Plans
- DAC Review of Public Projects
- Others as Required

ADDITIONAL INFORMATION

Current Use _____ Proposed Use _____

Square Number _____ Lot Number _____ Permeable Open Space (sf) _____

New Development? Yes No Addition? Yes No Tenant Width _____

Existing Structure(s)? Yes No Renovations? Yes No Building Width _____

Change in Use? Yes No Existing Signs? Yes No Lot Width (sf) _____

New Sign(s)? Yes No Lot Area (sf) _____ Building Area (sf) _____



Date _____	Received by _____
Tracking Number _____	

DEVELOPMENT PLAN AND DESIGN REVIEW APPLICATION

REQUIRED ATTACHMENTS (One digital copy)

1. SITE PLAN

- North arrow, scale, and date of plan
- Location, dimensions, and area of permeable open space
- Name, address of the professional who prepared the plan
- Legend of symbols, patterns, and abbreviations used
- The entire lot(s), including area and property lines dimensioned (including gross area of the site)
- Curb cuts, interior streets, driveways, and parking and loading areas with dimensions and total area (sf)
- Location and dimensions of buildings and structures, including total floor area and distance from property lines
- Location of refuse storage locations
- Proposed right-of-way improvements including sidewalks and plantings, and pedestrian walkways
- Fence location, height, and materials

2. FLOOR PLAN

- Indicating the dimensions and square footage of proposed development
- Room use
- Location of all walls, doors, and windows
- Location of all plumbing fixtures
- Location of major appliances/mechanical equipment
- Stairway location
- Firewall location (if applicable)

3. ARCHITECTURAL ELEVATIONS

- Architectural elevations of each side of the proposed structure drawn to scale indicating height, architectural elements, materials, colors, and textures proposed for any structures.

4. LIGHTING PLAN

- Location of all exterior lighting, including those mounted on poles and walls
- Types, style, height, and the number of fixtures
- Manufacturer's illustrations and specifications of fixtures

5. SIGNAGE PLAN

- Proposed Signage with overall height, width, and materials
- Building Elevation (including building width and height)
- Site plan showing the location of all proposed detached sign(s) along with setback dimensions.

6. LANDSCAPE PLAN

- Name and address of professional who prepared the plan.
- Landscape plans shall be prepared by a registered landscape architect licensed by the Louisiana Horticulture Commission
- All landscape plans shall meet the minimum requirements of site plans
- Legend defining all symbols, patterns, and abbreviations used
- Location, quantity, size, name, and condition (both botanical and common) of all existing and proposed plant materials and trees.
- Description of all tree preservation measures on-site and in the public right-of-way
- Width, depth, and area of landscaped area(s)
- Proposed right-of-way improvements and pedestrian walkways

Planting proposed in the right-of-way must have Parks and Parkways approval

7. PHOTOS

- Photographs of the subject site and/or building

8. NARRATIVE

- Narrative addressing compliance with applicable Comprehensive Zoning Ordinance requirements and design goals

9. COLOR ELEVATIONS/RENDERING (DAC ONLY)

- Color elevations and/or renderings are required for projects that trigger review by the Design Advisory Committee

FEES

Compliant Plan	\$225
CBD Demolitions	\$500
Moratorium Appeals	\$1,000