



City of New Orleans Healthy Homes Program

Information on the Healthy Homes Program can be found online at <https://nola.gov/next/healthy-homes>
Scan QR code here to view.



Site Plan Requirements

All rental properties registered with the City of New Orleans Healthy Homes program are required to include a site plan.

There are many acceptable forms of a site plan. Site plans are a picture of the property itself showing **the general footprint of the building(s), where each residence is located within the property, the entry for each unit, and the street on which the building is sited.**

Applicants can submit site plans that are hand-drawn or computer-generated. Some larger properties with multiple buildings are likely to have existing site plans drawn by architects. However, please note: **Healthy Home applications do not require professionally drawn site plans. Hand sketches are acceptable.**

Useful Tips:

- Drawings should be simple and straightforward. Images and text are to be clear and legible.
- **Be sure to label the units** within the building, **show the entry point** of each unit, **label each building** (if your rental property has multiple structures), and **provide the street name.**
- For properties with multiple floors, provide a site plan for each floor. For properties with repeating floors, a ground floor plan and “typical” floor plans are sufficient.
- **Screenshots are acceptable if they are labeled legibly.** Drawings printed from the assessor’s page alone are not sufficient — if they are submitted, they must be labeled.

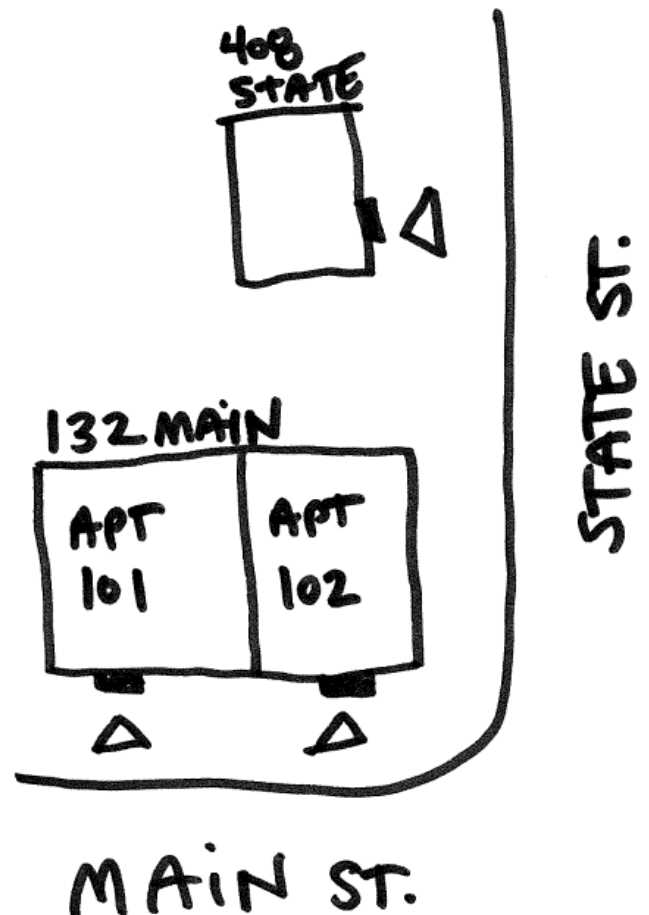

Sample Site Plan